

# Final Program

## SOCCA 2018 Annual Meeting and Critical Care Update

Friday, April 27, 2018

Hyatt Regency Chicago • Chicago, Illinois

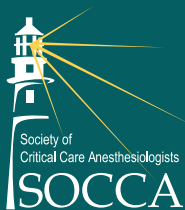

For more information,  
visit [www.socca.org](http://www.socca.org)



# Table of Contents

Welcome from the SOCCA President. . . . .	3
Welcome from the Mayor of Chicago. . . . .	4
How to Use the Program . . . . .	5
General Information . . . . .	6
Headquarters Hotel – Hyatt Regency Chicago. . . . .	8
Room Locator . . . . .	11
Discover Chicago . . . . .	13
Restaurants Guide . . . . .	15
Special Events. . . . .	17
CME Information . . . . .	18
SOCCA Committee on Education and Board of Directors. . . . .	19
Program Faculty . . . . .	20
Program Schedule . . . . .	21
Aligned Meeting and Focus on Critical Care Day. . . . .	23
Scholars’ Program. . . . .	25
Clinical Research Consortium . . . . .	26
Poster General Information . . . . .	27
Poster Room Diagram. . . . .	28
Poster Board Category Key . . . . .	29
Abstract Award Winners . . . . .	30
Moderated Poster Discussion Session . . . . .	31
Abstract Presenter Index . . . . .	51
Abstract Category Index. . . . .	53
Abstract Reviewers . . . . .	59

# Welcome to the SOCCA 2018 Annual Meeting and Critical Care Update in Chicago, Illinois!



Welcome to the SOCCA 2018 Annual Meeting and Critical Care Update, a meeting I am confident you will find rewarding with many valuable takeaways and networking opportunities. The members of the SOCCA Committee on Education, Drs. Adam S. Evans, Sheila Pai Cole, and Peter Von Homeyer, have developed a cutting-edge education program, addressing the latest advances in critical care and investigating the most pressing issues in anesthesiology. Plus, stay through Saturday, April 28, for the Aligned Meeting and SOCCA Focus on Critical Care Day education sessions at the IARS 2018 Annual Meeting and International Science Symposium, available complimentary to SOCCA registrants.

## Session Highlights:

### FRIDAY, APRIL 27

- **Sunrise Panel: *Emerging Practice Paradigms in Critical Care Practice*** – Review the various practice paradigms for delivering superior care for critical care patients.
- **Education Session I: *Metabolic Support for the Postoperative Patient in the ICU*** – Learn to formulate a protocol for intensive metabolic support for patients that are postoperative in the ICU.
- **Education Session II: *Enhancing Recovery from Critical Illness and Life Thereafter*** – Examine how to best prepare patients with critical illness and their families for the road to recovery.
- **Education Session III: *Wellness for the Anesthesiologist-Intensivist*** – Explore wellness initiatives to help with preventing burnout, improving resilience and dealing with grief.
- **SOCCA Lifetime Achievement Award Presentation: *Leadership for Today, Change for Tomorrow*** – Uncover insights for leadership and the future of critical care medicine during Award Winner Dr. Jeffery S. Vender's presentation.
- **SOCCA Young Investigator Award Presentation** – Examine the groundbreaking research from the Young Investigator Award Winner and first and second runners-up.
- **Moderated Poster Discussion Session** – Learn about cutting-edge advancements in research and education from abstract presenters.
- **Education Session IV: *Innovative Uses of Ultrasound in ICU*** – Discuss the new and exciting uses for ultrasound including the treatment of respiratory failure, optic US for ICP monitoring, nutrition and RV strain.

### SATURDAY, APRIL 28

#### Aligned Meeting Day Sessions:

- **Opening General Session and T.H. Seldon Memorial Lecture: *Personalizing Health in the Era of Big Data***  
with Dr. Jeffrey R. Balse
- **Alignment Symposium: *AUA: Mitochondria and Bioenergetics in Health and Disease: It's Not Just a Power Failure!***
- **IARS Scholars' Program** – Education Sessions, Breakfast and Lunch Sessions, and Mentoring and Networking Reception
- **IARS, AUA and SOCCA Alignment Reception**

#### Focus on Critical Care Sessions:

##### Review Course Lectures:

- **SOCCA: *The Tele-Vision: Taking Care to the Patient and Expanding the Scope of the Intensivist***
- **SOCCA: *Heart Failure with Preserved Ejection Fraction (HFpEF) as a Perioperative Risk***

##### Problem-Based Learning Discussions:

- **SOCCA: *To Intubate or Not: Management of Post-Operative Acute Respiratory Failure***
- **SOCCA: *The Sweet Escape: A Complicated Case of DKA***
- **SOCCA: *Perioperative Renal Replacement Therapy for the Anesthesiologist: Does It Make a Difference?***

### SUNDAY, APRIL 29

Plus, a bonus Focus on Critical Care Session, complimentary for SOCCA attendees:

- **Panel: SOCCA: *50 Years of ARDS: An Update***

Visit the SOCCA Tabletop Exhibits for the latest innovations in technology, equipment, and medical publications.

I hope your time with the leaders in critical care anesthesiology and your colleagues will energize you and give you the tools and skills you need to advance your practice and research while enjoying all Chicago has to offer.

Sincerely,

Avery Tung, MD, FCCM, *President, Society of Critical Care Anesthesiologists*

# Welcome from the Mayor of Chicago



April 26, 2018

Dear Friends:

As Mayor, and on behalf of the City of Chicago, I am pleased and proud to welcome all of those gathered for the *International Anesthesia Research Society, Association of University Anesthesiologists, and the Society of Critical Care Anesthesiologists 2018 Annual Meetings*.

Since their formation – the oldest dating back nearly a century – the International Anesthesia Research Society (IARS), Association of University Anesthesiologists (AUA), and the Society of Critical Care Anesthesiologists (SOCCA) have been committed to creating dynamic spaces for the support and cultivation of anesthesiologists, scientists, physicians and other professionals dedicated to better understanding anesthesia practice and application. Home to thousands of members worldwide, IARS, AUA, and SOCCA's annual meetings unite leaders across disciplines dedicated to improving patient care through involved, innovative research. Every member stands committed to augmenting the role of anesthesia in medicine and interpreting methodology and outcomes in relation to our collective health. IARS, AUA, and SOCCA play an integral role in impacting education, informing policy, and enlightening the public.

This year's meeting presents a special opportunity to come together to discuss recent innovations in the field while also remaining focused on all the advancements left to uncover. The *2018 Meetings* aim to promote exposure to different techniques, tools, and social strategies that build upon new ways to approach studying and researching anesthesia. In addition, interactive sessions and thoughtful exhibits will allow attendees to explore growing trends of scientific research and medical practices to forge a place at the forefront of education and implementation. All of Chicagoland's residents benefit year-round from the important work that the groups' diverse membership do day in and day out. I commend all associated with IARS, AUA, and SOCCA for demonstrating excellence and dedication in your field, and for being an invaluable resource for the global science and medical communities.

After learning, exchanging ideas, and networking, it is my hope that those visiting our great city take time to experience some of the special places in Chicago. Our historic neighborhoods, iconic skyline, and incredible lakefront invite you to explore all Chicago has to offer. I hope you have a chance to sample our distinguished restaurants, tour our great universities, and visit our world-class museums during your stay.

Best wishes for an enjoyable and informative event, and much continued success.

A handwritten signature in black ink that reads "Rahm Emanuel".

RAHM EMANUEL, Mayor



## How to Use the Program

In this Program, you will find the information you need to make the most of your Annual Meeting experience. Included is a complete listing of Annual Meeting special events, a program schedule, information on Chicago and poster details. The education sessions and Moderated Poster Discussion Session are listed by day and time in the Program. Refer to pages 8-10 of this Program for a map of the Headquarters Hotel, Hyatt Regency Chicago, including meeting rooms and registration area.

### ANNUAL MEETING LOCATION

#### **SOCCA 2018 Annual Meeting and Critical Care Update Headquarters Hotel**

Hyatt Regency Chicago • 151 East Wacker Drive  
Chicago, Illinois 60601 • Tel: 312-565-1234

### REGISTRATION

#### **Onsite Registration Hours**

Thursday, April 26 . . . . . 6:00 am – 6:00 pm  
Friday, April 27 . . . . . 6:00 am – 6:00 pm  
Saturday, April 28 . . . . . 6:00 am – 6:00 pm

Your registration materials will be available for pick up at the Registration Desk in the Crystal Foyer, Lobby Level, West Tower.

#### **Name Badges**

Your registration materials include your name badge which you must wear at all times while attending events in the hotel. Only attendees with name badges will be admitted to meeting rooms. If you misplace your badge, please visit the Registration Desk for a replacement.

#### **Registration Fee**

The registration fee includes all education sessions, continental breakfast, the moderated poster discussion session, SOCCA Reception with Exhibitors, Aligned Meeting and Focus on Critical Care Day sessions, and the Alignment Reception. The Scholars' Program requires pre-registration and an additional non-refundable fee.

#### **Annual Meeting Registration Cancellation Policy**

The registration cancellation deadline is Thursday, April 12, 2018. Registrations canceled on or before Thursday, April 12, 2018, will be refunded, minus a \$50 processing charge.

### POSTER ROOM

The poster room, poster check-in desk, and the poster pickup booth are located in Riverside West, Exhibit Level, East Tower.

#### **Poster Room Hours**

Thursday, April 26 . . . . . 6:00 am – 5:00 pm  
Friday, April 27 . . . . . 6:00 am – 5:00 pm

#### **Poster Check-in and Information Desk Hours**

Thursday, April 26 . . . . . 6:00 am – 6:00 pm  
Friday, April 27 . . . . . 6:00 am – 6:00 pm

#### **Poster Pickup Booth Hours**

Thursday, April 26 . . . . . 6:00 am – 2:00 pm  
Friday, April 27 . . . . . 6:00 am – 2:00 pm

### TABLETOP EXHIBITS

The Tabletop Exhibits are located in Regency D, Ballroom Level, West Tower of the hotel. Please join us in the Exhibit Hall for the SOCCA Reception with Exhibitors on Thursday, April 26 and the IARS, AUA and SOCCA Alignment Reception on Saturday, April 28.

#### **Tabletop Exhibit Hours**

##### **Thursday, April 26**

SOCCA Reception with Exhibitors . . . . . 7:00 pm – 8:00 pm

##### **Friday, April 27**

Exhibit Hours . . . . . 7:00 am – 3:00 pm

##### **Saturday, April 28**

Exhibit Hours . . . . . 6:30 am – 4:00 pm

IARS, AUA and SOCCA

Alignment Reception . . . . . 6:00 pm – 7:30 pm

For complete information on the Tabletop Exhibits, please refer to the Exhibits Guide, provided with your printed materials at registration.





# General Information

## SERVICES

### Abstracts List and Event Search

Search all sessions, abstracts and speakers for the IARS, AUA and SOCCA 2018 Annual Meetings on the event site at [ww3.aievolution.com/ars1801](http://ww3.aievolution.com/ars1801).

### Internet Availability

Complimentary wireless internet is available in the conference area, exhibit area and all SOCCA-scheduled meeting rooms. Open your wifi settings and choose the network labeled, "Hyatt Conference." When prompted for an access code, enter "AM2018." Please no streaming or video downloads.

### OpenAnesthesia SelfStudyPlus Information Booth

The first adaptive learning app for anesthesiologists and residents, OpenAnesthesia SelfStudyPLUS personalizes learning using novel and patented algorithms that assess and adapt to individual needs. This easy to use app provides access to over 1700 questions curated by teaching physicians at top hospitals, while fitting into the most demanding schedules. Physicians can use SelfStudyPLUS to conveniently earn CME. OpenAnesthesia is proudly sponsored by IARS. Visit the booth in the Regency Foyer A, Ballroom Level, in the West Tower.

### SmartTots Information Booth

Stop by the SmartTots booth! You'll find a plethora of pediatric anesthesia research resources. Grab the latest info, make a donation, win a bottle of SmartTots wine, enjoy some delicious San Francisco chocolate and more! The SmartTots booth is located in the Regency Foyer A, Ballroom Level, in the West Tower.

### Official App of the IARS, AUA and SOCCA 2018 Annual Meetings



The IARS, AUA and SOCCA Annual Meetings will feature an interactive app, **IARS Mtgs**, allowing you to view the complete event schedule, explore all sessions, and get detailed presenter information. Participate in the interactive games on the app and connect with your peers and colleagues. Download **IARS Mtgs**, available for iPhone, iPad and Android in the Google Play and Apple Stores.

### Social Media

We want to see what you're getting out of the meeting, whether it's meeting another doctor for the first time, the food at our special events, or an interesting idea you heard at a session. Share your thoughts on social media using the hashtag **#SOCCA2018**.

### Speaker Ready Room

The speaker ready room is located in the Field Room, Third Floor, West Tower for all SOCCA speakers to utilize.

Thursday, April 26. . . . . 6:00 am – 6:00 pm

Friday, April 27 . . . . . 6:00 am – 6:00 pm

### Treasure Hunt

Participate in our IARS, AUA and SOCCA 2018 Annual Meetings Treasure Hunt for a chance to win gift cards! Download the IARS Mtgs app from the app store to play. Complete all the IARS AUA SOCCA Treasure Hunt challenges and you'll be entered to win one of three gift cards. The deadline to complete the Treasure Hunt is Tuesday, April 1 at 12:00 pm. The Treasure Hunt winners will be notified via email following the meeting.

### Trivia Game

Play the IARS, AUA and SOCCA 2018 Annual Meeting Trivia Game each day for a chance to win prizes. Each game consists of 12 multiple-choice trivia questions, each with three options. Questions get harder as the game progresses and you only have 10 seconds to select your answer. Participants who get the most correct answers in a game will be entered in a raffle for a chance to win prizes and bragging rights. Check the leaderboard in Crystal Foyer to compare your progress against other attendees. Trivia Game winners will be notified via email after the meeting.

## INFORMATION

### Dress Code

The dress code for the SOCCA 2018 Annual Meeting is business/business casual.

### Electronic Devices

Please silence all electronic devices during education sessions. Videotaping and recording of sessions is not allowed without the written permission from the presenter(s).

### Media Release Policy

By attending the SOCCA 2018 Annual Meeting or entering in the facility in which the SOCCA 2018 Annual Meeting takes place, you agree that SOCCA and/or third parties authorized by SOCCA may photograph or record your likeness, image, name, voice, and/or words, and may publish, display, reproduce, copy, and distribute your likeness, image, name, voice, and/or words for promotional, educational, or membership activities worldwide in all forms of media now known or later developed, including but not limited to advertising, training, websites, presentations, and marketing materials. You further acknowledge that SOCCA and/or third parties authorized by SOCCA shall have the right, but not the obligation, to identify you in connection with such media by name and/or affiliation.



## Recording (Audio, Video, and Still Photography)

Copyright of the SOCCA 2018 Annual Meeting program is owned by SOCCA. SOCCA reserves the rights to all recordings or reproductions of presentations at this meeting and all SOCCA meetings and symposia. Any photography, filming, taping, recording, or reproduction in any medium of any of the programs presented at the SOCCA 2018 Annual Meeting without the express written consent of SOCCA is strictly forbidden. Exception: Non-flash photography and audio or video recording using hand-held equipment, for strictly personal, social, or noncommercial use, are permitted if not disruptive, as determined by SOCCA.

## No Smoking Policy

Smoking is not permitted at SOCCA events. We respectfully request that you abide by our smoke-free policy.

## Special Services

If you are in need of any special services, please contact SOCCA at [soccametings@iars.org](mailto:soccametings@iars.org) or visit the Registration Desk during the Annual Meeting.

## SPECIAL EVENTS

### SOCCA Reception with Exhibitors

Thursday, April 26, 7:00 pm – 8:00 pm  
Regency D, Ballroom Level, West Tower

Catch up with your colleague and peers and get amped up for the meeting to come! Plus, visit the SOCCA Tabletop Exhibits!

### Scholars' Program Mentoring and Networking Reception\*

Friday, April 27, 6:00 pm – 7:00 pm  
The Living Room & Bar, Skyway Level, West Tower

Mentors and trainees will have the opportunity to network and develop connections that will prove valuable.

*\*The Scholars' Program requires an additional \$50 fee to attend.*

### IARS, AUA and SOCCA Alignment Reception

Saturday, April 28, 6:00 pm – 7:30 pm  
Regency D & Foyer, Ballroom Level, West Tower

Attend a special reception and connect with the leaders in all subspecialties of anesthesia while enjoying some of the delicious cuisine Chicago has to offer. Be sure to visit the Tabletop Exhibits!

## TRAVEL TIPS FOR CHICAGO

### Chicago Airports

O'Hare International Airport, located 17 miles from downtown, is one of the largest airports in the world. It is North America's major international gateway airport, servicing over 67 million passengers to and from over 200 destinations around the globe.

Midway International Airport is located 10 miles from downtown Chicago and offers another convenient travel option for visitors. It is the nation's premier point-to-point airport, offering value-oriented leisure and business travel to over 60 destinations.

### Time Zone

Chicago follows the Central Time Zone (CST).

### Transportation

O'Hare and Midway airports offer taxi service to downtown and the suburbs. Rates range from \$40-50 from O'Hare, and \$30-40 from Midway. Rates vary based on travel time and are subject to change.

The Chicago Transit Authority serves both airports for easy and economical travel between downtown and Chicago neighborhoods using the 'L' train. The 24-hour CTA Blue Line connects directly to O'Hare and the CTA Orange Line connects directly to Midway. Read more at [bit.ly/CHLtransit](http://bit.ly/CHLtransit) for full fare information and maps.

GO Airport Express provides shared ride services to all downtown/suburban hotels and many businesses.

### Weather

Springtime in Chicago means blooming flowers and a lively lakefront. Temperatures start to warm up with April and May are typically between 50°F (10-15°C) and 70°F (21°C).

# General Information

## Headquarters Hotel: Hyatt Regency Chicago



The Hyatt Regency Chicago offers a chic, downtown retreat, located steps from the Magnificent Mile and iconic Chicago destinations. Slip away for an afternoon at The Art Institute of Chicago, ride on the Chicago Architectural Foundation's boat tour, or snap a photo in front of Cloud Gate, locally known as the Bean. Plus, savor the unparalleled views of downtown and Navy Pier from the Hyatt Regency Chicago.

### Riverside West (Exhibit Level, East Tower)

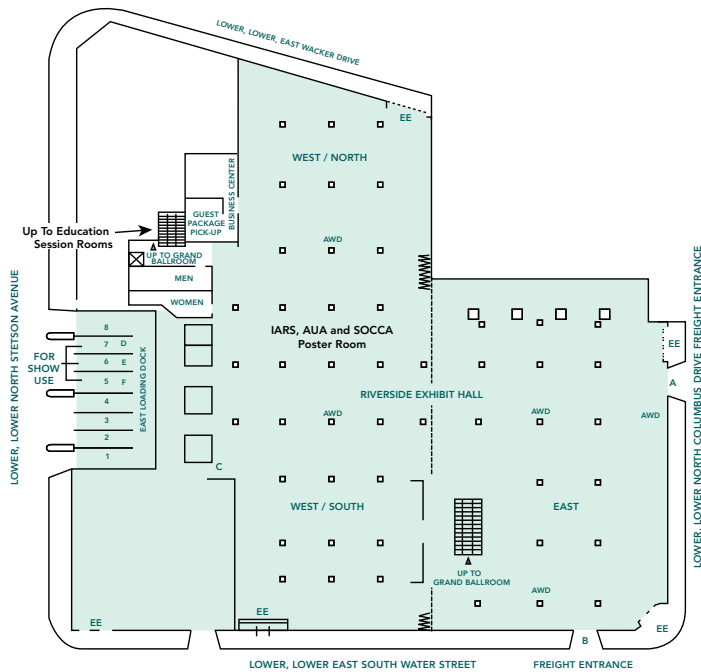

### Lobby (East Tower)

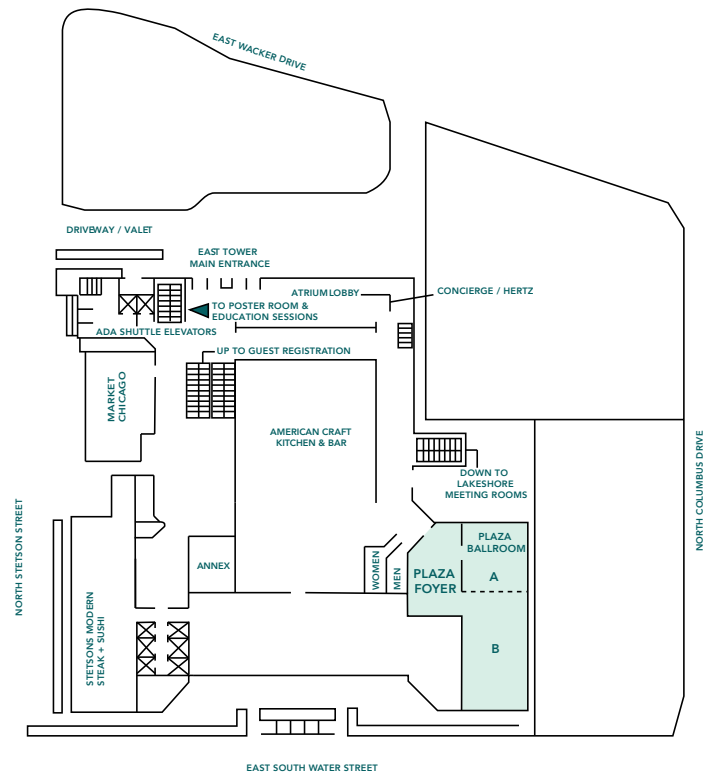

# General Information



## Skyway Level (East Tower)

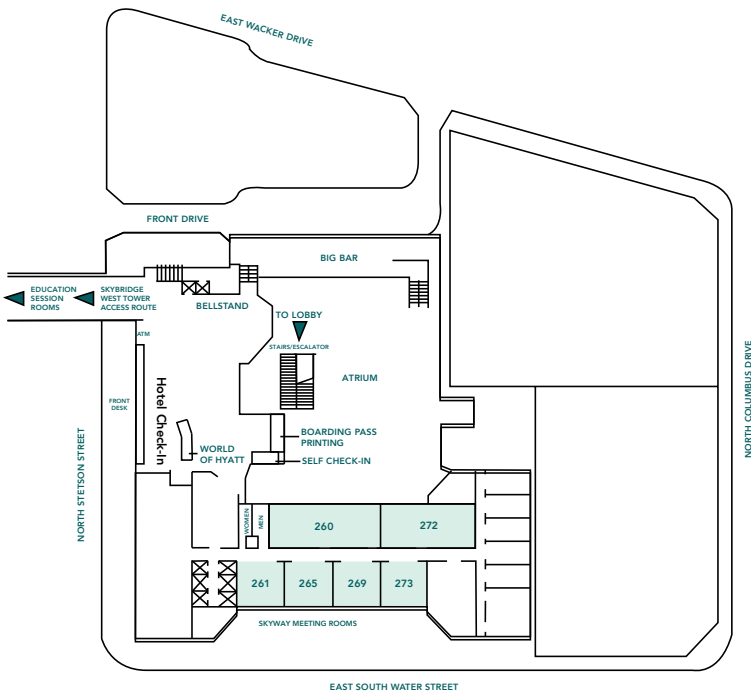

## Skyway Level (West Tower)

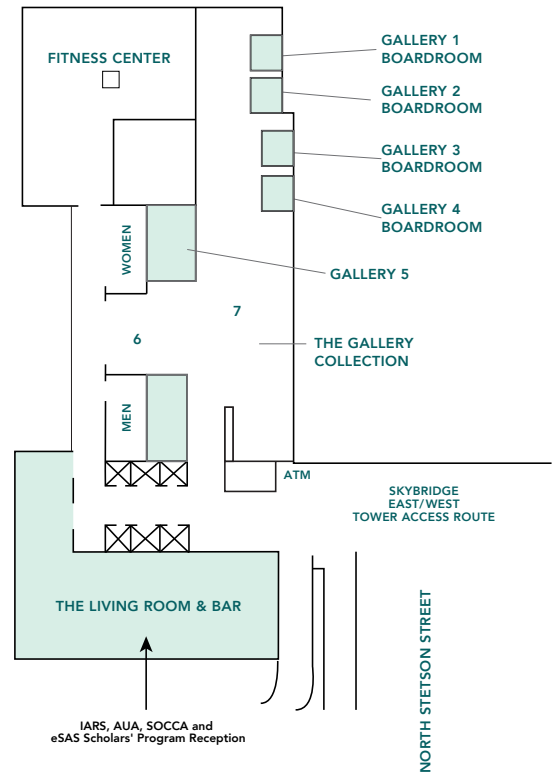

## Third Floor (West Tower)

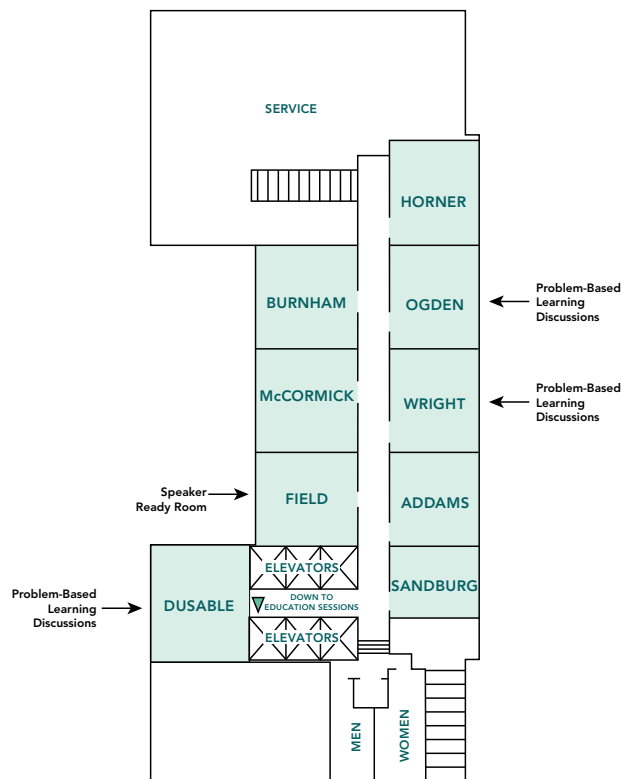



# General Information

## Lobby (West Tower)

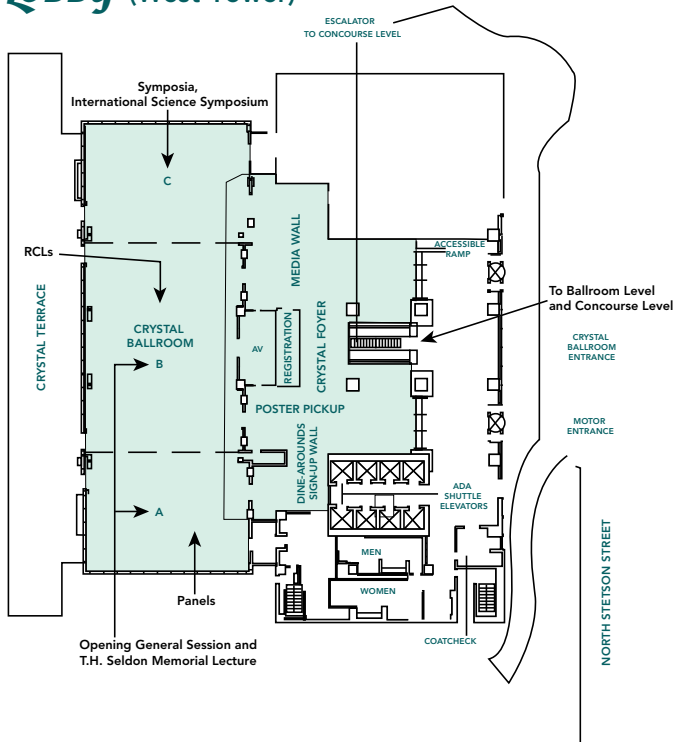

## Concourse (West Tower)

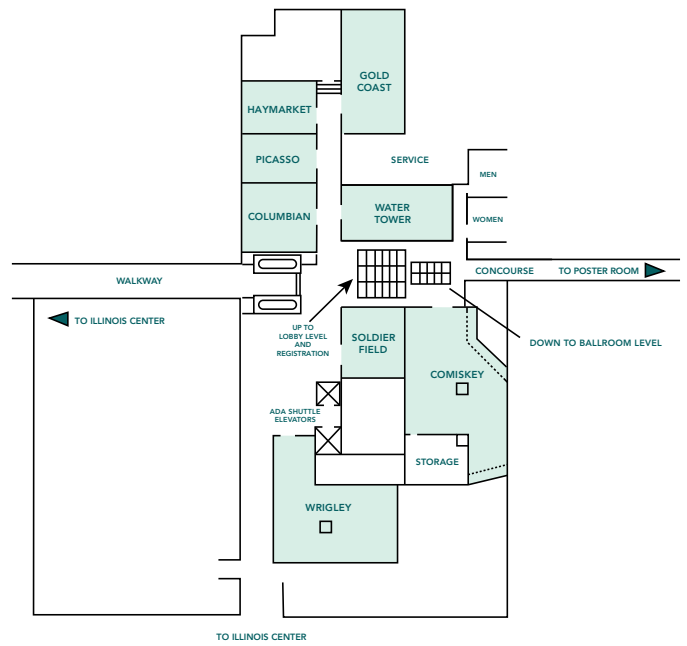

## Ballroom Level (West Tower)

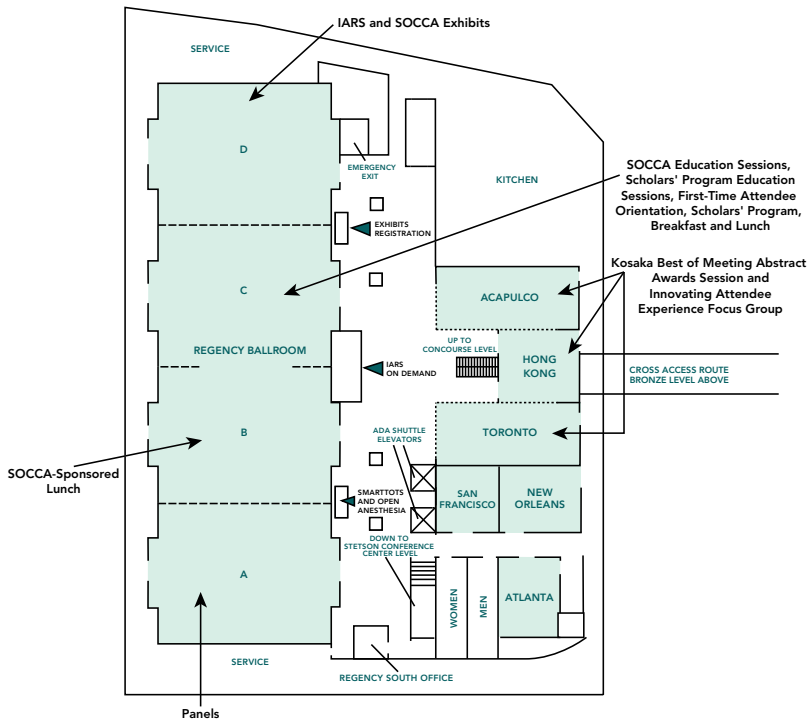

# Room Locator



## Thursday, April 26

TIME	EVENT	ROOM
6:00 am – 6:00 pm	Registration	Crystal Foyer, Lobby Level, West Tower
7:00 pm – 8:00 pm	SOCCA Reception with Exhibitors	Regency D, Ballroom Level, West Tower
7:00 pm – 8:00 pm	Exhibits	Regency D, Ballroom Level, West Tower

## Friday, April 27

6:00 am – 6:00 pm	Registration	Crystal Foyer, Lobby Level, West Tower
7:00 am – 8:00 am	Breakfast with Exhibitors	Regency D, Ballroom Level, West Tower
7:00 am – 8:00 am	Sunrise Panel: Emerging Practice Paradigms in Critical Care Practice	Regency C, Ballroom Level, West Tower
7:00 am – 3:00 pm	Exhibits	Regency D, Ballroom Level, West Tower
8:00 am – 8:15 am	Welcome Address and Introduction – Non-CME	Regency C, Ballroom Level, West Tower
8:15 am – 9:45 am	Education Session I: Metabolic Support for the Postoperative Patient in the ICU	Regency C, Ballroom Level, West Tower
9:45 am – 10:15 am	Break with Exhibitors	Regency D, Ballroom Level, West Tower
10:15 am – 11:15 am	Education Session II: Enhancing Recovery from Critical Illness and Life Thereafter	Regency C, Ballroom Level, West Tower
11:15 am – 11:30 am	Break with Exhibitors	Regency D, Ballroom Level, West Tower
11:30 am – 12:30 pm	Education Session III: Wellness for the Anesthesiologist-Intensivist	Regency C, Ballroom Level, West Tower
12:30 pm – 1:30 pm	SOCCA Lunch Satellite Symposium – Non-CME**	Regency B, Ballroom Level, West Tower
1:30 pm – 2:00 pm	Lifetime Achievement Award Presentation: Leadership for Today, Change for Tomorrow	Regency C, Ballroom Level, West Tower
2:00 pm – 2:45 pm	Young Investigator Awards Presentation	Regency C, Ballroom Level, West Tower
2:45 pm – 3:00 pm	Break with Exhibitors	Regency D, Ballroom Level, West Tower
3:00 pm – 3:45 pm	Moderated Poster Discussion Session	Riverside West, Exhibit Floor, East Tower
3:45 pm – 4:00 pm	Break with Exhibitors	Regency D, Ballroom Level, West Tower
4:00 pm – 5:00 pm	Education Session IV: Innovative Uses of Ultrasound in the ICU	Regency C, Ballroom Level, West Tower
5:00 pm – 5:15 pm	Closing Remarks – Non-CME	Regency C, Ballroom Level, West Tower
5:15 pm – 6:00 pm	SOCCA Annual Business Meeting – Non-CME	Regency C, Ballroom Level, West Tower
6:00 pm – 7:00 pm	IARS, AUA, SOCCA and eSAS Scholars' Program Mentoring and Networking Reception*	The Living Room & Bar, Skyway Level, West Tower

\*Ticketed Session. Visit the registration desk to check availability.

\*\*Pre-registration required. Visit Exhibits Check-in Desk to check availability.

(continued)



## Room Locator, continued

### Saturday, April 28

TIME	EVENT	ROOM*
6:00 am – 6:00 pm	Registration	Crystal Foyer, Lobby Level, West Tower
6:15 am – 7:15 am	Scholars' Program Breakfast with IARS, AUA and SOCCA Leadership and Mentors*	Regency C, Ballroom Level, West Tower
6:30 am – 4:00 pm	Exhibits	Regency D & Foyer, Ballroom Level, West Tower
7:30 am – 9:00 am	Opening General Session and T.H. Seldon Memorial Lecture: Personalizing Healthcare in the Era of Big Data	Crystal AB, Lobby Level, West Tower
9:00 am – 9:30 am	Break with Exhibitors	Regency D, Ballroom Level, West Tower
9:30 am – 9:40 am	Scholar-01: Introduction to Scholars' Program and eSAS*	Regency C, Ballroom Level, West Tower
9:30 am – 10:30 am	PBLD-02: SOCCA: To Intubate or Not: Management of Postoperative Acute Respiratory Failure*	Wright, Third Floor, West Tower
9:30 am – 12:00 pm	Symposium-01: AUA: Mitochondria and Bioenergetics in Health and Disease It's Not Just A Power Failure!	Crystal C, Lobby Level, West Tower
9:40 am – 10:30 am	Scholar-02: Moving from Insight to Research Program and What This is All About*	Regency C, Ballroom Level, West Tower
10:45 am – 12:15 pm	Scholar-03: Shine Like A Rockstar: Different Paths to Success*	Regency C, Ballroom Level, West Tower
11:15 am – 12:00 pm	RCL-01: SOCCA: The Tele-Vision: Taking Care to the Patient and Expanding the Scope of the Intensivist	Crystal B, Lobby Level, West Tower
12:00 pm – 1:00 pm	PBLD-05: AUA: Why Study Time Doesn't Always Lead to Learning: How Do We Help the Struggling Trainee? Offered Twice!*	Dusable, Third Floor, West Tower
12:30 pm – 2:00 pm	Scholar-04: Lunch Session: Resilience Personified: Transitioning from Trainee to Junior Faculty and Beyond*	Regency C, Ballroom Level, West Tower
1:00 pm – 2:00 pm	Lunch on Your Own	Offsite
2:00 pm – 3:00 pm	PBLD-07: SOCCA: The Sweet Escape: A Complicated Case of DKA*	Dusable, Third Floor, West Tower
2:15 pm – 3:45 pm	Scholar-05: Moving Fluidly Across the Translational Spectrum: Current Opioid Crisis*	Regency C, Ballroom Level, West Tower
2:30 pm – 3:30 pm	PBLD-09: AUA: Why Study Time Doesn't Always Lead to Learning: How Do We Help the Struggling Trainee? Offered Twice!*	Ogden, Third Floor, West Tower
4:00 pm – 5:00 pm	PBLD-10: AUA: Getting to the Heart of the Matter: Perioperative Focused Cardiac and Pulmonary Ultrasound, and the Hemodynamically Unstable Patient*	Dusable, Third Floor, West Tower
4:00 pm – 5:00 pm	PBLD-11: SOCCA: Perioperative Renal Replacement Therapy for the Anesthesiologist: Does It Make A Difference?*	Wright, Third Floor, West Tower
4:00 pm – 5:00 pm	Scholar-06: Priorities for Developing Researchers: Perspectives from the NIH and IARS*	Regency C, Ballroom Level, West Tower
5:00 pm – 5:45 pm	RCL-06: SOCCA: Heart Failure with Preserved Ejection Fraction (HFpEF) as a Perioperative Risk Factor	Crystal B, Lobby Level, West Tower
5:10 pm – 6:10 pm	Scholar-07: From the Editor's Desk: A No-Nonsense Guide to Successful Publication*	Regency C, Ballroom Level, West Tower
6:00 pm – 7:30 pm	IARS, AUA and SOCCA Alignment Reception	Regency D & Foyer, Ballroom Level, West Tower

### Sunday, April 29

6:00 am – 6:00 pm	Registration	Crystal Foyer, Lobby Level, West Tower
4:00 pm – 5:30 pm	Panel-21: SOCCA: 50 Years of ARDS: An Update*	Regency B, Ballroom Level, West Tower

\*Ticketed Session. Visit the registration desk to check availability.

# Welcome to the SOCCA 2018 Annual Meeting and Critical Care Update in Chicago!



## Collaborate and Network with Leaders in Critical Care Anesthesia

Join your colleagues for a stimulating program at the SOCCA 2018 Annual Meeting and Critical Care Update, on Friday, April 27, at the Hyatt Regency Chicago in Chicago, and explore current practices and review cutting-edge topics in research and education with thought leaders in critical care anesthesia. While in Chicago, stay an extra day and take advantage of the IARS Aligned Meeting and SOCCA Focus on Critical Care Day sessions on Saturday, April 28, available complimentary to all SOCCA registrants. This year, you also have access to a bonus Focus on Critical Care session on Sunday, April 29. Don't miss these valuable learning opportunities!

## Discover Chicago

Chicago is more than just a big city. Besides its striking downtown, which includes some of the most beautiful buildings in the world, Chicago has a distinctive shoreline, hundreds of vibrant parks and 77 unique neighborhoods. In Chicago, you will find incredible shopping on the Magnificent Mile, a Michelin-rated dining scene and exciting nightlife, just a short walk from the SOCCA Headquarters Hotel. The city also offers more than 60 museums, five regional Tony Award-winning theaters and, no matter the season, a sports team to cheer on. Chicago's neighborhoods represent more than 100 countries and it's through this diversity and profound city culture that the city has developed the country's best restaurants, theaters and museums. Enjoy your visit to Chicago!

## Chicago by the Numbers

**237** square miles of land located at the southwestern tip of Lake Michigan

As the third-most populous city in the U.S., Chicago has an estimated **2.7** million residents

**77** community areas containing more than **100** neighborhoods

Home of the iconic deep-dish pizza, Chicago serves as a gourmet dining epicenter and hosts over **5,195** restaurants

More than **250** theaters, **225** music venues and **200** dance companies

**56** museums including the Museum of Science+Industry and the Art Institute of Chicago

Over **700** works of public art exhibited in **150** municipal facilities around the city including Cloud Gate (the Bean) and Cows on Parade

More than **125** art galleries and **20** neighborhood art centers

**26** miles of lakefront with an **18.5**-mile lakefront path

**8,100** acres of green space with **580** parks and **26** beaches

**5** city-wide music festivals, nearly **50** neighborhood music festivals and **35** neighborhood food festivals

Over **30** downtown and neighborhood parades

Approximately **369** landmarks and 46 historic districts

Over **225** miles of bike lanes and more than **13,000** bike racks

Over **3,000** bikes and **300** stations through the Divvy bike sharing system

**28** CTA bus routes and **8** train routes serving **146** stations

**119** hotels with **39,000** hotel rooms in the Central Business District

**37** moveable bridges – Chicago has more than any city in the world. Most are the design-style called bascule, from the French word for teeter-totter.

## What to Do in Chicago

### Chicago Neighborhoods

The meeting takes place in downtown Chicago, among the tall buildings of the city skyline. The North Side neighborhoods are full of entertainment from baseball, sketch comedy, and live jazz. The neighborhoods to the south contains many of the city's cultural spots with public art pieces, galleries, museums, and performance venues. To the west is a large diversity of neighborhoods with many ethnic stores, restaurants, and specialty shops. Visit [www.choosechicago.com](http://www.choosechicago.com) for more details.

### Architecture

Chicago is the birthplace to the modern skyscraper. Since most buildings in the downtown area were destroyed during the Great Chicago Fire in 1871, the city rebuilt with new and original designs for its buildings. Here are just a few of the unique buildings nearby:

**Aqua**  
225 N Columbus Dr

**Marina City**  
300 N State St

**Tribune Tower**  
435 N Michigan Ave

**Willis Tower** (formally the Sears Tower)  
233 S Wacker Dr

### Museums

As a leader in the arts, Chicago is widely known for its state-of-the-art museums with over 30 museums to explore. Here are five museums you must visit while in Chicago:

#### Adler Planetarium

Travel through space and time to explore our universe with some of the top researchers in astronomy and astrophysics. Right next to the Planetarium is the Doane Observatory, open to the public to view the planets and stars of our galaxy.

#### Art Institute of Chicago

Art Institute of Chicago has a permanent collection of more than 300,000 artworks, from all over the world and ranging through many time periods.

#### Chicago History Museum

Documenting the history of Chicago, this museum contains items that highlight the people, culture, and events from the past 200 years.

#### Field Museum

The museum was originally founded to exhibit the biological and anthropological collection for the World's Columbian Exposition of 1893. It spans 350,000 square feet of permanent exhibitions to such as a royal Egyptian tomb or a Chinese rock garden.

#### Museum of Contemporary Art

The museum houses one of the largest collection of modern art in the nation and hosts major touring exhibits. It also presents works by local artists, showcasing the rising talent in the city.



Art Institute of Chicago



Adler Planetarium



## Restaurant Guide

### Restaurants at the Hyatt Regency Chicago

#### **American Craft Kitchen & Bar**

American (Traditional), \$\$

Hours: 6:00 am – 3:00 pm; 5:00 pm – 11:00 pm

#### **BIG Bar**

Lounges, American (New), \$\$

Hours: From 5:00 pm

#### **The Living Room**

Tapas/Small Plates, Cocktail Bars, \$\$

Hours: Tues-Sat, 5:00 pm – 11:00 pm

#### **Stetsons Modern Steak + Sushi**

Sushi Bars, Steakhouses, \$\$\$

Hours: Tues-Sat 5:00 pm – 10:00 pm

#### **Market Chicago**

Coffee & Tea \$\$

Hours: 24-hours a day

### Restaurants Near the Hyatt Regency Chicago

#### **Wildberry Pancakes and Café**

Breakfast & Brunch, American (New), \$\$

130 E Randolph St

312-938-9777

Distance from hotel: 5 min (0.2 mi.)

#### **Potbelly Sandwich Shop**

Sandwiches, Fast Food, Soup, \$

111 E Wacker Dr

312-861-0013

Distance from hotel: 3 min (0.2 mi.)

#### **The Purple Pig**

Tapas/Small Plates, Mediterranean, \$\$

500 N Michigan Ave

312-464-1744

Distance from hotel: 8 min (0.4 mi.)

#### **Lou Malnati's Pizzeria**

Pizza, \$\$

439 N Wells St

312-828-9800

Distance from hotel: 15 min (0.8 mi.)

#### **Giordano's**

Pizza, \$\$

130 E Randolph St

312-616-1200

Distance from hotel: 5 min (0.2 mi.)

#### **Magnolia Bakery**

Bakeries, Desserts, Cupcakes, \$\$

108 N State St

312-346-7777

Distance from hotel: 10 min (0.5 mi.)

#### **Catch 35**

Seafood, \$\$\$

35 W Wacker Dr

312-346-3500

Distance from hotel: 9 min (0.4 mi.)

#### **Barrio**

Mexican, Bars, American (New), \$\$\$

65 W Kinzie St

312-941-9900

Distance from hotel: 14 min (0.7 mi.)

#### **Prime & Provisions**

American (Traditional), Seafood, Steakhouses, \$\$\$\$

222 N La Salle St

312-726-7777

Distance from hotel: 12 min (0.6 mi.)

#### **Naf Naf Grill**

Middle Eastern, Falafel, Salad, \$

326 N Michigan Ave

312-263-0019

Distance from hotel: 5 min (0.2 mi.)

#### **MingHin Cuisine**

Dim Sum, Cantonese, Asian Fusion, \$\$

333 E Benton Pl Ste 300

312-228-1333

Distance from hotel: 5 min (0.2 mi.)

#### **Quartino Ristorante**

Italian, Wine Bars, \$\$

626 N State St

312-695-5000

Distance from hotel: 13 min (0.6 mi.)

#### **Nando's PERi-PERi**

Portuguese, South African,

Chicken Shop, \$\$

22 S Wabash Ave

312-589-7432

Distance from hotel: 10 min (0.5 mi.)

#### **Yolk – Streeterville**

Breakfast & Brunch, American (Traditional),

Comfort Food, \$\$

355 E Ohio St

312-822-9655

Distance from hotel: 9 min (0.4 mi.)



# General Information

## RESTAURANT GUIDE, *continued*

### **Brightwok Kitchen**

*Asian Fusion, Gluten-Free, Vegetarian, \$\$*  
21 E Adams St  
312-583-0729  
Distance from hotel: 13 min (0.6 mi.)

### **Cochon Volant Brasserie**

*French, Brasseries, \$\$*  
100 W Monroe St  
312-754-6560  
Distance from hotel: 14 min (0.7 mi.)

### **Coffee near the Hyatt Regency Chicago**

#### **Two Zero Three**

*Coffee & Tea, Wine Bars \$*  
203 North Wabash Ave  
312-940-4808  
Distance from hotel: 8 min (0.4 mi.)

#### **Caffe RoM**

*Coffee & Tea, Sandwiches, Gelato \$*  
180 N Stetson Ave  
312-948-888  
Distance from hotel: 3 min (0.1 mi.)

#### **Stan's Donuts & Coffee**

*Donuts, Coffee & Tea \$*  
181 N Michigan Ave  
312-729-5480  
Distance from hotel: 5 min (0.2 mi.)

#### **Intelligentsia Coffee**

*Coffee & Tea \$*  
53 E Randolph St  
312-920-9332  
Distance from hotel: 6 min (0.3 mi.)

### **Other Restaurants of Note**

#### **Dusek's Board & Beer**

*Bars, American (New), Breakfast & Brunch, \$\$*  
1227 W 18th St  
312-526-385  
Distance from hotel: (4.6 mi.)

#### **Pequod's Pizzeria**

*Pizza, \$\$*  
2207 N Clybourn Ave  
773-327-1512  
Distance from hotel: 25 min car ride (5.0 mi.)

#### **Roister**

*American (New) \$\$\$\$*  
951 W Fulton Market  
Distance from hotel: 12 min car ride (2.1 mi.)

#### **Gibsons Bar & Steakhouse**

*Steakhouses, Wine Bars, \$\$\$*  
1028 N Rush St  
312-266-8999  
Distance from hotel: 8 min car ride (1.5 mi.)



# Special Events



## THURSDAY, APRIL 26

### **SOCCA Reception with Exhibitors**

7:00 pm – 8:00 pm, Regency D, Ballroom Level, West Tower

Don't miss this lively reception to kickoff the SOCCA 2018 Annual Meeting and Critical Care Update. Connect with your colleagues and peers and gain the opportunity to interact with leaders in the field. Visit exhibitors and discover the latest innovations. Get energized for the education program and make new contacts with whom to share the meeting experience.

## FRIDAY, APRIL 27

### **IARS, AUA, SOCCA and eSAS Scholars' Program Mentoring and Networking Reception\***

6:00 pm – 7:00 pm, The Living Room & Bar, Skyway Level, West Tower

Be sure to attend the Scholars' Program Reception and participate in a special mentor-trainee session. Network and socialize with fellow scholars, plus participate in mentoring opportunities.

## SATURDAY, APRIL 28

### **Scholars' Program Breakfast with IARS, AUA and SOCCA Leadership and Mentors\***

6:15 am – 7:15 am, Regency C, Ballroom Level, West Tower

Share the most important meal of the day and network with the IARS, AUA and SOCCA Leadership and Mentors in anesthesiology education and research.

### **IARS, AUA and SOCCA Alignment Reception**

6:00 pm – 7:30 pm, Regency D & Foyer, Ballroom Level, West Tower

Come together and celebrate the convergence of the IARS, AUA and SOCCA Annual Meetings and meet the leaders in all subspecialties in anesthesiology in one location, Chicago. Be sure to visit the Tabletop Exhibits, too. Relax, unwind and join your colleagues at this upbeat event.



*\*The Scholars' Program requires a separate \$50 non-refundable fee and pre-registration. This fee includes education sessions, reception, breakfast and lunch. Seating is limited.*



# Continuing Medical Education (CME) Information

## Activity Overview

The Society of Critical Care Anesthesiologists (SOCCA) 2018 Annual Meeting and Critical Care Update is designed to optimize outcomes for critically ill patients and their families through evidence-based and clinically-oriented physician education. The purpose of the SOCCA Annual Meeting and Critical Care Update is to advance knowledge, improve competence, and enhance performance of intensive care teams.

## Target Audience

The SOCCA 2018 Annual Meeting and Critical Care Update is designed for anesthesiologists in the clinical and laboratory setting.

## Educational Objectives

As a result of participating in this live CME activity, learners will be able to:

- Evaluate the current state of emerging knowledge and practice patterns and assess the relevance to their professional practice;
- Incorporate new knowledge from advances in anesthesiology practice into their professional practice areas; and
- Distinguish gaps in their knowledge, behavior, and patient outcomes that may result in a need for additional education and training.

## Accreditation Statement

This activity has been planned and implemented in accordance with the accreditation requirements and policies of the Accreditation Council for Continuing Medical Education (ACCME) through the joint providership of the International Anesthesia Research Society (IARS) and the Society of Critical Care Anesthesiologists (SOCCA). The IARS is accredited by the ACCME to provide continuing medical education for physicians.

## CME Credit

The International Anesthesia Research Society (IARS) designates this live activity for a maximum of 7.5 AMA PRA Category 1 Credits.<sup>™</sup> Physicians should claim only the credit commensurate with the extent of their participation in the activity.

## Claiming CME Credit

The IARS will provide online program evaluation and session tracking to support claiming CME credit beginning on Wednesday, May 2. Meeting participants will have 90 days to claim CME credit.

## Maintenance of Certification in Anesthesiology Program<sup>®</sup> (MOCA<sup>®</sup>)

Physicians wishing to have credits from this educational activity reported to the ABA for the ABA MOCA<sup>®</sup> Program may do so by entering their eight digit ABA identification number when claiming CME credit. The IARS forwards credits to the ABA on a quarterly basis. *Sessions approved for ABA MOCA 2.0<sup>®</sup> Patient Safety CME credit is designated by .*

## Disclosure

The International Anesthesia Research Society (IARS) makes every effort to develop CME activities that are independent, objective, scientifically balanced presentations of information. The IARS has implemented mechanisms requiring everyone in a position to control content to disclose all financial relationships with commercial interests. Disclosure of any or no relationships is made available in advance of all educational activities. The IARS evaluates, and if necessary, resolves any conflicts of interest prior to the start of the activity. Individuals who refuse or fail to provide the required disclosures are disqualified from being a planning committee member, teacher, or author of CME, and cannot have control of, or responsibility for, the development, management, presentation or evaluation of the CME activity.

## Disclaimer

The information provided in this CME activity is for continuing education purposes only and is not meant to substitute for the independent medical judgment of a healthcare provider relative to diagnostic and treatment options of a specific patient's medical condition.

## Commercial Support

This CME activity is supported entirely by the Society of Critical Care Anesthesiologists (SOCCA). There is no commercial support for this activity.

# SOCCA Committee on Education and Board of Directors



## SOCCA Committee on Education

### Chair

**Adam S. Evans, MD, MBA, FCCM**

Associate Professor,  
Icahn School of Medicine at Mount Sinai  
New York, New York

**Sheela Pai Cole, MD**

Associate Professor, Anesthesiology  
Stanford University  
Stanford, California

**Thomas A. Cooper**

Executive Director, IARS  
San Francisco, California

**Peter Von Homeyer, MD, FASE**

University of Washington Medical Center  
Seattle, Washington

## SOCCA Board of Directors

### Officers

**President****Avery Tung, MD, FCCM**

University of Chicago Medicine  
Chicago, Illinois

**Secretary****Michael H. Wall, MD, FCCM**

University of Minnesota  
Medical School  
Minneapolis, Minnesota

**ASA Alternate Delegate****(Ex-Officio)****S. Patrick Bender, MD**

University of Vermont Medical Center  
Burlington, Vermont

**President-Elect****Daniel R. Brown, MD, PhD, FCCM**

Mayo Clinic College of Medicine  
and Science  
Rochester, Minnesota

**Immediate Past President****Aryeh Shander, MD, FCCM, FCCP**

Englewood Hospital and  
Medical Center  
Englewood, New Jersey

**Canadian Representative****(Ex-Officio)****Patricia M. Murphy, MD**

Toronto General Hospital  
Toronto, Ontario, Canada

**Treasurer****Miguel A. Cobas, MD, FCCM**

University of Miami  
Miller School of Medicine  
Jackson Memorial Hospital  
Miami, Florida

**ASA Delegate (Ex-Officio)****Stephen D. Surgenor, MD**

Dartmouth-Hitchcock  
Medical Center  
Lebanon, New Hampshire

### Directors

**James M. Blum, MD, FCCM**

Emory University School of Medicine  
Atlanta, Georgia

**Benjamin A. Kohl, MD, FCCM**

Thomas Jefferson University  
Philadelphia, Pennsylvania

**Mark E. Nunnally, MD, FCCM**

New York University  
Langone Health  
New York, New York

**Michael Haney, MD, PhD**

Umeå University  
Umeå, Sweden

**Linda L. Liu, MD**

University of California,  
San Francisco School of Medicine  
San Francisco, California



## Program Faculty

### **Lu Che, MD**

Anesthesiology Department, Peking Union Medical College Hospital, Beijing, China; *Young Investigator Award – 2nd Runner-Up*

### **Matthias Eikermann, MD, PhD**

Professor of Anaesthesia, Department of Anesthesia, Critical Care and Pain Medicine, Massachusetts General Hospital, Harvard Medical School, Boston, Massachusetts

### **Adam S. Evans, MD, MBA, FCCM**

Associate Professor, Cardiothoracic Surgery, Icahn School of Medicine at Mount Sinai, New York, New York; *Chair, Committee on Education, SOCCA*

### **Douglas B. Coursin, MD**

Vice-Chair for Faculty Development, Professor of Anesthesiology and Internal Medicine, University of Wisconsin School of Medicine and Public Health, Madison, Wisconsin

### **Jacob Gutsche, MD**

Assistant Professor, Anesthesiology and Critical Care, Perelman School of Medicine, University of Pennsylvania, Philadelphia, Pennsylvania

### **Leila Hosseinian, MD**

Director of CTICU, Program Director Anesthesia, CCM Fellowship; Anesthesiology, Icahn School of Medicine at Mount Sinai, New York, New York

### **Todd Kelly, MD**

Critical Care Division Chief, Intensivist, Anesthesiologist, United States Anesthesia Partners, Houston, Texas

### **Ashish K. Khanna, MD, FCCP, FCCM**

Staff Anesthesiologist and Intensivist, Assistant Professor of Anesthesiology CCLCM, Vice-Chief for Research, Center for Critical Care, Anesthesiology Institute, Cleveland Clinic Foundation, Cleveland, Ohio; *Young Investigator Award – 1st Runner-Up*

### **Junghyun Kim, MD, PhD**

Visiting Post-Doctoral Fellow, Department of Anesthesiology, University of Maryland School of Medicine, Baltimore, Maryland; *Young Investigator Award – Winner*

### **Daryl J. Kor, MD, MSc**

Consultant, Department of Anesthesiology and Perioperative Medicine, Mayo Clinic College of Medicine and Science, Rochester, Minnesota

### **Michael Lanspa, MD, MS**

Assistant Professor, Adjunct, Pulmonary and Critical Care Medicine, University of Utah School of Medicine; Director, Critical Care Echocardiography Training, University of Utah, Intermountain Medical Center, Salt Lake City, Utah

### **Jeffrey Mechanick, MD**

Professor of Medicine, Divisions of Cardiology and Endocrinology, Diabetes and Bone Disease, Icahn School of Medicine at Mount Sinai, New York, New York

### **Mark E. Nunnally, MD, FCCM**

Director, Adult Critical Care Services, New York University Langone Health, New York, New York

### **Sheela Pai Cole, MD**

Associate Professor, Anesthesiology, Stanford University, Stanford, California

### **Pratik Pandharipande, MD, MSCI**

Professor of Anesthesiology and Surgery, and Chief, Division of Anesthesiology Critical Care Medicine, Vanderbilt University Medical Center, Nashville, Tennessee

### **Venkatakrishna Rajajee, MBBS**

Clinical Associate Professor, Neurological Surgery, Associate Professor, Neurology, University of Michigan Medicine, Ann Arbor, Michigan

### **Cortessa Russell, MD**

Assistant Professor of Anesthesiology, Columbia University College of Physicians and Surgery, New York, New York

### **Inigo San Millan, PhD**

Director, Exercise Physiology Lab, Director of the Sports Performance Program, Assistant Professor, University of Colorado School of Medicine, Aurora, Colorado

### **Audrey Shafer, MD**

Professor, Anesthesiology, Perioperative and Pain Medicine, Faculty, Stanford Center for Biomedical Ethics, Co-Director, Biomedical Ethics and Medical Humanities Scholarly Concentration, Director, Medicine and the Muse Program, Staff Anesthesiologist, VA Palo Alto Health Care System, Stanford, California

### **Christian Stoppe, MD**

Assistant Professor, Department of Intensive Care Medicine, Executive Head of Cardiovascular Critical Care and Anesthesia Evaluation and Research Unit, RWTH Aachen University, Aachen, Germany

### **Avery Tung, MD, FCCM**

Professor of Anesthesia and Critical Care, Quality Chief for Anesthesia, Anesthesia and Critical Care, The University of Chicago Medicine, Chicago, Illinois; *President, SOCCA; Executive Section Editor, Critical Care and Resuscitation, Anesthesia & Analgesia*

### **Jeffery S. Vender, MD, FCCP, FCCM, MBA**

Chairman of Anesthesiology, NorthShore University HealthSystem, Evanston, Illinois; *2018 SOCCA Lifetime Achievement Award Winner*

### **Paul E. Wischmeyer, MD, EDIC**

Professor, Department of Anesthesiology, Division of Critical Care Medicine, Associate Vice Chair for Clinical Research, Co-Director, Academic Career Enrichment Scholars (ACES) Resident Research Program, Duke University School of Medicine; Director, Perioperative Research, Duke Clinical Research Institute (DCRI), Durham, North Carolina

# Program Schedule



## THURSDAY, APRIL 26

7:00 pm – 8:00 pm

SOCCA Reception with Exhibitors

## FRIDAY, APRIL 27

7:00 am – 8:00 am

Breakfast with Exhibitors

7:00 am – 8:00 am

**Sunrise Panel: *Emerging Practice Paradigms in Critical Care Practice***

**Moderator:** Ashish K. Khanna, MD, FCCP, FCCM

**Presenters:**

- **Anesthesiologist-Intensivist in Private Practice**  
Todd Kelly, MD
- **CVICU**  
Jacob Gutsche, MD
- **Hospital Administration**  
Mark E. Nunnally, MD, FCCM

**Learner Objectives:** After participating in this activity, the learner will be able to: (1) Evaluate the financial role of critical care services to a hospital; (2) Explain a transparent, multi-specialty service model for critical care staffing; and (3) Review emerging staffing models for the CVICU.

8:00 am – 8:15 am

**Welcome Address and Introduction (Non-CME)**

- Avery Tung, MD, FCCM, *President, Society of Critical Care Anesthesiologists*
- Adam S. Evans, MD, MBA, FCCM, *Chair, Committee on Education*



The Jay Pritzker Pavilion, located in Millennium Park, was designed by Frank Gehry and is the home of the Grant Park Symphony Orchestra and Chorus and the Grant Park Music Festival.

8:15 am – 9:45 am



**Education Session I: *Metabolic Support for the Postoperative Patient in the ICU***

**Moderator:** Adam S. Evans, MD, MBA, FCCM

**Presenters:**

- **A Call to Action for Anesthesia-Intensivists**  
Jeffrey Mechanick, MD
- **Targeting the Microbiome in the ICU**  
Paul E. Wischmeyer, MD, EDIC
- **Perioperative Glycemic Control**  
Leila Hosseinian, MD
- **Feeding the Postoperative Patient-Challenges and Opportunities**  
Christian Stoppe, MD

**Learner Objectives:** After participating in this activity, the learner will be able to: (1) Formulate a protocol for intensive metabolic support that includes tight glycemic control and nutrition support for patients that are postoperative in the ICU; (2) List three circumstances where patients that are postoperative in the ICU will require early parenteral nutrition support; (3) Discuss how a preoperative optimization of the nutritional state should be targeted in the malnourished patient undergoing cardiac surgery; (4) Explain how a postoperative nutritional therapy should be initiated early postoperatively (0-24 hours after surgery) in hemodynamically stable patients at risk for malnutrition with an expected prolonged ICU stay; and (5) Discuss how an additional immune-modulating component to nutrition should be considered if initiated early postoperatively within 12 hours after ICU admission.

9:45 am – 10:15 am

Break with Exhibitors

10:15 am – 11:15 am



**Education Session II: *Enhancing Recovery from Critical Illness and Life Thereafter***

**Moderator:** Peter Von Homeyer, MD, FASE

**Presenters:**

- **Metabolic Decay and Rehabilitation During and Post-ICU**  
Inigo San Millan, PhD
- **Early Rehab**  
Matthias Eikermann, MD, PhD
- **Post ICU Recovery Clinics**  
Pratik Pandharipande, MD, MSCI

**Learner Objectives:** After participating in this activity, the learner will be able to: (1) Review and discuss the metabolic and nutritional challenges at the ICU; and (2) Discuss and analyze proposed metabolic mechanisms and approaches for recovery post-ICU.

11:15 am – 11:30 am

Break with Exhibitors



## Program Schedule, *continued*

### FRIDAY, APRIL 27, *continued*

11:30 am – 12:30 pm

Education Session III:  
**Wellness for the Anesthesiologist-Intensivist**

**Moderator:** Sheela Pai Cole, MD

**Presenters:**

- **Preventing Burnout**  
Cortessa Russell, MD
- **Improving Resilience**  
Sheela Pai Cole, MD
- **Dealing with Grief**  
Audrey Shafer, MD

**Learner Objectives:** After participating in this activity, the learner will be able to: (1) Discuss how the arts and humanities can help the clinician deal with suffering; and (2) Evaluate how the arts and humanities can enable empathy.

12:30 pm – 1:30 pm

**SOCCA Lunch Satellite Symposium (Non-CME)** – open to all attendees, pre-registration required

1:30 pm – 2:00 pm

Lifetime Achievement Award Presentation:  
**Leadership for Today, Change for Tomorrow**

**Introduction:** Douglas B. Coursin, MD

**Presenter:** Jeffery S. Vender, MD

**Learner Objectives:** After participating in this activity, the learner will be able to: (1) Define key elements to the change process; (2) Identify the role of leadership in complex change scenarios; and (3) Identify the changing environment in critical care.

2:00 pm – 2:45 pm

Young Investigator Awards Presentation

**Moderator:** Daryl J. Kor, MD, MSc

**YOUNG INVESTIGATOR AWARD – WINNER**

**Contrasting Effects of Stored Allogeneic Red Blood Cells and Their Supernatants on Permeability and Inflammatory Responses by Human Pulmonary Artery Endothelial Cells**

Junghyun Kim, MD

**YOUNG INVESTIGATOR AWARD – 1ST RUNNER-UP**

**Association of Angiotensin II Dose with All-Cause Mortality in Patients with Vasodilatory Shock**

Ashish K. Khanna, MD, FCCP, FCCM

**YOUNG INVESTIGATOR AWARD – 2ND RUNNER-UP**

**CHA2DS2-VASc Score for Risk Prediction of Venous Thromboembolic Events After Total Joint Arthroplasty**

Lu Che, MD

**Learner Objectives:** After participating in this activity, the learner will be able to: (1) Summarize findings of current research; and (2) Explain application in clinical practice.

2:45 pm – 3:00 pm

Break with Exhibitors

3:00 pm – 3:45 pm

**Moderated Poster Discussion Session**

**Learner Objectives:** After participating in this activity, the learner will be able to: (1) Describe the latest developments in anesthesiology research in basic, clinical and population science; (2) Examine recent research findings relative to anesthesiology and evaluate their application to the learner's own research and clinical practice; and (3) Construct strategies for integrating new knowledge into anesthesiology research programs.

3:45 am – 4:00 pm

Break with Exhibitors

4:00 pm – 5:00 pm

Education Session IV: **Innovative Uses of Ultrasound in ICU**

**Moderator:** Peter Von Homeyer, MD, FASE

**Presenters:**

- **Respiratory Failure**  
Michael Lanspa, MD, MS
- **Optic US for ICP Monitoring**  
Venkatakrisna Rajajee, MBBS
- **Nutrition**  
Paul E. Wischmeyer, MD, EDIC
- **RV Strain**  
Aalok K. Kacha, MD, PhD

**Learner Objectives:** After participating in this activity, the learner will be able to: (1) Explain the principle behind the use of optic nerve ultrasound (ONUS) to detect intracranial hypertension; and (2) Discuss the evidence on the accuracy of ONUS compared to the gold standard of invasive monitoring; (3) Describe an algorithm for rapid echocardiographic assessment of the right ventricle; and (4) Identify common acute right ventricular pathology on echocardiography.

5:00 pm – 5:15 pm

Closing Remarks (Non-CME)

5:15 pm – 6:00 pm

SOCCA Annual Business Meeting (Non-CME)

6:00 pm – 7:00 pm

IARS, AUA, SOCCA and eSAS Scholars' Program  
Mentoring and Networking Reception\*

\* The Scholars' Program requires a separate \$50 non-refundable fee and pre-registration. This fee includes education sessions, reception, breakfast and lunch. Seating is limited.

# Aligned Meeting and Focus on Critical Care Day at the IARS 2018 Annual Meeting and International Science Symposium



## Saturday, April 28

The attendees of the SOCCA Annual Meeting will have the opportunity to take advantage of a special Aligned Meeting and SOCCA Focus on Critical Care Day on Saturday, April 28, complimentary as part of their registration fee. Thought leaders in anesthesiology will present a wide selection of robust education sessions, highlighting pioneering topics in anesthesia and celebrating advances in education, science, research and the art of anesthesiology.

- 6:15 am – 7:15 am **Scholars' Program Breakfast with IARS, AUA and SOCCA Leadership and Mentors**  
Meet with the IARS, AUA and SOCCA Leadership and Mentors over breakfast.
- 7:30 am – 9:00 am **Opening General Session and T.H. Seldon Memorial Lecture:  
*Personalizing Health Care in the Era of Big Data***  
with Dr. Jeffrey R. Balsler  
Over the past two decades, Dr. Balsler has guided expansion of Vanderbilt University School of Medicine research programs in personalized medicine, human subjects research, and population health, moving Vanderbilt University School of Medicine's ranking to eighth in the nation among U.S. medical schools in total grant support provided through the National Institutes of Health (NIH).
- 9:30 am – 10:30 am **Problem-Based Learning Discussion: SOCCA: *To Intubate or Not: Management of Post-Operative Acute Respiratory Failure***  
with Dr. Kunal Karamchandani  
Management of postoperative acute respiratory failure can be challenging. Early recognition and prompt treatment is critical to prevent significant morbidity and mortality. In this case-based session, discuss the principles and utility of non-invasive ventilation (NIV) and high flow nasal cannula (HFNC) in the management of acute hypoxic respiratory failure.
- 9:30 am – 12:00 pm **Symposium: AUA: *Mitochondria and Bioenergetics in Health and Disease: It's Not Just a Power Failure!***  
with Drs. Paul S. Brookes, Elizabeth A. Jonas, Y.S. Prakash, Douglas L. Rothman, and Douglas C. Wallace  
This invigorating symposium will highlight important questions relating to mitochondria and bioenergetics that impact the perioperative environment. Examine the roles of altered mitochondrial structure and function as well as bioenergetics and unintended consequences of drugs or other interventions on mitochondria and bioenergetics and how this may help improve and individualize patient care.
- 11:15 am – 12:00 pm **Review Course Lecture: SOCCA: *The Tele-Vision: Taking Care to the Patient and Expanding the Scope of the Intensivist***  
with Dr. Liza M. Weavind  
The reality of virtual care is upon us, and it is our responsibility as intensivists to maximize the potential of telemedicine to leverage ourselves and provide care to an ever widening circle of patients, not limited to the critically ill in our ICUs. Our patients may be acutely deteriorating on a non-monitored floor or being evaluated in an emergency department. Our input as intensivists, in real time, in remote geographic locations, within or outside of the hospital may be lifesaving. Utilizing telemedicine to take critical care to the patient, rather than bringing the patient to the ICU, should be our goal.
- 12:00 pm – 1:00 pm **Problem-Based Learning Discussion: AUA: *Why Study Time Doesn't Always Lead to Learning: How Do We Help the Struggling Trainee? – Offered Twice!***  
with Drs. Ersne Eromo and Daniel Saddawi-Konefka  
This hands-on session will provide various self-study methods available to trainees, including relative effectiveness of each technique, offering an approach to unpack a trainee's study habits and to prepare a study plan for a hypothetical trainee that combines effective learning modalities.
- 2:00 pm – 3:00 pm **Problem-Based Learning Discussion: SOCCA: *The Sweet Escape: A Complicated Case of DKA***  
with Dr. George W. Williams, II  
Join this exciting discussion and examine an intriguing case of diabetic ketoacidosis (DKA). Evaluate a case of a middle-aged man who presents with a preliminarily negative cardiac workup and yet has chest pain. Endocrine, renal and infectious diseases come into play in this real case.

# Aligned Meeting and Focus on Critical Care Day at the IARS 2018 Annual Meeting and International Science Symposium

## Saturday, April 28

- 2:30 pm – 3:30 pm **Problem-Based Learning Discussion: AUA: Why Study Time Doesn't Always Lead to Learning: How Do We Help the Struggling Trainee? – Offered Twice!**  
with Drs. Ersne Eromo and Daniel Saddawi-Konefka
- 4:00 pm – 5:00 pm **Problem-Based Learning Discussion: AUA: Getting to the Heart of the Matter: Perioperative Focused Cardiac and Pulmonary Ultrasound, and The Hemodynamically Unstable Patient**  
with Drs. Alexander S. Kuo and Abraham Sonny  
Evaluate the role of anesthesiologist-performed focused cardiac and pulmonary ultrasound in the perioperative period and the role of focused ultrasound in hemodynamic assessment for guiding diagnosis and management of undifferentiated shock.
- 4:00 pm – 5:00 pm **Problem-Based Learning Discussion: SOCCA: Perioperative Renal Replacement Therapy for the Anesthesiologist: Does It Make A Difference?**  
with Dr. Dragos Galusca  
Anesthetic management of high-risk patients undergoing major hepatic surgery can involve the use of perioperative renal replacement therapy (RRT). Examine the risk factors and etiology of renal injury for patients undergoing major (hepatic) surgery during this discussion session.
- 5:00 pm – 5:45 pm **Review Course Lecture: SOCCA: Heart Failure with Preserved Ejection Fraction (HFpEF) as a Perioperative Risk**  
with Dr. Aalok Kacha  
Heart failure with preserved ejection fraction (HFpEF) accounts for approximately 50% of cases of heart failure. HFpEF confers an increased risk of perioperative morbidity and mortality. Assess how the phenotypes, evaluation, and management of HFpEF is important for the perioperative physician given the increasing prevalence of ICUs.
- 6:00 pm – 7:30 pm **IARS, AUA and SOCCA Alignment Reception**  
Mingle with your colleagues and peers in all subspecialties of anesthesiology. Plus, visit the Tabletop Exhibits.

### Bonus! Focus on Critical Care Session on Sunday, April 29, Complimentary for SOCCA Attendees

- 4:00 pm – 5:30 pm **Panel: SOCCA: 50 Years of ARDS: An Update**  
with Drs. Kunal Karamchandani, Brian Kavanagh, Daniel S. Talmor, Avery Tung, and Michael H. Wall  
Despite heightened awareness and extensive research related to acute respiratory distress syndrome (ARDS) over the last 50 years, ARDS represents an important public health problem globally and is associated with a mortality rate of approximately 40%. ARDS continues to be under-recognized and under-treated in terms of the use of optimal, proven, or recommended approaches to mechanical ventilation. Attend this panel and discover strategies to prevent and treat ARDS.

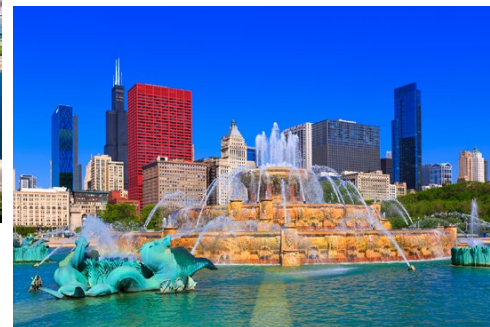
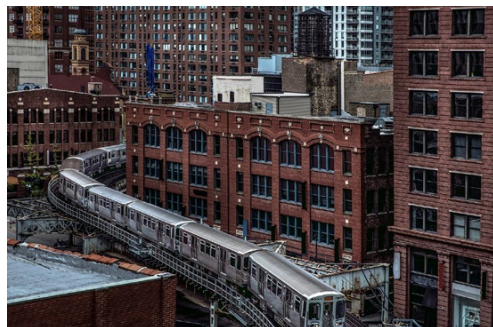

# Scholars' Program

## Friday, April 27 – Saturday, April 28



The Scholars' Program is for early-stage scholars and trainees in anesthesiology who are looking for best practices as they adapt to the rapidly changing world of academic anesthesia and medicine. Through innovative teaching approaches, scholars and trainees will receive the much-needed skills they desire while interacting with peers and mentors.

*The Scholars' Program requires a separate \$50 non-refundable fee and pre-registration, which includes education sessions, reception, breakfast and lunch. Seating is limited.*



### Friday, April 27 • 6:00 pm – 7:00 pm

#### IARS, AUA, SOCCA and eSAS Scholars' Program Mentoring and Networking Reception

Based on rigorous evaluation of both mentors' expertise and trainees' needs, goal-focused interactions will be fast-tracked. Trainees will be matched with a mentor and have an opportunity to interact during this reception.

### Saturday, April 28 • 6:15 am – 7:15 am

#### Breakfast with IARS, AUA and SOCCA Leadership and Mentors

Share the most important meal of the day and network with the IARS, AUA and SOCCA Leadership and Mentors in anesthesiology education and research.

### Saturday, April 28 • 9:30 am – 9:40 am

#### Introduction to the Scholars' Program and eSAS

with Drs. Vivianne Tawfik and Elizabeth L. Whitlock

The Scholars' Program is an amazing opportunity for early-stage faculty, fellows, residents and other trainees to gain exposure to exciting advances in the field, learn more about career development in academic anesthesiology and meet other early-stage scholars.

### Saturday, April 28 • 9:40 am – 10:30 am

#### Moving from Insight to Scientific Premise to Research Program and What This is All About

with Drs. Max B. Kelz and Katie J. Schenning

Delve deeply into scientific premises and gain insight into the most thought-provoking research programs in anesthesiology.

### Saturday, April 28 • 10:45 am – 12:15 pm

#### Shine Like A Rockstar: Different Paths to Success

with Drs. Boris D. Heifets, Laureen Hill, Manoj M. Lalu, Peter Nagele, and Paloma Toledo

Learn how to succeed on the clinician-investigator track and observe highlighted pathways, illustrating lessons learned towards success in academic anesthesiology.

### Saturday, April 28 • 12:30 pm – 2:00 pm

#### Lunch Session: Resilience Personified: Transitioning from Trainee to Junior Faculty and Beyond

with Drs. Julie K. Freed, Ken Solt, and Elizabeth L. Whitlock

As young physician scientists continue to face unique challenges, it is important to address the transition from trainee to early-stage faculty including all the pitfalls along the way. Hear about the paths taken by two early-stage scholars during this session.

### Saturday, April 28 • 2:15 pm – 3:45 pm

#### Moving Fluidly Across the Translational Spectrum: Current Opioid Crisis

with Drs. Catherine Chen, Afton Hassett, Michael R. Mathis, Giancarlo Vanini, and Jennifer F. Waljee

Explore the promising avenue of innovative and scalable self-management strategies and discuss how effectively empowering patients with anxiety and pain-coping skills would hopefully decrease the use of analgesics and increase patient satisfaction.

### Saturday, April 28 • 4:00 pm – 5:00 pm

#### Priorities for Developing Researchers: Perspectives from the NIH and IARS

with Drs. Emery N. Brown, Alison Cole, and Robert E. Freundlich

Discover and evaluate the most important priorities for developing researchers from several perspectives including the NIH and IARS.

### Saturday, April 28 • 5:10 pm – 6:10 pm

#### From the Editor's Desk: A No-Nonsense Guide to Successful Publication

with Drs. Hilary P. Grocott, Kate Leslie, and Jamie R. Privratsky

Great research deserves wide dissemination; therefore, providing early-career researchers a no-nonsense and hassle-free approach to designing, implementing, reporting and submitting studies is necessary to maximize impact.

# Clinical Research Consortium: Collaborative Research Initiative for Perioperative Clinical and Translational Science Meeting

Tuesday, May 1, 1:00 pm – 4:00 pm  
Regency B, Ballroom Level, West Tower

Because Five Organizations are Better than One



Five prominent anesthesiology organizations have come together to establish a clinical trials network in the United States, focusing specifically on perioperative medicine, critical care, pain management, and peri- and post-partum care.

Please join us at the Hyatt Regency Chicago, for this important gathering. Those interested in anesthesiology-related clinical and translational science are strongly encouraged to attend.

The agenda includes:

- Panel on innovative and efficient approaches to multicenter clinical trials
- Presentations by the Duke Clinical Research Institute (DCRI) and the Multicenter Perioperative Outcomes Group (MPOG)

There is no fee to participate in the Clinical Research Consortium; register onsite day of the event.

## Participating Organizations:

- Association of University Anesthesiologists (AUA)
- Early-Stage Anesthesiology Scholars (eSAS)
- The Foundation for Anesthesia Education and Research (FAER)
- The International Anesthesia Research Society (IARS)
- The Society of Critical Care Anesthesiologists (SOCCA)



For more information, visit [bit.ly/IARSconsortium](http://bit.ly/IARSconsortium).

# Poster General Information



## Poster Room Location and Hours

Riverside West, Exhibits Level, East Tower

Thursday, April 26. . . . . 6:00 am – 5:00 pm  
 Friday, April 27 . . . . . 6:00 am – 5:00 pm

## Poster Information and Check-In Desk Location and Hours

Entrance to Poster Room, Riverside West, Exhibits Level, East Tower

Thursday, April 26. . . . . 6:00 am – 6:00 pm  
 Friday, April 27 . . . . . 6:00 am – 6:00 pm

A staff member will be available at the Poster Information and Check-in Desk to assist you in finding your poster board or with any questions. Please check in at the desk 15 minutes prior to your presentation.

## Poster Pickup Location and Hours:

Riverside West, Exhibit Level, East Tower

Thursday, April 26. . . . . 6:00 am – 2:00 pm  
 Friday, April 27 . . . . . 6:00 am – 2:00 pm

## Poster Setup:

Friday, April 27 . . . . . 7:00 am – 8:00 am

## Poster Breakdown:

Friday, April 27 . . . . . 5:00 pm – 6:00 pm

## Oral and Poster Presentation Times

### Young Investigator Abstract Awards Presentation:

Regency C, Ballroom Level, West Tower

Friday, April 27 . . . . . 2:00 pm – 2:45 pm

## Moderated Poster Discussion Session:

Riverside West, Exhibit Level, East Tower

Friday, April 27 . . . . . 3:00 pm – 3:45 pm

## Moderated Poster Discussion Session Learner Objectives:

After participating in this activity, the learner will be able to: (1) Describe the latest developments in anesthesiology research in basic, clinical and population science; (2) Examine recent research findings relative to anesthesiology and evaluate their application to the learner's own research and clinical practice; and (3) Construct strategies for integrating new knowledge into anesthesiology research programs.

## Poster Presenter Instructions

Presenters are required to be in attendance at their assigned Moderated Poster Discussion Session and should check-in at the poster desk on arrival. Presenters will provide a 3-5 minute summary of their most important research findings. The poster moderator for your poster session will assist with facilitating discussion.

## Assigned Poster Board Identification and Location

A poster board ID is assigned to all presenting authors. The assigned IDs will be affixed to each poster board in the poster room. Poster Board numbers will be placed at the end of each aisle in the poster session room. A staff member will be available to assist you in finding your poster board.

## Poster Board ID Format and Abstract Key for Anesthesia Subspecialty Topics

The Poster Board ID format is the following: Poster Board Anesthesia Subspecialty Topic Abbreviation Poster Board # (Abstract #). Example: AM 1 (230). Please see the Abstract Category Key for Anesthesia Subspecialty Topics below.

## Abstract Category Key

Abstracts Category for Anesthesia Subspecialty Topics	Abbreviation
Airway Management	AM
Ambulatory Anesthesia	AMB
Anesthetic Pharmacology	AP
Bench Science	BS
Blood Management	BLD
Cardiovascular Anesthesiology	CA
Critical Care	CC
Economics, Education and Policy	EEP
Geriatric Anesthesia	GA
Global Health	GH
Liver	L
Medically Challenging Cases	MCC
Metabolism and Perioperative Care	MPC
Neuroscience in Anesthesiology and Perioperative Medicine	NR
Obesity	O
Obstetric Anesthesiology	OB
Pain and Addiction Pathways	PAP
Pain Mechanisms	PME
Pain Medicine	PM
Patient Safety	PS
Pediatric Anesthesiology	PED
Perioperative Anesthesia	PA
Regional Anesthesia	RA
Respiration	RES
Sleep Medicine	SM
Technology, Computing and Simulation, Equipment Monitoring	TCSEM
Trauma	T



# Moderated Poster Discussion Session Poster Board Category Key



Subspecialty Category	Poster Number
Airway Management	159-161
Anesthetic Pharmacology	170
Bench Science	187
Blood Management	172-177, 236
Cardiovascular Anesthesiology	179-183
Critical Care	166, 185-186, 188, 192-228, 240, 241
Economics, Education and Policy	262, 263
Geriatric Anesthesia	255, 256
Global Health	264
Liver	184
Medically Challenging Cases	167, 173, 190, 251, 269-327, 330-356, 360-362, 364-373
Metabolism and Perioperative Care	248-249
Neuroscience in Anesthesiology and Perioperative Medicine	375-383
Obesity	250
Obstetric Anesthesiology	189, 252-253
Pain Medicine	390-392
Patient Safety	265-267
Pediatric Anesthesiology	257-260
Perioperative Anesthesia	162, 385, 388, 394-405
Regional Anesthesia	168-169
Respiration	224
Technology, Computing and Simulation, Equipment Monitoring	229-238
Trauma	242-245



# Abstract Award Winners

The **Young Investigator Award** is presented annually to the abstract author whose research exemplifies the Society's mission to educate anesthesiologists in the care of critically ill patients and to foster the knowledge and practice of critical care medicine by anesthesiologists.

## Young Investigator Award • Winner

### **Contrasting Effects of Stored Allogeneic Red Blood Cells and Their Supernatants on Permeability and Inflammatory Responses by Human Pulmonary Artery Endothelial Cells**

**Junghyun Kim**, Trang Nguyen, Michael A. Mazzeffi, Kenichi Tanaka, Anna Birukova, Konstantin Birukov  
*University of Maryland School of Medicine, Baltimore, Maryland*

## Young Investigator Award • 1st Runner-Up

### **Association of Angiotensin II Dose with All-cause Mortality in Patients with Vasodilatory Shock**

**Ashish K. Khanna**<sup>1</sup>, Michael McCurdy<sup>2</sup>, David Boldt<sup>3</sup>, Kealy R. Ham<sup>4</sup>, Kenneth Krell<sup>5</sup>, Lakhmir S. Chawla<sup>5</sup>, George F. Tidmarsh<sup>6</sup>  
*<sup>1</sup>Cleveland Clinic Lerner College of Medicine, Cleveland, Ohio; <sup>2</sup>University of Maryland School of Medicine, Baltimore, Maryland; <sup>3</sup>University of California, Los Angeles, Los Angeles, California; <sup>4</sup>Regions Hospital, University of Minnesota, St. Paul, Minnesota; <sup>5</sup>Eastern Idaho Regional Medical Center, Idaho Falls, Idaho; <sup>6</sup>La Jolla Pharmaceutical Company, La Jolla, California*

## Young Investigator Award • 2nd Runner-Up

### **CHA2DS2-VASc Score for Risk Prediction of Venous Thromboembolic Events After Total Joint Arthroplasty**

**Lu Che**<sup>1</sup>, Yuguang Huang<sup>1</sup>, Hui Liu<sup>2</sup>  
*<sup>1</sup>Peking Union Medical College Hospital, Beijing, China; <sup>2</sup>Peking University, Beijing, China*

# Moderated Poster Discussion Session

## Friday, April 27, 2018 • 3:00 pm – 3:45 pm



### Group 1: Airway Management and Perioperative Anesthesia

**Moderator: John Klick, MD**, Penn State Milton S. Hershey Medical Center, Hershey, Pennsylvania

#### AM 159 (1257)

##### **Non-Invasive Ventilation in Perioperative Surgical Patients**

**Brooke LeBlanc<sup>1</sup>**, Phillip Boysen<sup>2</sup>, Bobby Nossaman<sup>2</sup>, Michael Townsend<sup>2</sup>, Jacqueline Wilson<sup>1</sup>

<sup>1</sup>Ochsner Medical Center, New Orleans, Louisiana; <sup>2</sup>Ochsner Clinic Foundation, New Orleans, Louisiana

#### AM 160 (911)

##### **Current Practice of Cricoid Pressure Application for Endotracheal Intubation**

**Jacob R. Caylor<sup>1</sup>**, Jaspreet Somal<sup>1</sup>, Basem Abdelmalak<sup>2</sup>

<sup>1</sup>University of California, San Diego School of Medicine, San Diego, California; <sup>2</sup>Anesthesiology Institute; Cleveland Clinic, Cleveland, Ohio

#### AM 161 (1004)

##### **A Pilot Study of Radiological Variables to Predict Fiberoptic Intubation in Ankylosing Spondylitis with Cervical Spine Involvement**

**Lu Che<sup>1</sup>**, ZhuHua Zhang<sup>1</sup>, LiJian Pei<sup>2</sup>, Yuguang Huang<sup>1</sup>

<sup>1</sup>Peking Union Medical College Hospital, Beijing, China; <sup>2</sup>Peking Union Medical College, Beijing, China

#### PA 162 (990)

##### **CHA2DS2-VASc Score for Risk Prediction of Venous Thromboembolic Events After Total Joint Arthroplasty**

**Lu Che<sup>1</sup>**, Yuguang Huang<sup>1</sup>, Hui Liu<sup>2</sup>

<sup>1</sup>Peking Union Medical College Hospital, Beijing, China; <sup>2</sup>Peking University, Beijing, China

#### AM 163 (1104)

##### **Difficult Tracheal Extubation in Adult Surgical Intensive Care**

**Tim Ziethen<sup>1</sup>**, Phillip Boysen<sup>2</sup>, Bobby Nossaman<sup>2</sup>, Michael Townsend<sup>2</sup>, Jacqueline Wilson<sup>1</sup>

<sup>1</sup>Ochsner Medical Center, New Orleans, Louisiana; <sup>2</sup>Ochsner Clinic Foundation, New Orleans, Louisiana

### Group 2: Airway Management, Anesthetic Pharmacology, Critical Care, Medically Challenging Cases, and Regional Anesthesia

**Moderator: Alok Gupta, MD**, Duke University School of Medicine, Durham, North Carolina

#### AM 165 (1156)

##### **Ultra Low Cost & Minimally Stimulating Method of Relieving Airway Obstruction During MAC**

**Sapan Shah**, H.T. Lee

Columbia University Medical Center, New York, New York

#### CA 166 (1164)

##### **Acute Bleeding from an Aortic Pseudoaneurysm Due to Sneezing After Coronary Artery Bypass Grafting (CABG) Surgery**

**Sapan Shah**, Jacob Schaff

Columbia University Medical Center, New York, New York

#### MCC 167 (1140)

##### **Anesthetic Management of Quaternary C/S in a Patient with Diffuse, Destructive Malignant Metastatic Lesions**

**Sapan Shah**, Laurence Ring

Columbia University Medical Center, New York, New York

#### RA 168 (807)

##### **Report of Acute Delirium in a Healthy Patient with Rectus Sheath Catheters**

**Sapan Shah<sup>1</sup>**, Robert Maniker<sup>2</sup>

<sup>1</sup>Columbia University Medical Center, New York, New York; <sup>2</sup>Columbia University, New York, New York

#### RA 169 (907)

##### **Early Experience with 2-Chloroprocaine for Spinal Anesthesia: A Retrospective Analysis at One Institution**

**David Kim**, Richard Kahn, Andrew Lee, Sarah Ortolan, Jacques YaDeau, Phuong Dinh Mac

Hospital for Special Surgery, New York, New York



# Moderated Poster Discussion Session

## Friday, April 27, 2018 • 3:00 pm – 3:45 pm

### Group 3: Blood Management and Medically Challenging Cases

**Moderator: Aryeh Shander, MD, FCCM, FCCP,**  
Englewood Hospital and Medical Center, Englewood, New Jersey

#### **BLD 172 (921)**

##### **High Reliability Medicine in Transfusion: Intelligent Blood Management**

**Angela M. Johnson,** James L. Hill  
*University Hospitals Cleveland Medical Center, Cleveland, Ohio*

#### **MCC 173 (576)**

##### **Cecal Bascule After Cardiac Surgery**

**Angela M. Johnson,** Francis T. Lytle  
*University Hospitals Cleveland Medical Center, Cleveland, Ohio*

#### **BLD 174 (604)**

##### **Safety of Four Factor Prothrombin Complex Concentrates (4F-PCC) for the Reversal of Factor Xa Inhibitors**

**Jing Tao,** Elena Bukanova, Shamsuddin Akhtar  
*Yale University School of Medicine, New Haven, Connecticut*

#### **BLD 175 (838)**

##### **Contrasting Effects of Stored Allogeneic Red Blood Cells and Their Supernatants on Permeability and Inflammatory Responses by Human Pulmonary Artery Endothelial Cells**

**Junghyun Kim,** Trang Nguyen, Michael A. Mazzeffi, Kenichi Tanaka, Anna Birukova, Konstantin Birukov  
*University of Maryland School of Medicine, Baltimore, Maryland*

#### **BLD 176 (756)**

##### **Verification of Provider Indications for Red Blood Cell Transfusion Therapies: A Retrospective Cohort Study**

**Nathan T. Kor,** Todd Kor, Matthew Warner, Daryl J. Kor  
*Mayo Clinic, Rochester, Minnesota*

#### **BLD 177 (1042)**

##### **Impact of Reinforced, Strict Guidelines on the Usage of Packed Red Blood Cells (PRBC)**

**Theresa Kuhlmann,** Katharina-Stefanie Haeusler, Michael Booke  
*Hospital of Bad Soden, Bad Soden, Germany*

### Group 4: Cardiovascular Anesthesiology and Liver

**Moderator: Adam S. Evans, MD, MBA, FCCM,** Icahn School of Medicine at Mount Sinai, New York, New York

#### **CA 179 (1058)**

##### **Active Intrathoracic Pressure Regulation: A Novel Non-invasive Device to Improve Hemodynamics after Blood Loss in a Porcine Model of Hemorrhage**

**Anja Metzger<sup>1</sup>,** Paul Berger<sup>2</sup>, Michael Lick<sup>3</sup>, Keith Lurie<sup>1</sup>  
*<sup>1</sup>University of Minnesota, St. Paul, Minnesota; <sup>2</sup>Zoll Medical, St. Paul, Minnesota; <sup>3</sup>Minneapolis Medical Research Foundation, Minneapolis, Minnesota*

#### **CA 180 (924)**

##### **Fatigue and Dyspnea on Exertion in a Patient with Previous Aortic Valve Surgery**

**Chris Denny,** Charles Baysinger, Randall M. Schell  
*University of Kentucky, Lexington, Kentucky*

#### **CA 181 (1242)**

##### **Impact of Methylprednisolone on the Incidence of Postoperative Complications in Cardiac Surgery Patients**

**Felix Balzer,** Ralf F. Trauzeddel, Martin Ertmer, Torsten Geyer, Herko Grubitzsch, Sascha Treskatsch  
*The Charité – Universitätsmedizin Berlin, Berlin, Germany*

#### **CA 182 (936)**

##### **Variant Apolipoprotein L1 (APOL1) Alleles are Associated with Increased Risk of Post-Cardiac Surgery Acute Kidney Injury**

**Jamie Privratsky<sup>1</sup>,** Yi-Ju Li<sup>1</sup>, Carol Haynes<sup>1</sup>, Joseph P. Mathew<sup>2</sup>, Mihai Podgoreanu<sup>1</sup>, Svati Shah<sup>1</sup>, Mark Stafford-Smith<sup>2</sup>  
*<sup>1</sup>Duke University Medical Center, Durham, North Carolina; <sup>2</sup>Duke University School of Medicine, Durham, North Carolina*

#### **CA 183 (932)**

##### **Cardiac Output Monitoring: A Comparative Prospective Observational Study of the Conventional Cardiac Output Monitor and a New Smartphone Based Application**

**Shagun B. Shah<sup>1</sup>,** Ajay K. Bhargava<sup>1</sup>, Uma Hariharan<sup>2</sup>, Gayatri Vishvakarma<sup>1</sup>, Chamound R. Jain<sup>3</sup>, Anamika Kansal<sup>1</sup>  
*<sup>1</sup>Rajiv Gandhi Cancer Institute and Research Centre, Delhi, India; <sup>2</sup>Dr. Ram Manohar Lohia Hospital and Pgimer, Delhi, India*



**Group 4: Cardiovascular Anesthesiology and Liver, continued**

**L 184 (562)**

**Predicting Postoperative Liver Dysfunction Using Indocyanine Green Clearance After Cardiac Surgery**

Kaila Gordo<sup>1</sup>, Gebhard Wagener<sup>2</sup>

<sup>1</sup>Columbia University, New York, New York; <sup>2</sup>College of Physicians and Surgeons of Columbia University Medical Center, New York, New York

**Group 5: Bench Science, Critical Care, Medically Challenging Cases, and Obstetric Anesthesiology**

**Moderator: Raquel R. Bartz, MD, MMCI**, Duke University School of Medicine, Durham, North Carolina

**CC 185 (1102)**

**Characteristics and Outcomes of Oncologic ICU Admissions: Rapid Response Team versus Critical Care Medicine Consult Pathways**

German Echeverry, Jibrán Majeed, Yekaterina Tayban, Neil Halpern

Memorial Sloan Kettering Cancer Center, New York, New York

**CC 186 (1350)**

**Management of Toxicities Associated with Chimeric Antigen Receptor (CAR) T Cells in the ICU**

German Echeverry<sup>1</sup>, Elena Mead<sup>1</sup>, Amit A. Pandit<sup>2</sup>, Leon Chen<sup>1</sup>, Natalie Kostelecky<sup>1</sup>, Stephen Pastores<sup>1</sup>, Neil Halpern<sup>1</sup>

<sup>1</sup>Memorial Sloan Kettering Cancer Center, New York, New York; <sup>2</sup>University of Mississippi Medical Center, Jackson, Mississippi

**BS 187 (784)**

**Signaling in Vascular Endothelium by Varying Degrees of Mechanical Stretch**

Yunbo Ke, Chenou Zhang, Yue Li, Trang Nguyen, Pratap Karki, Konstantin Birukov, Anna Birukova

University of Maryland School of Medicine, Baltimore, Maryland

**CC 188 (1432)**

**Early Mechanical Circulatory Support Improves Outcomes in Idiopathic Myocarditis**

Vijal Patel<sup>1</sup>, Sajid Shahul<sup>2</sup>

<sup>1</sup>The University of Chicago Medicine, Chicago, Illinois; <sup>2</sup>University of Chicago Medical Center, Chicago, Illinois

**Group 5: Bench Science, Critical Care, Medically Challenging Cases, and Obstetric Anesthesiology, continued**

**OB 189 (1439)**

**New Onset Acute Heart Failure in the Postpartum Period: A 90-day National Readmissions Database Study**

Vijal Patel<sup>1</sup>, Atul Gupta<sup>1</sup>, Sajid Shahul<sup>2</sup>, Junaid Nizamuddin<sup>2</sup>, Mohammed Minhaj<sup>1</sup>, Sarosh Rana<sup>2</sup>

<sup>1</sup>The University of Chicago Medicine, Chicago, Illinois;

<sup>2</sup>University of Chicago Medical Center, Chicago, Illinois

**MCC 190 (1267)**

**Cardiovascular Collapse as the Initial Presentation of Catastrophic Antiphospholipid Syndrome**

Vijal Patel, Aalok K. Kacha

The University of Chicago Medicine, Chicago, Illinois

**Group 6: Critical Care**

**Moderator: Peter Von Homeyer, MD, FASE**, University of Washington, Seattle, Washington

**CC 192 (1258)**

**The Prognostic Value of Cardiac Power Output in Septic Patients**

Beliz Bilgili, Zuhail Aykac, Muserref Turker

Marmara University, School of Medicine, Istanbul, Turkey

**CC 193 (867)**

**Hyperacute Catheter-Associated Pulmonary Embolus in the Immediate Postoperative Period Following Spinal Surgery**

Ergit Paparisto, Daniel Donoho, Michael Kim, Kevin Blaine

Keck School of Medicine of University of Southern California, Los Angeles, California

**CC 195 (606)**

**Long-Term Outcomes Following Extracorporeal Life Support for Acute Respiratory Failure**

Michael D. McDonald<sup>1</sup>, Danielle K. Sandsmark<sup>1</sup>, Jessica Palakshappa<sup>2</sup>, Mark E. Mikkelsen<sup>1</sup>, Brian J. Anderson<sup>1</sup>, Jacob Gutsche<sup>1</sup>

<sup>1</sup>Perelman School of Medicine, University of Pennsylvania, Philadelphia, Pennsylvania; <sup>2</sup>Wake Forest School of Medicine, Winston-Salem, North Carolina

# Moderated Poster Discussion Session

## Friday, April 27, 2018 • 3:00 pm – 3:45 pm

### Group 6: Critical Care, continued

#### CC 196 (1329)

##### **Sepsis Upregulates HIF-1 Independent of Tissue Oxygenation**

**Robert Thiele**, Keita Ikeda, Hari Osuru, Zhiyi E. Zuo  
*University of Virginia, Charlottesville, Virginia*

#### CC 197 (1088)

##### **Focused Transthoracic Echocardiography and In-Hospital Cardiac Arrest: A Case Series of 10 Resident-Obtained Echocardiograms in the Peri-Resuscitative Period**

**Susan L. Herrick**, Nibras Bughrara, Kirti Sahu, Scott Groudine, Kevin Roberts  
*Albany Medical College, Albany, New York*

### Group 7: Critical Care

**Moderator: Shatish Bhagwanjee, MD**, University of Washington, Seattle, Washington

#### CC 199 (1279)

##### **Association of Angiotensin II Dose with All-Cause Mortality in Patients with Vasodilatory Shock**

**Ashish K. Khanna**<sup>1</sup>, Michael McCurdy<sup>2</sup>, David Boldt<sup>3</sup>, Kealy R. Ham<sup>4</sup>, Kenneth Krell<sup>5</sup>, Lakhmir S. Chawla<sup>6</sup>, George F. Tidmarsh<sup>6</sup>

<sup>1</sup>Cleveland Clinic Lerner College of Medicine, Cleveland, Ohio; <sup>2</sup>University of Maryland School of Medicine, Baltimore, Maryland; <sup>3</sup>University of California, Los Angeles, Los Angeles, California; <sup>4</sup>Regions Hospital, University of Minnesota; <sup>5</sup>Eastern Idaho Regional Medical Center, Idaho Falls, Idaho; <sup>6</sup>La Jolla Pharmaceutical Company, La Jolla, California

#### CC 200 (1285)

##### **Association between MAP and Mortality in Vasodilatory Shock at an Academic Medical Center**

**Ashish K. Khanna**<sup>1</sup>, Nathan Nielsen<sup>2</sup>, Feng Zeng<sup>3</sup>, Margaret Gerbas<sup>4</sup>, Gerry Oster<sup>4</sup>, Aaron Grossman<sup>4</sup>, Nathan Shapiro<sup>5</sup>

<sup>1</sup>Cleveland Clinic Lerner College of Medicine, Cleveland, Ohio; <sup>2</sup>Tulane University, New Orleans, Louisiana; <sup>3</sup>La Jolla Pharmaceutical Company, La Jolla, California; <sup>4</sup>Policy Analysis Inc, Bookline, Massachusetts; <sup>5</sup>Beth Israel Deaconess Medical Center; Harvard Medical School, Boston, Massachusetts

### Group 7: Critical Care, continued

#### CC 201 (668)

##### **Risks Associated With $\beta$ -Blocker Discontinuation After Cardiac Surgery**

**Emily Chanan**, Mark Nunnally, Germaine Cuff, Samir Kendale, Aubrey Galloway  
*New York University Langone Health, New York, New York*

#### CC 202 (685)

##### **Cost Reduction in ICU: Substitution of IV Levothyroxine with PO Levothyroxine**

**Gregory J. Mickus**, Praveen Chahar, Chiedozie Udeh, Sarah Welch  
*Cleveland Clinic, Cleveland, Ohio*

#### CC 203 (1091)

##### **Pilot Prospective Randomized Trial Comparing Methods of Teaching Point-of-Care Ultrasound Image Interpretation Skills to Medical Trainees**

**Alexander Reskallah**<sup>1</sup>, Quinton Quinones<sup>1</sup>, Yue Jiang<sup>2</sup>, Anna Lisa Crowley<sup>1</sup>, Erica Peethumnongsin<sup>1</sup>, Yuriy Bronshteyn<sup>1</sup>

<sup>1</sup>Duke University Medical Center, Durham, North Carolina; <sup>2</sup>University of North Carolina-Chapel Hill, Chapel Hill, North Carolina

#### CC 204 (914)

##### **Hydroxocobalamin for Treatment of Bacteria-Induced Vasoplegia: The Magic Bullet for Septic Shock?**

**Kelsey M. Walters**, Mary Schultz, David D. Gutterman, Christy Barrios, Rodney Willoughby, Julie K. Freed  
*Medical College of Wisconsin, Milwaukee, Wisconsin*

### Group 8: Critical Care

**Moderator: Joti J. Mucci, MD**, University Hospitals Cleveland Medical Center, Cleveland, Ohio

#### CC 206 (1404)

##### **Defining Familial Interactions and Networks (Define): An Exploratory Study on Family Networks and Surrogate Decision Making in the ICU**

**Meghan Lane-Fall**, Adam Adenwala  
*Perelman School of Medicine, University of Pennsylvania, Philadelphia, Pennsylvania*



**Group 8: Critical Care, continued**

**CC 207 (965)**

**Is all Chlorhexidine Bathing Equal? A Comparison of Skin Chlorhexidine Concentration and Bacterial Colonization After Different, Commonly Used, Methods of Chlorhexidine Bathing**

Louisa Palmer<sup>1</sup>, George Frenzl<sup>1,2</sup>

<sup>1</sup>Brigham and Women's Hospital, Boston, Massachusetts;

<sup>2</sup>Harvard Medical School, Boston, Massachusetts

**CC 208 (1394)**

**Utility of DIBI, a Novel Iron Chelator, as Therapeutic Modality for Murine Peritonitis-Induced Sepsis**

Maral Aali<sup>1</sup>, Taylor Thorburn<sup>1</sup>, Juan Zhou<sup>1</sup>, Kayle Dickson<sup>1</sup>, Noura Motabbakani<sup>1</sup>, Bruce Holbein<sup>2</sup>, Christian Lehmann<sup>1</sup>

<sup>1</sup>Dalhousie University, Halifax, Nova Scotia, Canada;

<sup>2</sup>Chelation Partners, Halifax, Nova Scotia, Canada

**CC 209 (1037)**

**Trends in the Use of Extracorporeal Membrane Oxygenation in the United States, 2011-2014: An Examination of State-Level Billing Data**

Michael Stentz<sup>1</sup>, Craig S. Jabaley<sup>2</sup>, Vanessa Moll<sup>1</sup>, James Blum<sup>2</sup>

<sup>1</sup>Emory University School of Medicine, Atlanta, Georgia;

<sup>2</sup>Emory University Hospital, Atlanta, Georgia

**CC 210 (701)**

**The Effect of Daily Fluid Balance on Mechanical Ventilation in Subarachnoid Hemorrhage**

Ognjen Katan<sup>1</sup>, Stephanie Mehr<sup>1</sup>, Yaping Shi<sup>2</sup>, Matthew Shotwell<sup>2</sup>, Avinash Kumar<sup>1</sup>

<sup>1</sup>Vanderbilt University Medical Center, Nashville, Tennessee;

<sup>2</sup>Vanderbilt University School of Medicine, Nashville, Tennessee

**CC 211 (723)**

**Does Real Time Ultrasonography During Bronchoscopy Guided Percutaneous Tracheostomy Confer Any Benefit: A Preliminary, Randomized Controlled Trial**

Richa Aggarwal, Kapil Soni

All India Institute of Medical Science, New Delhi, India

**Group 9: Critical Care**

**Moderator: Daryl Kor, MD**, Mayo Clinic, Rochester, Minnesota

**CC 213 (941)**

**Implementation of a Simulation-Based Training Program for ECMO Complications**

Sarah Burke, Brent Kidd, **Hemanckur Makker**, Matthew Wiepking, Mark Caridi-Scheible, Leon Eydelman

Emory University School of Medicine, Atlanta, Georgia

**CC 214 (532)**

**Replacing Albumin with Crystalloids for Postoperative Cardiac Surgery Fluid Resuscitation in the Intensive Care Unit – An Interprofessional Approach**

**Ryan J. Fink**<sup>1</sup>, Andrew Young<sup>2</sup>, N. David Yanez<sup>1</sup>, Miriam Treggiari<sup>1</sup>, Matthias Merkel<sup>1</sup>, Jennifer Mai<sup>1</sup>, Marissa Hom<sup>3</sup>

<sup>1</sup>Oregon Health and Science University, Portland, Oregon;

<sup>2</sup>Roque Valley Medical Center, Medford, Oregon; <sup>3</sup>University of California, San Francisco Medical Center, San Francisco, California

**CC 215 (715)**

**The Modified Early Warning System in Unplanned SICU Admission: An Analysis in 263 Consecutive Patients**

**Annandita Kumar**<sup>1</sup>, Hussam Ghabra<sup>1</sup>, Michael Townsend<sup>2</sup>, Fiona Winterbottom<sup>1</sup>, Phillip Boysen<sup>1</sup>, Bobby Nossaman<sup>1</sup>

<sup>1</sup>Ochsner Health System, New Orleans, Louisiana; <sup>2</sup>Ochsner Clinic Foundation, New Orleans, Louisiana

**CC 216 (1206)**

**Boarding of ICU Patients Does Not Impact Mortality in an Academic Health System**

Robert F. Groff<sup>1</sup>, Michael Stentz<sup>1</sup>, Craig S. Jabaley<sup>2</sup>, **James Blum**<sup>2</sup>, Milad Sharifpour<sup>1</sup>

<sup>1</sup>Emory University School of Medicine, Atlanta, Georgia;

<sup>2</sup>Emory University Hospital, Atlanta, Georgia

**CC 217 (718)**

**Cardiac Strain as a Measure of Myocardial Dysfunction After Subarachnoid Hemorrhage**

**Ari R. Tallen**<sup>1</sup>, Sajid Shahul<sup>2</sup>, Junaid Nizamuddin<sup>2</sup>, Ariel Mueller<sup>3</sup>, Avery Tung<sup>1</sup>

<sup>1</sup>The University of Chicago Medicine, Chicago, Illinois;

<sup>2</sup>University of Chicago Medical Center, Chicago, Illinois; <sup>3</sup>Beth Israel Deaconess Medical Center, Boston, Massachusetts



# Moderated Poster Discussion Session

## Friday, April 27, 2018 • 3:00 pm – 3:45 pm

### Group 10: Critical Care and Respiration

**Moderator: Roshni Sreedharan, MD,** Cleveland Clinic Foundation, Cleveland, Ohio

#### CC 219 (890)

##### **Neuroinvasive West Nile Virus Post Heart Transplantation**

**Erik Dong,** Kellie Morris, Rachel Zabner, Michael Nurok  
*Cedars-Sinai Medical Center, Los Angeles, California*

#### CC 220 (1034)

##### **Improving Quality of Care by Standardizing OR to Surgical ICU Handoffs**

**Megan D. Henley,** Emily G. Teeter, Peggy P. McNaull  
*University of North Carolina, Chapel Hill, North Carolina*

#### CC 221 (1089)

##### **The Nitric Oxide Pathway Antagonists in Septic Shock: Meta-Analysis of Controlled Clinical Trials**

**Javier Pascual-Ramirez,** Aristides Koutrouvelis, Himanshu A. Patel  
*The University of Texas Medical Branch, Galveston, Texas*

#### CC 222 (1182)

##### **Outcomes Within the First Three Years of a New Venovenous ECMO Program**

**Leon Eydelman<sup>1</sup>,** John A. Vullo<sup>2</sup>, Michael Stentz<sup>1</sup>, James Blum<sup>2</sup>, Michael Connor<sup>1</sup>

<sup>1</sup>Emory University School of Medicine, Atlanta, Georgia;

<sup>2</sup>Emory University Hospital, Atlanta, Georgia

#### CC 223 (1304)

##### **Arterio-enteric Fistula Following Pancreatic Surgery**

**Joshua A. Pastor,** Joti J. Mucci  
*University Hospitals Cleveland Medical Center, Cleveland, Ohio*

#### RES 224 (686)

##### **Current Oxygen Management in the Operating Room: A Retrospective Chart Review**

**Joanna Olsen,** Stephanie Nonas  
*Oregon Health and Science University, Portland, Oregon*

### Group 11: Critical Care and Technology, Computing and Simulation, Equipment Monitoring

**Moderator: Praveen Chahar, MD, FCARCSI,** Cleveland Clinic, Cleveland, Ohio

#### CC 226 (734)

##### **Successful Treatment of Post-Myocardial Infarction Hiccups with Dexmedetomidine**

**Lynden Baesch,** Julie E. Herzog, Francis T. Lytle  
*University Hospitals Cleveland Medical Center, Cleveland, Ohio*

#### CC 227 (751)

##### **Post Operative Hypoxic: A Unique Case of Thoracotomy Complicated by Platypnoea-Orthodeoxia Syndrome**

**Ashley N. Taylor,** Mary Jarzebowski  
*Henry Ford Health System, Detroit, Michigan*

#### TCSEM 229 (697)

##### **The Simulation Wars: A Competition to Increase Participation in Emergency Manuals Simulation Training and a Novel Tool for Rating Simulation Competitions**

**Khoa Nguyen,** Jeffrey Huang  
*University of Central Florida, Orlando, Florida*

#### TCSEM 230 (1126)

##### **Virtual Reality Use in Adult ICU to Mitigate Anxiety for a Patient on V-V ECMO: A Feasibility Trial**

**Gregory J. Blair<sup>1</sup>,** Sheela Pai Cole<sup>1</sup>, Sam Rodriguez<sup>2</sup>  
<sup>1</sup>Stanford Hospital, Stanford, California; <sup>2</sup>Lucile Packard Children's Hospital; Stanford Hospital, Stanford, California

#### TCSEM 231 (1331)

##### **Inter-professional Simulation-based Education in Critical Care Medicine**

**Meghan Brennan,** Isaac Luria, Chris Giordano, Peggy White  
*University of Florida, Gainesville, Florida*



**Group 12: Blood Management and Technology,  
Computing and Simulation, Equipment Monitoring**

**Moderator: Piyush Mathur, MD**, Cleveland Clinic,  
Cleveland, Ohio

**TCSEM 233 (528)**

**Feasibility of Using a Remote Monitoring Technology to  
Build a Consultative Critical Care Service for High Risk  
Non-ICU Surgical Patients**

**Kyan C. Safavi**<sup>1</sup>, William Driscoll<sup>2</sup>, Milcho Nikolov<sup>2</sup>, Kalpan  
Tolia<sup>2</sup>, Gopi Gogada<sup>2</sup>, Sunil Eappen<sup>3</sup>, Kevin K. Tremper<sup>4</sup>,  
Jeanine P. Wiener-Kronish<sup>2</sup>

<sup>1</sup>Massachusetts General Hospital, Harvard Medical School,  
Boston, Massachusetts; <sup>2</sup>Massachusetts General Hospital,  
Boston, Massachusetts; <sup>3</sup>Massachusetts Eye and Ear  
Infirmary, Boston, Massachusetts; <sup>4</sup>University of Michigan  
Medicine, Ann Arbor, Michigan

**TCSEM 234 (713)**

**Comparisons of the Endobronchial Segment of Left-  
Sided Double-Lumen Tubes**

**Zen'ichiro Wajima**<sup>1</sup>, Kazuyuki Imanaga<sup>2</sup>, Toshiya Shiga<sup>3</sup>,  
Takahisa Nishiyama<sup>1</sup>, Hiroyuki Uchino<sup>1</sup>

<sup>1</sup>Tokyo Medical University, Tate-machi, Tokyo, Japan;  
<sup>2</sup>Shonan Kamakura General Hospital, Kamakura, Kanagawa;  
<sup>3</sup>International University of Health and Welfare, Narita-shi,  
Chiba

**TCSEM 235 (743)**

**Efficacy of Bispectral Index in Reducing Intraoperative  
Awareness: A Meta-Analysis of Randomized Controlled  
Studies**

**Thomas Cheriyan**<sup>1</sup>, Kevin Bai<sup>1</sup>, Anterpreet Dua<sup>1</sup>, Vikas  
Kumar<sup>2</sup>

<sup>1</sup>Augusta University Medical Center, Augusta, Georgia;  
<sup>2</sup>Augusta University, Augusta, Georgia

**BLD 236 (1199)**

**Efficacy of Intraoperative Cell Salvage in Spine Surgery:  
A Meta-analysis**

**Thomas Cheriyan**<sup>1</sup>, Thomas Errico<sup>2</sup>, Anterpreet Dua<sup>1</sup>, Vikas  
Kumar<sup>1</sup>

<sup>1</sup>Augusta University Medical Center, Augusta, Georgia;  
<sup>2</sup>New York University-Hospital for Joint Diseases, New York,  
New York

**Group 12: Blood Management and Technology,  
Computing and Simulation, Equipment Monitoring,  
continued**

**TCSEM 237 (1181)**

**Perioperative Central Volume Status in Healthy Children  
and in Children with Congenital Heart Disease**

**David Leopold**<sup>1</sup>, Kristen Campbell<sup>2</sup>, Laura Pyle<sup>2</sup>, Richard  
Ing<sup>1,2</sup>, Jane Mulligan<sup>1</sup>, Mark Twite<sup>1,2</sup>, Steven Moulton<sup>1,2,3</sup>

<sup>1</sup>Children's Hospital Colorado, Aurora, Colorado; <sup>2</sup>University  
of Colorado School of Medicine, Aurora, Colorado;  
<sup>3</sup>Flashback Technologies, Inc., Louisville, Colorado

**TCSEM 238 (1365)**

**Joint Modeling and the Compensatory Reserve Index:  
Insight into Hemodynamic Compensation During the  
Induction of General Anesthesia**

**David Leopold**<sup>1</sup>, Kristen Campbell<sup>2</sup>, Laura Pyle<sup>2</sup>, Richard  
Ing<sup>1</sup>, Jane Mulligan<sup>3</sup>, Mark Twite<sup>1,2</sup>, Steven Moulton<sup>1,2,3</sup>

<sup>1</sup>Children's Hospital Colorado, Aurora, Colorado; <sup>2</sup>University  
of Colorado School of Medicine, Aurora, Colorado;  
<sup>3</sup>Flashback Technologies, Inc., Louisville, Colorado

**Group 13: Critical Care and Trauma**

**Moderator: Francis DiPierro, MD**, Cleveland Clinic,  
Cleveland, Ohio

**CC 240 (1043)**

**Improving Multi-disciplinary Sign-out Upon Discharge  
from the SICU**

**Islaam Elnagar**, Joanna Breneman  
Cleveland Clinic, Cleveland, Ohio

**CC 241 (1387)**

**VV ECMO and Mycoplasma Pneumoniae Pneumonia**

**Katherine E. Hornack**, Francis T. Lytle  
University Hospitals Cleveland Medical Center, Cleveland,  
Ohio

**T 242 (590)**

**Severe Hemorrhagic Shock is Associated with Reduced  
TEG Maximum Amplitude in Human Traumatic Injury**

**Michael W. Russell**<sup>1</sup>, Jennifer Knapp<sup>1</sup>, Gregory Schaefer<sup>1</sup>,  
Katherin Sproul<sup>1</sup>, Marcus R. Bruce<sup>1</sup>, Eugenie Jackson<sup>2</sup>,  
Michael Regier<sup>2</sup>

<sup>1</sup>West Virginia University School of Medicine, Morgantown,  
West Virginia; <sup>2</sup>West Virginia University School of Public  
Health, Morgantown, West Virginia



# Moderated Poster Discussion Session

Friday, April 27, 2018 • 3:00 pm – 3:45 pm

## Group 13: Critical Care and Trauma, continued

### T 243 (937)

#### **Cervical Spine Clearance in Patients with Unreliable Clinical Exam: Delays and Complications**

**Josefine S. Baekgaard**<sup>1</sup>, Trine G. Eskesen<sup>1</sup>, Jacob Steinmetz<sup>1</sup>, Lars S. Rasmussen<sup>1</sup>, David King<sup>2</sup>, George C. Velmahos<sup>2</sup>

<sup>1</sup>Rigshospitalet, Copenhagen, Copenhagen; <sup>2</sup>Massachusetts General Hospital, Boston, Massachusetts

### T 244 (944)

#### **Supplemental Oxygen for Trauma Patients – Current Practice in Two Trauma Centers**

**Trine G. Eskesen**<sup>1</sup>, Josefine S. Baekgaard<sup>1</sup>, Rasmus E. Christensen<sup>1</sup>, Jae Moo Lee<sup>2</sup>, George C. Velmahos<sup>2</sup>, Jacob Steinmetz<sup>1</sup>, Lars S. Rasmussen<sup>1</sup>

<sup>1</sup>Rigshospitalet, Copenhagen, Denmark; <sup>2</sup>Massachusetts General Hospital, Boston, Massachusetts

### T 245 (1330)

#### **Pre-Hospital Vital Signs Thresholds for Prediction of Emergency Blood Transfusion in < 55 year Old versus Older Trauma Patients**

**Peter F. Hu**, Yao Li, Colin Mackenzie, Shiming Yang, Catriona Miller, Peter Rock

University of Maryland School of Medicine, Baltimore, Maryland

## Group 14: Medically Challenging Cases, Metabolism and Perioperative Care, Obesity, and Obstetric Anesthesiology

**Moderator: Madiha Syed, MD**, Cleveland Clinic, Cleveland, Ohio

### MPC 248 (650)

#### **Acute Adrenal Insufficiency After Anti-emetic Dose of Dexamethasone**

**Andres Bacigalupo Landa**, Jayanand D'Mello

Mount Sinai Medical Center, Miami Beach, Florida

### MPC 249 (786)

#### **The Effects of Major Hepatobiliary Surgery and General Anesthesia on Skeletal Muscle Mitochondrial Respiration: A Pilot Study**

**Jia Liu Stevens**<sup>1</sup>, Daniel Martin<sup>1</sup>, Helen McKenna<sup>1</sup>, Andrew Murray<sup>2</sup>, Gavin Jell<sup>1</sup>

<sup>1</sup>University College London, London, England; <sup>2</sup>Univeristy of Cambridge, Cambridge, England

## Group 14: Medically Challenging Cases, Metabolism and Perioperative Care, Obesity, and Obstetric Anesthesiology, continued

### O 250 (835)

#### **Paternal BMI Affects Neonatal Weight: A Retrospective Study**

**Danielle Levin**, Shaul Cohen, Scott Mellender, Rong Zhao, Adil Mohiuddin, Ushma Shah, Geza Kiss

Rutgers – Robert Wood Johnson Medical School, New Brunswick, New Jersey

### MCC 251 (839)

#### **Successful Anesthetic Management of a Patient with Multiple Trauma and Severe Hypothermia: A Case Report**

**Danielle Levin**, Shaul Cohen, Scott Mellender, Preet Patel, Adil Mohiuddin, Ushma Shah, Geza Kiss

Rutgers – Robert Wood Johnson Medical School, New Brunswick, New Jersey

### OB 252 (753)

#### **Transcutaneous P6 Acupoint Electrical Stimulation Prevents Both Nausea and Vomiting During Elective Cesarean Section Under Combined Spinal-Epidural, a Randomized Control Clinical Trial**

**Danielle Levin**, Shaul Cohen, Scott Mellender, Adil Mohiuddin, Rong Zhao, Geza Kiss, Enrique Pantin

Rutgers – Robert Wood Johnson Medical School, New Brunswick, New Jersey

### OB 253 (799)

#### **Does the Application of Scopolamine Patch with Intra-operative Acupressure Point P6 Stimulation Increase Parturients' Intra-Cesarean Satisfaction? Prospective Randomized Clinical Trial**

**Danielle Levin**, Shaul Cohen, Scott Mellender, Adil Mohiuddin, Ushma Shah, Rong Zhao, Geza Kiss

Rutgers – Robert Wood Johnson Medical School, New Brunswick, New Jersey

# Moderated Poster Discussion Session

## Friday, April 27, 2018 • 3:00 pm – 3:45 pm



### Group 15: Geriatric Anesthesia and Pediatric Anesthesiology

**Moderator: Ronald Pauldine, MD**, University of Washington, Seattle, Washington

#### GA 255 (558)

##### **Long-term Caregiving is Associated with Impaired Cardiovascular Baroreflex – Implications on Anesthesia Care**

**Kevin K. Wu<sup>1</sup>**, Taylor Bos<sup>2</sup>, Brent Mausbach<sup>2</sup>, Igor Grant<sup>2</sup>  
<sup>1</sup>Frank H. Netter MD School of Medicine at Quinnipiac University, Hamden, Connecticut; <sup>2</sup>San Diego State University; University of California, San Diego School of Medicine, San Diego, California

#### GA 256 (1344)

##### **Cognitive and Physical Exercise Prehabilitation to Improve Outcomes in Surgical Patients**

**Kimberly Rengel<sup>1</sup>**, Nitin Mehdiratta<sup>2</sup>, Susan Vanston<sup>1</sup>, Kristin Swygart<sup>1</sup>, Jim Jackson<sup>3</sup>, Pratik Pandharipande<sup>1</sup>, Christopher G. Hughes<sup>1</sup>

<sup>1</sup>Vanderbilt University Medical Center, Nashville, Tennessee; <sup>2</sup>Duke University, Durham, North Carolina; <sup>3</sup>Vanderbilt University School of Medicine, Nashville, Tennessee

#### PED 257 (548)

##### **Perioperative Outcomes and Management in LeFort III Midface Advancement Surgery: A Multicenter Study from the Pediatric Craniofacial Collaborative Group**

**Chris D. Glover<sup>1</sup>**, Allison M. Fernandez<sup>2</sup>, Henry Huang<sup>1</sup>, Nicholas M. Dalesio<sup>3</sup>, John Zhong<sup>4</sup>, Wendy Binstock<sup>5</sup>, Paul A. Stricker<sup>6</sup>

<sup>1</sup>Baylor College of Medicine, Houston, Texas; <sup>2</sup>Johns Hopkins All Children's Hospital, St. Petersburg, Florida; <sup>3</sup>Johns Hopkins University, Baltimore, Maryland; <sup>4</sup>Children's Medical Center, Dallas, Texas; <sup>5</sup>University of Chicago, Chicago, Illinois; <sup>6</sup>The Children's Hospital of Philadelphia; Perelman School of Medicine at the University of Pennsylvania, Philadelphia, Pennsylvania

#### PED 259 (845)

##### **Comparison of Endotracheal Intubation vs. Natural Airway During Endoscopic Foreign Body Removal**

**Jacquelin Peck**, Aditi Dey, Sorany Son, Sharon Ghazarian, Michael Wilsey, Mohamed Rehman  
Johns Hopkins All Children's Hospital, St. Petersburg, Florida

### Group 15: Geriatric Anesthesia and Pediatric Anesthesiology, continued

#### PED 260 (847)

##### **Comparison of Endotracheal Intubation vs. Natural Airway During Initial Percutaneous Endoscopic Gastrostomy Insertion**

**Jacquelin Peck**, Aditi Dey, Sorany Son, Ernest Amankwah, Anthony H. Nguyen, Michael Wilsey, Mohamed Rehman  
Johns Hopkins All Children's Hospital, St. Petersburg, Florida

### Group 16: Economics, Education and Policy, Global Health, and Patient Safety

**Moderator: Peter Boysen, MD, MBA**, University of Queensland/Ochsner Clinical School, Brisbane, Australia

#### EEP 262 (508)

##### **Academic Contributions of United States Anesthesiologists to Critical Care Medicine**

**Jesse J. Kiefer<sup>1</sup>**, Michael A. Mazzeffi<sup>2</sup>, Samuel Galvagno<sup>2</sup>, Alexander Cartron<sup>2</sup>

<sup>1</sup>Hospital of the University of Pennsylvania, Philadelphia, Pennsylvania; <sup>2</sup>University of Maryland School of Medicine, Baltimore, Maryland

#### EEP 263 (700)

##### **Perspective on Leadership and Millennial Physicians**

**Marianne H. Gelter<sup>1</sup>**, Phillip Boysen<sup>2</sup>

<sup>1</sup>Ochsner Clinic Foundation, New Orleans, Louisiana; <sup>2</sup>University of Queensland Ochsner Clinical School, New Orleans, Louisiana

#### GH 264 (1289)

##### **A Study Examining Antimicrobial Resistance and Consumption Trends Using DRI**

**Bishnu P. Panigrahi**

Fortis Healthcare, Faridabad, Haryana, India

#### PS 265 (958)

##### **Disruptive Intraoperative Behavior: Reporting to Management and Satisfaction with Management's Response**

**Ian Fast<sup>1</sup>**, Alexander Villafranca<sup>1</sup>, Bernadette Henrichs<sup>2</sup>, Kirby Magid<sup>1</sup>, Chris Christodoulou<sup>1</sup>, Eric Jacobsohn<sup>1</sup>

<sup>1</sup>University of Manitoba, Winnipeg, Manitoba, Canada; <sup>2</sup>Washington University, St. Louis, Missouri



# Moderated Poster Discussion Session

## Friday, April 27, 2018 • 3:00 pm – 3:45 pm

### Group 16: Economics, Education and Policy, Global Health, and Patient Safety, continued

**PS 266 (960)**

#### **Implementing a Standardized Sign-out Process in Cardiovascular ICU**

Monica I. Lupei<sup>1</sup>, Belinda Lee<sup>1</sup>, **Nishkruti Munshi<sup>1</sup>**, Alexander M. Kaizer<sup>2</sup>, Joyce Wahr<sup>1</sup>

<sup>1</sup>University of Minnesota, St. Paul, Minnesota; <sup>2</sup>University of Colorado, Denver, Colorado

**PS 267 (1284)**

#### **Supraclavicular Brachial Plexus Block Analgesia With or Without Perineural Dexamethasone for Creation of Arteriovenous Fistula in End-Stage Renal Disease Patients**

**Indu M. Sen**, Aparna Pande, Ashish Sharma

Postgraduate Institute of Medical Education and Research, Chandigarh, India

### Group 17: Medically Challenging Cases

**Moderator: Breandan Sullivan, MD**, University of Colorado School of Medicine, Aurora, Colorado

**MCC 269 (488)**

#### **Fatal Exertional Rhabdomyolysis: A Devastating Complication of Sickle Cell Trait and Drastic Weight Cutting**

**Kadhiresan R. Murugappan**, Akiva Leibowitz  
Beth Israel Deaconess Medical Center, Boston, Massachusetts

**MCC 270 (489)**

#### **Toxic Flowers and Aconite Poisoning: A Case of Critical Illness after Chinese Herbal Tea**

**Michael J. Jung<sup>1</sup>**, Ahmed M. Shalabi<sup>2</sup>, Manuel Pardo<sup>2</sup>

<sup>1</sup>University of California, San Francisco Medical Center, San Francisco, California; <sup>2</sup>University of California, San Francisco School of Medicine, San Francisco, California

**MCC 271 (505)**

#### **Intraoperative Placement of Prone Femoral Central Venous Catheter in a Patient with Hemorrhagic Cerebral Arteriovenous Malformation**

**Zuhair Siddiqui<sup>1</sup>**, Julia B. Sobol<sup>1,2</sup>, Yefim Vilnits<sup>1</sup>

<sup>1</sup>Columbia University, New York, New York; <sup>2</sup>New York-Presbyterian Hospital, New York, New York

### Group 17: Medically Challenging Cases, continued

**MCC 272 (522)**

#### **Rhabdomyolysis After Robotic Nephrectomy**

**Kelsey J. Corle**, Francis T. Lytle

University Hospitals Cleveland Medical Center, Cleveland, Ohio

**MCC 273 (529)**

#### **A Novel Association of Juvenile Polyposis Syndrome with Atrial Septal Aneurysm and Patent Foramen Ovale**

Melanio Bruceta, Luisa M. De Souza, **Kunal Karamchandani**, Anthony Bonavia, Ziad Carr

Penn State Milton S. Hershey Medical Center, Hershey, Pennsylvania

**MCC 274 (552)**

#### **Perioperative Management of Orthotopic Liver Transplant for Intrahepatic Cholestasis in Sickle Cell Disease**

**Sarah Burke**, Katherine Nugent

Emory University School of Medicine, Atlanta, Georgia

### Group 18: Medically Challenging Cases

**Moderator: Avneep Aggarwal, MD**, Cleveland Clinic, Cleveland, Ohio

**MCC 276 (568)**

#### **Management Considerations in a Patient with Repeated Posterior Circulation Strokes Refractory to Medical Therapy**

**Tao Shen**, Judy H. Ch'ang, Jeffrey Gotts

University of California, San Francisco School of Medicine, San Francisco, California

**MCC 277 (595)**

#### **Challenges in Management of Clostridium Difficile Infection in a Patient with Durable Left Ventricular Assist Device**

**Naila Mammadova**, Kimberly S. Robbins

University of California, San Diego School of Medicine, San Diego, California

**MCC 278 (624)**

#### **Postoperative STEMI in a Critically Ill Patient**

**Lucille Brunker**, Liza M. Weavind

Vanderbilt University Medical Center, Nashville, Tennessee



**Group 18: Medically Challenging Cases, continued**

**MCC 279 (630)**

**Complications Following Lumbar Drain Placement For Thoracic/Thoracoabdominal Aortic Aneurysm Repair: Two Case Reports and Literature Review**

**Matthew G. Broyles**, Weifeng Song, Benjamin Tuck, Michelle Downing, Thomas Moore, David Miller  
*University of Alabama at Birmingham, Birmingham, Alabama*

**MCC 280 (635)**

**Subclavian Steal Phenomenon Following TEVAR for an Aorto-bronchial Fistula in a Patient with Situs Inversus**

**Harikesh Subramanian**, Mary Jarzebowski  
*Henry Ford Health System, Detroit, Michigan*

**Group 19: Medically Challenging Cases**

**Moderator: George Frendl, MD, PhD, FCCM**, Brigham and Women's Hospital; Harvard Medical School, Boston, Massachusetts

**MCC 282 (637)**

**PICC Line Challenge**

**Pavel Balduyeu**, Laurie Davies  
*University of Florida, Gainesville, Florida*

**MCC 283 (642)**

**IVC Tumor Thrombectomy Complicated by Air Embolism; ECMO Salvage**

**Eric R. Leiendecker<sup>1</sup>**, Dawn Durre<sup>2</sup>, Micah Long<sup>2</sup>, Douglas Coursin<sup>2</sup>  
<sup>1</sup>*University of Wisconsin Hospital and Clinics, Madison, Wisconsin*; <sup>2</sup>*University of Wisconsin, Madison, Wisconsin*

**MCC 284 (648)**

**Management of Hypoxia During Centrally Cannulated VA ECMO**

**Brent Kidd**, Michael Stentz  
*Emory University School of Medicine, Atlanta, Georgia*

**MCC 285 (653)**

**Massive Hepatic Hematoma Caused by HELLP Syndrome**

**Theresa J. Barnes**, Avneep Aggarwal  
*Cleveland Clinic Foundation, Cleveland, Ohio*

**Group 19: Medically Challenging Cases, continued**

**MCC 286 (862)**

**Hemophagocytic Lymphohistiocytosis – A Diagnostic Conundrum**

**Theresa J. Barnes**, Faith N. Factora, Avneep Aggarwal  
*Cleveland Clinic Foundation, Cleveland, Ohio*

**MCC 287 (671)**

**Chronic Skull Base Erosion from Temporomandibular Joint Disease Causes Generalized Seizure and Profound Lactic Acidosis**

**Mark A. Dobish**, David Wyler, Hermandeep Dhami, Victor Romo, Christopher Farrell, Michael Mahla  
*Thomas Jefferson University Hospital, Philadelphia, Pennsylvania*

**Group 20: Medically Challenging Cases**

**Moderator: Navneet Grewal, MD**, University of Texas, Houston, Texas

**MCC 289 (674)**

**When the Pulmonary Embolus From Outside Hospital Isn't Really a Pulmonary Embolus: Point-of-Care Echocardiographic Detection of Severe Cardiomyopathy**

**James Harris**, Daniel Johnson  
*University of Nebraska Medical Center, Omaha, Nebraska*

**MCC 290 (675)**

**Perioperative Heart Failure in a Young Woman: A Case of Non-compaction Cardiomyopathy**

**Tina Law**, Madiha Syed  
*Cleveland Clinic Foundation, Cleveland, Ohio*

**MCC 291 (1379)**

**ICU Management After Rescue Hepatectomy for Primary Allograft Non-function**

**Tina Law**, David R. Jury  
*Cleveland Clinic Foundation, Cleveland, Ohio*

**MCC 292 (678)**

**Labile Factor VIII Activity in a Patient with Hemophilia A Undergoing On-Pump Coronary Artery Bypass Grafting**

**Kristin Wakin**, Archana Ramesh, Ellen Roberts, James Sullivan  
*University of Nebraska Medical Center, Omaha, Nebraska*



# Moderated Poster Discussion Session

Friday, April 27, 2018 • 3:00 pm – 3:45 pm

## Group 20: Medically Challenging Cases, continued

### MCC 294 (683)

#### **A Case Report: Acute, Benign Superior Vena Cava Syndrome: Is it Critical?**

**Connor McNamara**, Joanna M. Brennehan, Hoang Lim, Roshni Sreedharan

*The Cleveland Clinic Foundation, Cleveland, Ohio*

## Group 21: Medically Challenging Cases

**Moderator: Erin Hennessey, MD**, Stanford University Medical Center, Stanford, California

### MCC 296 (687)

#### **Cardiac Tamponade Following Orthotopic Liver Transplantation: Two Case Reports**

**Caroline R. Gross**, Peter Downey, Julia Sobol

*Columbia University/New York-Presbyterian Hospital, New York, New York*

### MCC 297 (693)

#### **Right Sided Pneumothorax Resulting in ST-segment Depression After Coronary Artery Bypass Grafting Surgery**

**Habib Srour**, Matthew Firestone

*University of Kentucky, Lexington, Kentucky*

### MCC 298 (698)

#### **Severe Streptococcal Necrotizing Fasciitis Treated with Intravenous Immunoglobulin Therapy in the Intensive Care Unit**

**Ashley R. Dahl**, Thomas M. Stewart

*Mayo Clinic Rochester, Rochester, Minnesota*

### MCC 299 (704)

#### **Not All Effusions Need Drainage at 2 AM: Point-of-Care Echocardiography to Prevent Unnecessary Emergency Pericardiocentesis**

**Danielle C. Cummins**, Daniel Johnson

*University of Nebraska Medical Center, Omaha, Nebraska*

## Group 21: Medically Challenging Cases, continued

### MCC 300 (732)

#### **Pneumothorax versus Rapidly Expanding Bulla Following Mechanical Ventilation in a Patient with Loeys-Dietz Syndrome: A Case Report**

**Samantha Go**, Mallori Jirikovic, Ryan J. Fink

*Oregon Health and Science University, Portland, Oregon*

### MCC 301 (788)

#### **Successful Management of Severe Inhalation Injury Secondary to Sulfuric Acid with Venovenous Extracorporeal Membrane Oxygenation**

**Hemanckur Makker**<sup>1</sup>, Craig S. Jabaley<sup>2</sup>

<sup>1</sup>Emory University School of Medicine, Atlanta, Georgia;

<sup>2</sup>Emory University Hospital, Atlanta, Georgia

## Group 22: Medically Challenging Cases

**Moderator: Jose Humanez, MD**, University of Alabama at Birmingham Hospital, Birmingham, Alabama

### MCC 303 (792)

#### **How Findings on Transesophageal Echocardiography Can Change the Surgical Approach for Management of a Pericardial Effusion from Penetrating Chest Trauma**

**Patrick J. Coleman**, Matthew D. Read

*San Antonio Military Medical Center, San Antonio, Texas*

### MCC 304 (797)

#### **Utilization of Venovenous Extracorporeal Membrane Oxygenation in Acute Massive Pulmonary Embolism: A Case Report**

**Jonathan Tang**, S. V. Satyapriya, Amar M. Bhatt

*Ohio State University Wexner Medical Center, Columbus, Ohio*

### MCC 305 (804)

#### **Boating Accident Resulting in Polytrauma Requiring Double Lumen Tube Placement with Two Ventilator Strategy**

**Jeremy Rainey**, Hess Robertson

*University of Mississippi Medical Center, Jackson, Mississippi*



**Group 22: Medically Challenging Cases, continued**

**MCC 306 (828)**

**Development of Meningitis After Severe Head Trauma Treated with a Course of Prophylactic Antibiotics**

**Shanterian Hester**, Philip Smith

*Jackson Memorial Hospital – University of Miami Health System, Miami, Florida*

**MCC 307 (831)**

**Placement of a Dialysis Catheter Leading to Lethal Cardiac Tamponade**

**Jenna Zauk**<sup>1</sup>, Thomas J. Papadimos<sup>2</sup>

*<sup>1</sup>University of Toledo Medical Center, Toledo, Ohio; <sup>2</sup>The University of Toledo College of Medicine and Life Sciences, Toledo, Ohio*

**Group 23: Medically Challenging Cases**

**Moderator: Sean Josephs, MD**, College of Medicine  
*University of Cincinnati, Cincinnati, Ohio*

**MCC 309 (855)**

**Penetrating Atherosclerotic Ulcer of the Ascending Aorta: A Case Report**

**Yen K. Chau**<sup>1</sup>, Jose Humanez<sup>2</sup>

*<sup>1</sup>University of Alabama, Birmingham, Alabama; <sup>2</sup>University of Alabama at Birmingham Hospital, Birmingham, Alabama*

**MCC 310 (860)**

**Extensive Necrotizing Soft Tissue Infection Resulting in Pulmonary Air Embolism and Cardiac Arrest**

**Lakshmi C. Penugonda**, Navneet Grewa

*University of Texas, Houston, Houston, Texas*

**MCC 311 (889)**

**Thromboelastography (TEG)-guided Hemodynamic Resuscitation in a Patient with Severe Hemorrhagic Coagulopathy with Acquired Hemophagocytic Lymphohistiocytosis Related to Epstein-Barr Virus**

**Megan Hedlund**, Daniel Johnson

*University of Nebraska Medical Center, Omaha, Nebraska*

**Group 23: Medically Challenging Cases, continued**

**MCC 312 (673)**

**Right Ventricular Assist Device Placement For Acute Right Ventricular Failure After Heart Transplantation: Echocardiographic Guidance Throughout the Perioperative Process**

**Megan Hedlund**, Daniel Johnson

*University of Nebraska Medical Center, Omaha, Nebraska*

**MCC 313 (892)**

**Case Report: Pre and Perioperative Considerations in a Patient with Cold Temperature-induced Anaphylaxis and recently diagnosed Hereditary Angioedema**

**Allen Saks**<sup>1</sup>, Michelle Kars<sup>2</sup>

*<sup>1</sup>Donald and Barbara Zucker School of Medicine at Hofstra, Lake Success, New York; <sup>2</sup>Northwell Health System, New Hyde Park, New York*

**MCC 314 (895)**

**Critical Care Genetics: A Case of Severe Hyperammonemia Due to an Adult-Onset Urea Cycle Disorder**

**Shawn Jia**, Vincent Auyeung, Jon M. Aldrich

*University of California, San Francisco School of Medicine, San Francisco, California*

**Group 24: Medically Challenging Cases**

**Moderator: Jayanta Mukherji, MD**, Loyola University  
*Medical Center, Maywood, Illinois*

**MCC 316 (900)**

**Treatment of Eosinophilic Myocarditis with Extracorporeal Membrane Oxygenation: A Case Report**

**Nicholas Tooley**<sup>1</sup>, Matthew Armstrong<sup>2</sup>

*<sup>1</sup>Michigan State University College of Human Medicine, Grand Rapids, Michigan; <sup>2</sup>Anesthesiology and Critical Care Anesthesia Practice Consultants, PC, Grand Rapids, Michigan*

**MCC 317 (922)**

**Using a Novel Protocol to Standardize Weaning from Venovenous Extracorporeal Membranous Oxygenation (VV ECMO), A Case Report**

**Jordan Siscel**, David Douin, Thomas Scupp, William K. Cornwell, Christopher Pierce, Breandan Sullivan

*University of Colorado Denver School of Medicine, Denver, Colorado*

# Moderated Poster Discussion Session

## Friday, April 27, 2018 • 3:00 pm – 3:45 pm

### Group 24: Medically Challenging Cases, continued

#### MCC 318 (925)

##### Successful Treatment of Recurrent Chronic Scrotal Pain Secondary to Post Laminectomy Syndrome with Spinal Cord Stimulation

**Matthew M. Skoblar**, Brian Monroe, Ahmed Shaik  
*Geisinger Medical Center, Danville, Pennsylvania*

#### MCC 319 (927)

##### Diagnosis and Management of Subclavian-Esophageal Fistula

**Daniel Diaczok**, James L. Hill  
*University Hospitals Cleveland Medical Center, Cleveland, Ohio*

#### MCC 320 (930)

##### Prone Positioning and VV ECMO for Severe ARDS Due to Wegener's Pulmonary Granulomatosis

**Francesco Caporusso**, Emily T. Poynton, Joti J. Mucci  
*University Hospitals Cleveland Medical Center, Cleveland, Ohio*

### Group 25: Medically Challenging Cases

**Moderator: Nicholas Sadovnikoff, MD**, Brigham and Women's Hospital, Boston, Massachusetts

#### MCC 322 (934)

##### Hemodynamic Instability in Late Pericardial Tamponade Post LVAD Placement: A Case Report

**Elio Beta**, Vikram Bajwas, Shahriar Shayan  
*McGaw Medical Center of Northwestern University, Chicago, Illinois*

#### MCC 323 (948)

##### An Unexpected Infection: A Case of Neurobrucellosis

**Benjamin T. Kor**<sup>1</sup>, Daniel Ermann<sup>2</sup>, Rouhin Sen<sup>2</sup>, Renuga Vivekanandan<sup>2</sup>  
<sup>1</sup>Creighton University School of Medicine, Omaha, Nebraska;  
<sup>2</sup>Creighton University Bergan Mercy, Omaha, Nebraska

#### MCC 324 (949)

##### Management of Scimitar Syndrome in Two Pregnant Patients

**Laura Lombardi-Karl**, Suzanne Mankowitz  
*Columbia University Medical Center, New York, New York*

### Group 25: Medically Challenging Cases, continued

#### MCC 325 (963)

##### Cold Agglutinins in a Patient Undergoing Aortic Arch Repair: A Case Report

**Tatsuhiko Ogawa**, Taketoshi Namba  
*Kochi Health Sciences Center, Kochi, Japan*

#### MCC 326 (972)

##### Case Report; Rapidly Changing Clinical Picture in a 25 Year Old with Ehler's Danlos IV

**John M. Medrick**  
*Cleveland Clinic Foundation, Cleveland, Ohio*

#### MCC 327 (980)

##### Successful Management of Serotonin Release Syndrome Caused by Methylene Blue After Orthotopic Heart Transplant with Dexmedetomidine

**Derek Rizzo**<sup>1</sup>, Luke Liang<sup>1</sup>, Mary Jarzebowski<sup>2</sup>, Abbas Al-Qamari<sup>1</sup>  
<sup>1</sup>Northwestern University Feinberg School of Medicine, Chicago, Illinois; <sup>2</sup>Henry Ford Health System, Detroit, Michigan

### Group 26: Medically Challenging Cases

**Moderator: Beth Teegarden, MD**, The University of Texas Medical Branch at Galveston, Galveston, Texas

#### MCC 330 (983)

##### Surviving Severe Metabolic Acidosis: Case Report of Hickam's Dictum in Acidosis

**Hoang Lim**, Connor McNamara, Avneep Aggarwal, Ahmad Abou Leila  
*The Cleveland Clinic Foundation, Cleveland, Ohio*

#### MCC 331 (985)

##### Should We Pre-emptively Treat Pericarditis Following Penetrating Chest Trauma?

**Heather Barkin**, Miguel Cobas, Alexander C. Fort  
*University of Miami, Miami, Florida*

#### MCC 332 (998)

##### Cyclosporine-induced Posterior Reversible Encephalopathy Syndrome (PRES)

**Abdulai Alshoubi**, Roshni Sreedharan  
*The Cleveland Clinic Foundation, Cleveland, Ohio*



**Group 26: Medically Challenging Cases, continued**

**MCC 333 (1075)**

**Perioperative Takotsubo Cardiomyopathy**

**Abdulai Alshoubi**, Avneep Aggarwal, Ahmad Abou Leila  
*The Cleveland Clinic Foundation, Cleveland, Ohio*

**MCC 334 (1001)**

**Delayed Presentation of Post-extubation Stridor  
Necessitating ICU Admission**

**Alexandra Wright**, Avneep Aggarwal  
*The Cleveland Clinic Foundation, Cleveland, Ohio*

**Group 27: Medically Challenging Cases**

**Moderator: Kevin Thornton, MD**, University of California,  
San Francisco School of Medicine, San Francisco, California

**MCC 336 (1045)**

**Management of a GI bleed and STEMI in a Patient with  
Essential Thrombocytosis**

**Nandini C. Palaniappa**, Jon M. Aldrich  
*University of California, San Francisco School of Medicine,  
San Francisco, California*

**MCC 338 (1080)**

**Management of Severe Fire-related Inhalation  
Injury with Venovenous Extracorporeal Membrane  
Oxygenation: A Case Report**

**Grant J. Heydinger**, Aalok K. Kacha, Vijal Patel  
*The University of Chicago Medicine, Chicago, Illinois*

**MCC 340 (1110)**

**VA ECMO for Acute Mitral Regurgitation Leading to  
Aortic Root Thrombus And Subsequent Management**

**Aaron Mittel**<sup>1</sup>, Derek J. Atkinson<sup>1</sup>, Andrea N. Miltiades<sup>1</sup>,  
May Hua<sup>2</sup>  
<sup>1</sup>Columbia University Medical Center, New York, New York;  
<sup>2</sup>Columbia University, New York, New York

**MCC 341 (1021)**

**To Lyse or Not to Lyse: Marked Prolongation of the INR  
and Massive Pulmonary Embolus**

**Paul Gallo**, Micah Long, Douglas Coursin, Laura Hammel  
*University of Wisconsin, Madison, Wisconsin*

**Group 28: Medically Challenging Cases**

**Moderator: Daniel Brown, MD, PhD**, Mayo Clinic,  
Rochester, Minnesota

**MCC 343 (1128)**

**A Case of Unexplained Septic Shock**

**Jaclyn Yeung**, Laurie Mark  
*Rush University Medical Center, Chicago, Illinois*

**MCC 344 (1129)**

**Management of Endotracheal Glomus Tumor in a  
Morbidly Obese Patient Requiring Intraoperative ECMO  
Support**

**Carolyn Heeder**, Jessica Tashjian, Lundy Campbell  
*University of California, San Francisco School of Medicine,  
San Francisco, California*

**MCC 345 (1131)**

**Aortic Valve Repair and Ascending Aortic Graft  
Replacement Complicated by Exacerbation of Systolic  
Anterior Motion of the Mitral Valve Requiring Emergent  
Replacement and Myectomy**

**John B. Silva**<sup>1</sup>, Shahriar Shayan<sup>2</sup>  
<sup>1</sup>Northwestern Memorial Hospital, Chicago, Illinois; <sup>2</sup>McGaw  
Medical Center of Northwestern University, Chicago, Illinois

**MCC 346 (1143)**

**Unexplained Persistent Hypotension in a Patient with  
Fragile X, Prader-Willi Phenotype**

**Emily T. Poynton**, Mada Helou  
*University Hospitals Cleveland Medical Center, Cleveland,  
Ohio*

**MCC 347 (1145)**

**Povidone-Iodine Disruption of Tracheobronchial Tree  
after Mediastinal Washing**

**Emily T. Poynton**, James L. Hill  
*University Hospitals Cleveland Medical Center, Cleveland,  
Ohio*

**MCC 348 (929)**

**VA ECMO for VSD**

**Emily T. Poynton**, Joti J. Mucci  
*University Hospitals Cleveland Medical Center, Cleveland,  
Ohio*



# Moderated Poster Discussion Session

## Friday, April 27, 2018 • 3:00 pm – 3:45 pm

### Group 28: Medically Challenging Cases, continued

#### MCC 350 (1148)

##### **Severe Hypoxia and Compartment Syndrome in a Patient with Sickle Cell Trait After Re-Do Aortic Valve Replacement**

Vanessa Moll, **Amanda Spiritos**, Milad Sharifpour, Simon C. Lee

*Emory University School of Medicine, Atlanta, Georgia*

### Group 29: Medically Challenging Cases

**Moderator: Taylor Johnston, MD**, Columbia University, New York, New York

#### MCC 351 (1157)

##### **Compartment Syndrome as a Complication of Invasive Blood Pressure Monitoring in Patients Receiving Catheter Directed Thrombolysis**

**Syed Z. Ali**, Cheryl Richie, Joseph Bobadilla, Annette Rebel  
*University of Kentucky College of Medicine, Lexington, Kentucky*

#### MCC 352 (1163)

##### **Is the Tracheostomy Working? – Medically Challenging Case Presentation**

**Syed Z. Ali**, Zohn Centimole  
*University of Kentucky College of Medicine, Lexington, Kentucky*

#### MCC 353 (1191)

##### **Eastern Equine Encephalitis: A Dangerous Dark Horse in Organ Transplantation**

**Matthew Wiepking**<sup>1</sup>, Joel Zivot<sup>2</sup>  
<sup>1</sup>*Emory University School of Medicine, Atlanta, Georgia*;  
<sup>2</sup>*Emory University Hospital, Atlanta, Georgia*

#### MCC 354 (1197)

##### **Case Report of Acute Central Nervous System Graft versus Host Disease in a Liver Transplant Patient**

**Christine Acho**<sup>1</sup>, Heidi Davis<sup>1</sup>, Robert Acho<sup>1</sup>, Dragos M. Galusca<sup>2</sup>  
<sup>1</sup>*Henry Ford Hospital, Detroit, Michigan*; <sup>2</sup>*Henry Ford Health System, Detroit, Michigan*

### Group 29: Medically Challenging Cases, continued

#### MCC 355 (1198)

##### **Successful Management of Perioperative Massive Amniotic Fluid Embolism**

**Nat Dumrongmongcolgul**, Avneep Aggarwal  
*The Cleveland Clinic Foundation, Cleveland, Ohio*

#### MCC 356 (662)

##### **Management of a Patient with Impulse Control Disorder Admitted with Foreign Body Ingestion**

**Nat Dumrongmongcolgul**, Praveen Chahar  
*The Cleveland Clinic Foundation, Cleveland, Ohio*

### Group 30: Medically Challenging Cases

**Moderator: David W. Barbara, MD**, Mayo Clinic, Rochester, Minnesota

#### MCC 358 (1210)

##### **Utilization of IVIg for Treatment of Heparin-Induced Thrombocytopenia in a Patient with Stanford Type B Aortic Dissection**

**Justinn Tanem**<sup>1</sup>, Christofer D. Barth<sup>2</sup>  
<sup>1</sup>*Medical College of Wisconsin, Milwaukee, Wisconsin*;  
<sup>2</sup>*Aurora St. Luke's Medical Center, Wauwatosa, Wisconsin*

#### MCC 359 (1214)

##### **Metastatic Intracardiac Synovial Sarcoma: Case Report**

Rebecca M. Bauer<sup>1</sup>, **Eunie Yook**<sup>2</sup>, Jin Jung<sup>2</sup>, Edward Y. Chan<sup>1</sup>, Kamlesh Thaker<sup>1</sup>, Michael J. Reardon<sup>1</sup>  
<sup>1</sup>*Houston Methodist Hospital, Houston, Texas*; <sup>2</sup>*University of Texas at Houston, Houston, Texas*

#### MCC 360 (1216)

##### **An Uncommon and Rare Complication: The Atrioesophageal Fistula**

**Raina Khan**, Ibukunoluwa Adeleke  
*Northwestern University Feinberg School of Medicine, Chicago, Illinois*



### Group 31: Medically Challenging Cases

**Moderator: Miguel Cobas, MD, FCCM**, University of Miami, Jackson South Community Hospital, Miami, Florida

#### MCC 364 (1254)

##### **New Left Ventricular Failure Following Double Lung Transplantation in a Patient with Severe Pulmonary Hypertension**

**Todd A. Dodick<sup>1</sup>**, Matthew Bacchetta<sup>1</sup>, Marc Dickstein<sup>2</sup>  
<sup>1</sup>Columbia University Medical Center; New York-Presbyterian Hospital, New York, New York; <sup>2</sup>Columbia University, New York, New York

#### MCC 365 (1320)

##### **Pyoderma Gangrenosum Mimicking Necrotizing Fasciitis – A Potentially Fatal Misdiagnosis**

Amanda L. Koszewski, Joti J. Mucci, Nicholas Pesa,  
**Erik Bergersen**  
University Hospitals Cleveland Medical Center, Cleveland, Ohio

#### MCC 366 (1361)

##### **New Anterior Mediastinal Mass Discovered Day of Surgery: A Case Report**

**John Kroger**, Lakshmi Gudimella  
The University of Texas Medical Branch, Galveston, Texas

#### MCC 367 (1378)

##### **Itching and Amniotic Fluid Embolism with Circulatory Collapse in a Full Term Pregnant Patient**

**Azfar Niazi<sup>1</sup>**, Partha J. Saha<sup>1</sup>, Paul W. Minko<sup>1</sup>, Assad Ali<sup>1</sup>, Kavita Elliott<sup>1</sup>, Eric Chiang<sup>2</sup>, Jia Liu<sup>2</sup>, Sabry Ayad<sup>2</sup>  
<sup>1</sup>Cleveland Clinic, Cleveland, Ohio; <sup>2</sup>Cleveland Clinic Fairview Hospital, Cleveland, Ohio

### Group 32: Medically Challenging Cases

**Moderator: Michael O'Connor, MD**, The University of Chicago Medicine, Chicago, Illinois

#### MCC 369 (1409)

##### **Hypertension Associated with Dexmedetomidine: A Rare but Known Response**

**Howard Lee**, Hak Wong  
Northwestern Memorial Hospital, Chicago, Illinois

### Group 32: Medically Challenging Cases, continued

#### MCC 370 (1412)

##### **Propofol Infusion Syndrome in a Patient with Refractory Status Epilepticus: Report of a Medically-Challenging Case**

**Jeffrey D. Davis**, Ines P. Koerner  
Oregon Health & Science University, Portland, Oregon

#### MCC 371 (1420)

##### **Ethical Conflicts in Extracorporeal Membrane Oxygenation: A Case Report**

**Elizabeth McIntyre**, Elio Beta, Rachel Kadar  
McGaw Medical Center of Northwestern University, Chicago, Illinois

#### MCC 372 (1421)

##### **Perioperative Management of a Patient with von Gierke Disease Undergoing Hepatic Surgery**

Amar M. Bhatt, Floria Chae, **Brandon Pruett**, Sree V. Satyapriya  
Wexner Medical Center at The Ohio State University, Columbus, Ohio

#### MCC 373 (1433)

##### **Therapeutic Nasogastric Tube Placement for Management of Tamponade Physiology: A Case Report**

**Elliott Woodward**, Nandini C. Palaniappa, Kevin Thornton  
University of California, San Francisco School of Medicine, San Francisco, California

### Group 33: Neuroscience in Anesthesiology and Perioperative Medicine

**Moderator: Andrea Tsai, MD**, Tufts Medical Center, Boston, Massachusetts

#### NR 375 (621)

##### **Neonatal Disruption of PSD-95 PDZ Domain-mediated Protein-protein Interactions Alters Dendritic Spine Morphology, Long-term Potentiation, and Causes Deficits in Learning and Memory in Mice**

**Michele L. Schaefer**, Meina Wang, Patric Perez, Jing Xu, Reilley P. Mathena, Roger A. Johns  
Johns Hopkins University School of Medicine, Baltimore, Maryland



# Moderated Poster Discussion Session

## Friday, April 27, 2018 • 3:00 pm – 3:45 pm

### Group 33: Neuroscience in Anesthesiology and Perioperative Medicine, continued

#### NR 376 (771)

##### **The Association between Angiotensin Converting Enzyme Inhibitors and Angiotensin Receptor Blocker Use and the Incidence of Delirium in Surgical ICU Patients**

**Christopher Sheerer**, Jacob Ezell, Maged Y. Argaliou, Wael Ali Sakr Esa, Daniel I. Sessler, Nicole Zimmerman, Ehab Farag

*Cleveland Clinic Foundation, Cleveland, Ohio*

#### NR 378 (840)

##### **Sevoflurane Interferes Cell Cycle Through Inhibition of Wnt/ $\beta$ -catenin Signaling Pathway in Mouse Neural Stem Cells**

**Shiwen Liu**

*Shanghai Zhongshan Hospital, Shanghai, China*

#### NR 379 (1057)

##### **Perioperative Trajectory of Alzheimer's Disease Biomarkers In Surgical Patients And Matched Non-surgical Controls**

**Yee Ching Vanessa Cheong**<sup>1</sup>, Mary Cooter<sup>2</sup>, Richard L. Huang<sup>3</sup>, Heather E. Whitson<sup>2</sup>, Harvey J. Cohen<sup>2</sup>, Joseph P. Mathew<sup>2</sup>, Miles Berger<sup>2</sup>

<sup>1</sup>Duke-NUS Medical School, Singapore, Singapore; <sup>2</sup>Duke University Medical Center, Durham, North Carolina; <sup>3</sup>Duke University, Durham, North Carolina

#### NR 380 (1325)

##### **Discriminative Capacity of EEG Power for the Onset and Severity of Delirium in the Postoperative Period**

**Ying Jiang**, Emma R. Trammel, Ginika Apakama, James W. Spencer, Troy Wildes, Michael Avidan, Ben Palanca

*Washington University in St. Louis, St. Louis, Missouri*

### Group 34: Medically Challenging Cases, Neuroscience in Anesthesiology and Perioperative Medicine, and Perioperative Anesthesia

**Moderators:** **Jean Charchafli**, MD, MPH, DrPH, Yale School of Medicine, New Haven, Connecticut; and **Stephen Surgenor**, MD, Dartmouth Hitchcock Health, Lebanon, New Hampshire

#### NR 382 (537)

##### **Sugammadex Offers a New Option for Early Cessation of Neuromuscular Blockade to Facilitate Spinal Cord Evoked Potential Monitoring**

**Jackson M. Hylton**, Michael Scott

*Virginia Commonwealth University Health, Richmond, Virginia*

#### NR 383 (953)

##### **Power Spectrum and Frontal Alpha Band Activity Saturation Predicts Loss of Response to Verbal Command in Older Adults During Anesthetic Induction with Propofol: A Diagnostic Test Approach**

**Carlos M. Fuentes**, Juan C. Pedemonte, Andrea Sanchez, Martin Irani, Mohit Rana, Victor Contreras, Ignacio Cortinez  
*Pontificia Universidad Católica de Chile, Santiago de Chile, Chile*

#### PA 384 (530)

##### **Association of Age and Gender with Postoperative Respiratory Failure**

**Punit Singh**, Ali Seifi

*University of Texas Health Science Center San Antonio, San Antonio, Texas*

#### PA 385 (555)

##### **Association of Preoperative Anticholinergic Medication Exposure with Postoperative Healthcare Resource Use and Outcomes: A Population-Based Cohort Study**

**Deric B. Diep**<sup>1</sup>, Coralie Wong<sup>2</sup>, Carl van Walraven<sup>1</sup>, Daniel I. McIsaac<sup>1</sup>

<sup>1</sup>University of Ottawa, Faculty of Medicine, Ottawa, Ontario, Canada; <sup>2</sup>The Ottawa Hospital Research Institute, Ottawa, Ontario, Canada

#### MCC 386 (1217)

##### **Anesthetic Challenges of Emergency Gynecological Surgery in a Jehovah's Witness with Fontan Circulation: A Case Report**

**Deric B. Diep**, Malcolm Lucy, Ashraf Fayad

*University of Ottawa, Ottawa, Ontario, Canada*



**Group 34: Medically Challenging Cases, Neuroscience in Anesthesiology and Perioperative Medicine, and Perioperative Anesthesia, continued**

**MCC 387 (1220)**

**Transesophageal Echocardiography in the Intraoperative Management of Renal Cell Carcinoma with Inferior Vena Cava Thrombus: A Case Report**

**Deric B. Diep**, Malcolm Lucy, Ashraf Fayad  
*University of Ottawa, Ottawa, Ontario, Canada*

**PA 388 (740)**

**The iShuddle: A Strategy to Decreases Turn-Over-Time by Improving Culture in the Operating Room**

**Richard J. Banchs**<sup>1</sup>, Molly Driscoll<sup>1</sup>, Hokuto Nishioka<sup>2</sup>  
<sup>1</sup>*The University of Chicago Medicine, Chicago, Illinois;*  
<sup>2</sup>*University of Illinois Hospital, Chicago, Illinois*

**Group 35: Pain Medicine**

**Moderator: Sheela Pai Cole, MD**, Stanford University, Stanford, California

**PM 390 (791)**

**Inflammatory Stress Response to Cytoreductive Surgery and Heated Chemotherapy**

Guillermo Madrid, Katherine Pimient, Carlos A. Triana, Jairo Moyano, **Maria Conchita Solórzano**  
*Fundación Santa Fe de Bogotá, Bogotá, Cundinamarca*

**PM 391 (1235)**

**Role of Pain Specialists in Reducing Healthcare Costs for Patients with Chronic Pain**

Jennifer Anderson<sup>1</sup>, Kathryn Komaki<sup>1</sup>, Steven Prakken<sup>1</sup>, Lance Roy<sup>1</sup>, Thomas Buchheit<sup>2</sup>, John Hunting<sup>1</sup>, **Padma Gulur**<sup>2</sup>  
<sup>1</sup>*Duke University Medical Center, Durham, North Carolina;*  
<sup>2</sup>*Duke University School of Medicine, Durham, North Carolina*

**PM 392 (570)**

**Comparison of Postoperative Analgesic Effect of Preemptive Use of Tramadol Versus Ketamine in Laparoscopic Surgery**

**Xin Wang**  
*The 4th Center Hospital, Tianjin, Tianjin*

**Group 36: Perioperative Anesthesia**

**Moderator: William Peruzzi, MD**, Henry Ford Health System, Detroit, Michigan

**PA 394 (1169)**

**A Systematic Review and Meta-Analysis Examining the Impact of Sleep Disturbance on Post-Operative Delirium**

**Ayotunde B. Fadayomi**<sup>1</sup>, Reine Ibala<sup>2</sup>, Hao Deng<sup>2</sup>, Michael B. Westover<sup>2</sup>, Oluwaseun Johnson-Akeju<sup>2,3</sup>  
<sup>1</sup>*Brigham and Women's Hospital, Boston, Massachusetts;*  
<sup>2</sup>*Massachusetts General Hospital, Boston, Massachusetts;*  
<sup>3</sup>*Harvard Medical School, Boston, Massachusetts*

**PA 396 (1408)**

**Echocardiographic Assessment using Subxiphoid-only view (EASy) Compared to Focused Transthoracic Echocardiography (FoTE) in the Perioperative Period: A Multicenter Prospective Study**

**Kevin Emr**<sup>1</sup>, Nibras Bughrara<sup>2</sup>, Johnathan R. Renew<sup>3</sup>, Jose Diaz-Gomez<sup>3</sup>, Kirti Sahu<sup>1</sup>, Kevin Roberts<sup>2</sup>  
<sup>1</sup>*Albany Medical Center, Albany, New York;* <sup>2</sup>*Albany Medical College, Albany, New York;* <sup>3</sup>*Mayo Clinic Florida, Jacksonville, Florida*

**PA 397 (1229)**

**Addition of Focused Transthoracic Echocardiography (FoTE) Learning into Existing Anesthesiology Residency Training Programs: A Prospective Multicenter Study of Blended Learning**

**Mercedes Meuli**<sup>1</sup>, Nibras Bughrara<sup>2</sup>, Tanya Richvalsky<sup>2</sup>, Mark Hamlin<sup>3</sup>, Kirti Sahu<sup>1</sup>, Kevin Roberts<sup>2</sup>  
<sup>1</sup>*Albany Medical Center, Albany, New York;* <sup>2</sup>*Albany Medical College, Albany, New York;* <sup>3</sup>*University of Vermont Medical Center, Burlington, Vermont*

**PA 398 (869)**

**Effect of Dexamethasone on Postoperative Pain Scores in a Resource-Limited Setting: A Randomized Double Blind Placebo Controlled Clinical Trial**

**Nodreen C. Ayupo**, Emmanuel Ayebale, Fred Bulamba, Arthur Kwizera  
*Makerere University, Kampala, Uganda*

**PA 399 (1015)**

**A Nationwide Study of Dental Injuries in Relation to General Anesthesia**

**Rasmus E. Christensen**, Josefine S. Baekgaard, Lars S. Rasmussen  
*Rigshospitalet, Copenhagen, Denmark*



# Moderated Poster Discussion Session Friday, April 27, 2018 • 3:00 pm – 3:45 pm

## Group 37: Perioperative Anesthesia

**Moderator: Michael Urban, MD**, Hospital for Special Surgery, New York, New York

### PA 401 (1363)

#### **The Risk of Severe Aortic Stenosis in Elective Non-Cardiac Surgery**

**Jay S. Han<sup>1</sup>**, W. Scott Beattie<sup>2</sup>

<sup>1</sup>University Health Network, Toronto, Ontario, Canada;

<sup>2</sup>University of Toronto Faculty of Medicine, Toronto, Ontario, Canada

### PA 402 (1370)

#### **Impact of ICU Admission on the Perioperative Trajectory of Elderly Surgical Patients**

Pakeezah Saadat, **Romain Jouffroy**, Yannick Le Manach  
McMaster University, Hamilton, Canada

### PA 403 (1371)

#### **Post-Operative Sepsis: What is the Current Picture?**

**Amber N. Campbell<sup>1</sup>**, George W. Williams<sup>1</sup>, Navneet Grewal<sup>2</sup>, Velvet Patterson<sup>1</sup>, Daniel Contreras<sup>1</sup>, Robert Wegner<sup>1</sup>, Rabail Chaudry<sup>3</sup>

<sup>1</sup>University of Texas, Houston-McGovern Medical School, Houston, Texas; <sup>2</sup>University of Texas, Houston, Houston, Texas; <sup>3</sup>University of Toronto, Toronto, Canada

## Group 37: Perioperative Anesthesia, continued

### PA 404 (1417)

#### **General Anesthesia Alters Gut Microbiota Diversity and Composition in Mice**

**Mara A. Serbanescu<sup>1</sup>**, Reilley P. Mathena<sup>1</sup>, Raul Cano<sup>2</sup>, Tasha Santiago-Rodriguez<sup>2</sup>, Theresa Hartsell<sup>1</sup>, Cyrus D. Mintz<sup>1</sup>

<sup>1</sup>Johns Hopkins School of Medicine, Baltimore, Maryland;

<sup>2</sup>Institute for Life Science Entrepreneurship, Union, New Jersey

### PA 405 (1444)

#### **Stroke Volume Assessment by Invasive Arterial Blood Pressure Tracing, SpO2 and Bioreactance: A Comparative Study**

**Jasper Wylleman<sup>1</sup>**, Tina Maes<sup>1</sup>, Roxane Cool<sup>1</sup>, Michel Vervoort<sup>1</sup>, Jan Poelaert<sup>1,2</sup>

<sup>1</sup>UZ Brussel, Brussels, Belgium, <sup>2</sup>Vrije Universiteit Brussel (VUB), Brussels, Belgium

## Thank You SOCCA Exhibitors and Sponsors

The Society of Critical Care Anesthesiologists Board of Directors acknowledges with thanks the exhibitors and sponsors for the SOCCA 2018 Annual Meeting and Critical Care Update.

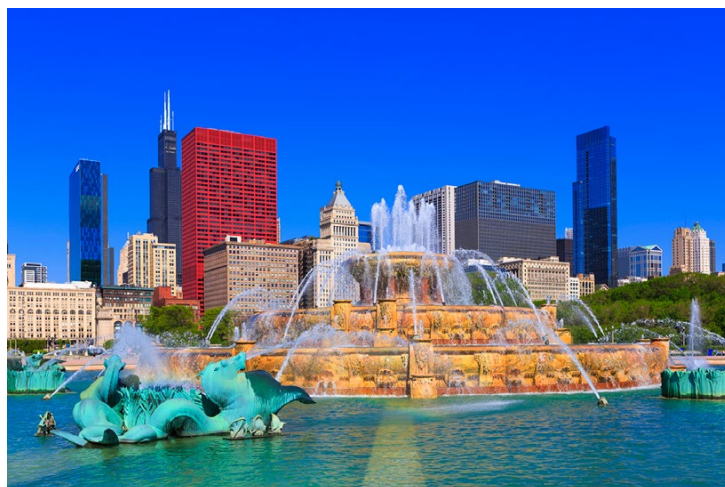

# Abstract Presenter Index



- Aali, Maral**  
CC 208 (1394)
- Acho, Christine**  
MCC 354 (1197)
- Aggarwal, Richa**  
CC 211 (723)
- Ali, Syed**  
MCC 351 (1157)  
MCC 352 (1163)
- Alshoubi, Abdalhai**  
MCC 332 (998)  
MCC 333 (1075)
- Ayupo, Nodreen**  
PA 398 (869)
- Bacigalupo Landa, Andres**  
MPC 248 (650)
- Baekgaard, Josefine**  
T 243 (937)
- Baesch, Lynden**  
CC 226 (734)
- Balduyeu, Pavel**  
MCC 282 (637)
- Balzer, Felix**  
CA 181 (1242)
- Banchs, Richard**  
PA 388 (740)
- Barkin, Heather**  
MCC 331 (985)
- Barnes, Theresa**  
MCC 285 (653)  
MCC 286 (862)
- Bauer, Rebecca**  
MCC 359 (1214)
- Beta, Elio**  
MCC 322 (934)
- Bilgili, Beliz**  
CC 192 (1258)
- Blair, Gregory**  
TCSEM 230 (1126)
- Brennan, Meghan**  
TCSEM 231 (1331)
- Broyles, Matthew**  
MCC 279 (630)
- Brunker, Lucille**  
MCC 278 (624)
- Burke, Sarah**  
MCC 274 (552)
- Campbell, Amber**  
PA 403 (1371)
- Caporusso, Francesco**  
MCC 320 (930)
- Caridi-Scheible, Mark**  
CC 213 (941)
- Caylor, Jacob**  
AM 160 (911)
- Chanan, Emily**  
CC 201 (668)
- Chau, Yen**  
MCC 309 (855)
- Che, Lu**  
AM 161 (1004)  
PA 162 (990)
- Cheong, Yee Ching Vanessa**  
NR 379 (1057)
- Cheriyana, Thomas**  
BLD 236 (1199)  
TCSEM 235 (743)
- Christensen, Rasmus**  
PA 399 (1015)
- Coleman, Patrick**  
MCC 303 (792)
- Corle, Kelsey**  
MCC 272 (522)
- Cummins, Danielle**  
MCC 299 (704)
- Dahl, Ashley**  
MCC 298 (698)
- Davis, Jeffrey**  
MCC 370 (1412)
- Denny, Chris**  
CA 180 (924)
- Diaczok, Daniel**  
MCC 319 (927)
- Diep, Deric**  
MCC 386 (1217)  
MCC 387 (1220)  
PA 385 (555)
- Dobish, Mark**  
MCC 287 (671)
- Dodick, Todd**  
MCC 364 (1254)
- Dong, Erik**  
CC 219 (890)
- Dumrongmongcolgul, Nat**  
MCC 355 (1198)  
MCC 356 (662)
- Echeverry, German**  
CC 185 (1102)  
CC 186 (1350)
- Elnagar, Islaam**  
CC 240 (1043)
- Emr, Kevin**  
PA 395 (1160)  
PA 397 (1408)
- Eskesen, Trine**  
T 244 (944)
- Eydelman, Leon**  
CC 222 (1182)
- Fadayomi, Ayotunde**  
PA 394 (1169)
- Fast, Ian**  
PS 265 (958)
- Fink, Ryan**  
CC 214 (532)
- Fuentes, Carlos**  
NR 383 (953)
- Gallo, Paul**  
MCC 341 (1021)
- Gelter, Marianne**  
EEP 263 (700)
- Glover, Chris**  
PED 257 (548)
- Go, Samantha**  
MCC 300 (732)
- Groff, Robert**  
CC 216 (1206)
- Gross, Caroline**  
MCC 296 (687)
- Gulur, Padma**  
PM 391 (1235)
- Harris, James**  
MCC 289 (674)
- Hedlund, Megan**  
MCC 311 (889)  
MCC 312 (673)
- Heeder, Carolyn**  
MCC 344 (1129)
- Henley, Megan**  
CC 220 (1034)
- Herrick, Susan**  
CC 197 (1088)
- Hester, Shanterian**  
MCC 306 (828)
- Heydinger, Grant**  
MCC 338 (1080)
- Hornack, Katherine**  
CC 241 (1387)
- Hylton, Jackson**  
NR 382 (537)
- Jia, Shawn**  
MCC 314 (895)
- Jiang, Ying**  
NR 380 (1325)
- Johnson, Angela**  
BLD 172 (921)  
MCC 173 (576)
- Jouffroy, Romain**  
PA 402 (1370)
- Jung, Michael**  
MCC 270 (489)
- Karamchandani, Kunal**  
MCC 273 (529)
- Katan, Ognjen**  
CC 210 (701)
- Ke, Yunbo**  
BS 187 (784)
- Khan, Raina**  
MCC 360 (1216)
- Khanna, Ashish**  
CC 199 (1279)  
CC 200 (1285)
- Kidd, Brent**  
MCC 284 (648)
- Kiefer, Jesse**  
EEP 262 (508)
- Kim, David**  
RA 169 (907)
- Kim, Junghyun**  
BLD 175 (838)
- Kor, Benjamin**  
MCC 323 (948)
- Kor, Nathan**  
BLD 176 (756)
- Koszewski, Amanda**  
MCC 365 (1320)



# Abstract Presenter Index

**Kroger, John**  
MCC 366 (1361)

**Kuhlmann, Theresa**  
BLD 177 (1042)

**Kumar, Annandita**  
CC 215 (715)

**Lane-Fall, Meghan**  
CC 206 (1404)

**Law, Tina**  
MCC 290 (675)  
MCC 291 (1379)

**LeBlanc, Brooke**  
AM 159 (1257)

**Lee, Howard**  
MCC 369 (1409)

**Leiendecker, Eric**  
MCC 283 (642)

**Leopold, David**  
TCSEM 237 (1181)  
TCSEM 238 (1365)

**Levin, Danielle**  
MCC 251 (839)  
O 250 (835)  
OB 252 (753)  
OB 253 (799)

**Lim, Hoang**  
MCC 330 (983)

**Liu, Shiwen**  
NR 378 (840)

**Lombardi-Karl, Laura**  
MCC 324 (949)

**Lupei, Monica**  
PS 266 (960)

**Madrid, Guillermo**  
PM 390 (791)

**Makker, Hemanckur**  
MCC 301 (788)

**Mammadova, Naila**  
MCC 277 (595)

**McDonald, Michael**  
CC 195 (606)

**McIntyre, Elizabeth**  
MCC 371 (1420)

**McNamara, Connor**  
MCC 294 (683)

**Medrick, John**  
MCC 326 (972)

**Metzger, Anja**  
CA 179 (1058)

**Meuli, Mercades**  
PA 396 (1229)

**Mickus, Gregory**  
CC 202 (685)

**Mittel, Aaron**  
MCC 340 (1110)

**Murugappan, Kadhiresan**  
MCC 269 (488)

**Nguyen, Khoa**  
TCSEM 229 (697)

**Niazi, Azfar**  
MCC 367 (1378)

**Ogawa, Tatsuhiko**  
MCC 325 (963)

**Olsen, Joanna**  
RES 224 (686)

**Palaniappa, Nandini**  
MCC 336 (1045)

**Palmer, Louisa**  
CC 207 (965)

**Panigrahi, Bishnu**  
GH 264 (1289)

**Paparisto, Ergit**  
CC 193 (867)

**Pascual-Ramirez, Javier**  
CC 221 (1089)

**Pastor, Joshua**  
CC 223 (1304)

**Patel, Vijal**  
CC 188 (1432)  
MCC 190 (1267)  
OB 189 (1439)

**Peck, Jacquelin**  
PED 259 (845)  
PED 260 (847)

**Penugonda, Lakshmi**  
MCC 310 (860)

**Poynton, Emily**  
MCC 346 (1143)  
MCC 347 (1145)  
MCC 348 (929)

**Privratsky, Jamie**  
CA 182 (936)

**Pruett, Brandon**  
MCC 372 (1421)

**Rainey, Jeremy**  
MCC 305 (804)

**Rengel, Kimberly**  
GA 256 (1344)

**Reskallah, Alexander**  
CC 203 (1091)

**Rizzo, Derek**  
MCC 327 (980)

**Russell, Michael**  
T 242 (590)

**Safavi, Kyan**  
TCSEM 233 (528)

**Schaefer, Michele**  
NR 375 (621)

**Sen, Indu**  
PS 267 (1284)

**Serbanescu, Mara**  
PA 404 (1417)

**Shah, Sapan**  
AM 165 (1156)  
CA 166 (1164)  
MCC 167 (1140)  
RA 168 (807)

**Shah, Shagun**  
CA 183 (932)

**Sheerer, Christopher**  
NR 376 (771)

**Shen, Tao**  
MCC 276 (568)

**Siddiqui, Zuhair**  
MCC 271 (505)

**Silva, John**  
MCC 345 (1131)

**Singh, Punit**  
PA 384 (530)

**Siscel, Jordan**  
MCC 317 (922)

**Skoblar, Matthew**  
MCC 318 (925)

**Spiritos, Amanda**  
MCC 350 (1148)

**Srour, Habib**  
MCC 297 (693)

**Stentz, Michael**  
CC 209 (1037)

**Stevens, Jia Liu**  
MPC 249 (786)

**Subramanian, Harikesh**  
MCC 280 (635)

**Tallen, Ari**  
CC 217 (718)

**Tanem, Justinn**  
MCC 358 (1210)

**Tang, Jonathan**  
MCC 304 (797)

**Tao, Jing**  
BLD 174 (604)

**Taylor, Ashley**  
CC 227 (751)

**Thiele, Robert**  
CC 196 (1329)

**Tooley, Nicholas**  
MCC 316 (900)

**Wagener, Gebhard**  
L 184 (562)

**Wajima, Zen'ichiro**  
TCSEM 234 (713)

**Wakin, Kristin**  
MCC 292 (678)

**Walters, Kelsey**  
CC 204 (914)

**Wang, Xin**  
PM 392 (570)

**Wiepkings, Matthew**  
MCC 353 (1191)

**Woodward, Elliott**  
MCC 373 (1433)

**Wright, Alexandra**  
MCC 334 (1001)

**Wu, Kevin**  
GA 255 (558)

**Wylleman, Jasper**  
PA 405 (1444)

**Yeung, Jaclyn**  
MCC 343 (1128)

**Zauk, Jenna**  
MCC 307 (831)

**Ziethen, Tim**  
AM 163 (1104)



---

## Airway Management

Non-Invasive Ventilation in Perioperative Surgical Patients  
AM 159 (1257)

Current Practice of Cricoid Pressure Application for Endotracheal Intubation  
AM 160 (911)

A Pilot Study of Radiological Variables to Predict Fiberoptic Intubation in Ankylosing Spondylitis with Cervical Spine Involvement  
AM 161 (1004)

Difficult Tracheal Extubation in Adult Surgical Intensive Care  
AM 163 (1104)

Ultra Low Cost & Minimally Stimulating Method of Relieving Airway Obstruction During Mac  
AM 165 (1156)

---

## Bench Science

Signaling in Vascular Endothelium by Varying Degrees of Mechanical Stretch  
BS 187 (784)

---

## Blood Management

High Reliability Medicine in Transfusion: Intelligent Blood Management  
BLD 172 (921)

Safety of Four Factor Prothrombin Complex Concentrates (4F-Pcc) for the Reversal of Factor Xa Inhibitors  
BLD 174 (604)

Contrasting Effects of Stored Allogeneic Red Blood Cells and Their Supernatants on Permeability and Inflammatory Responses by Human Pulmonary Artery Endothelial Cells  
BLD 175 (838)

Verification of Provider Indications for Red Blood Cell Transfusion Therapies: A Retrospective Cohort Study  
BLD 176 (756)

Impact of Reinforced, Strict Guidelines on the Usage of Packed Red Blood Cells (PRBC)  
BLD 177 (1042)

---

## Blood Management, continued

Efficacy of Intraoperative Cell Salvage in Spine Surgery: A Meta-analysis  
BLD 236 (1199)

---

## Cardiovascular Anesthesiology

Acute Bleeding from an Aortic Pseudoaneurysm Due to Sneezing After CABG Surgery  
CA 166 (1164)

Active Intrathoracic Pressure Regulation: A Novel Non-invasive Device to Improve Hemodynamics after Blood Loss in a Porcine Model of Hemorrhage  
CA 179 (1058)

Fatigue and Dyspnea on Exertion in a Patient with Previous Aortic Valve Surgery  
CA 180 (924)

Impact of Methylprednisolone on the Incidence of Postoperative Complications in Cardiac Surgery Patients  
CA 181 (1242)

Variant Apolipoprotein L1 (APOL1) Alleles Are Associated With Increased Risk Of Post-Cardiac Surgery Acute Kidney Injury  
CA 182 (936)

Cardiac Output Monitoring: A Comparative Prospective Observational Study of the Conventional Cardiac Output Monitor and a New Smartphone Based Application  
CA 183 (932)

---

## Critical Care

The Prognostic Value of Cardiac Power Output in Septic Patients  
CC 192 (1258)

Hyperacute Catheter-Associated Pulmonary Embolus in the Immediate Postoperative Period Following Spinal Surgery  
CC 193 (867)

Long-Term Outcomes Following Extracorporeal Life Support for Acute Respiratory Failure  
CC 195 (606)

Sepsis Upregulates HIF-1 Independent of Tissue Oxygenation  
CC 196 (1329)

---

## Critical Care, continued

Focused Transthoracic Echocardiography and In-Hospital Cardiac Arrest: A Case Series of 10 Resident-Obtained Echocardiograms in the Peri-Resuscitative Period  
CC 197 (1088)

Association of Angiotensin II Dose with All-Cause Mortality in Patients with Vasodilatory Shock  
CC 199 (1279)

Association between MAP and Mortality in Vasodilatory Shock at an Academic Medical Center  
CC 200 (1285)

Risks Associated With  $\beta$ -Blocker Discontinuation After Cardiac Surgery  
CC 201 (668)

Hydroxocobalamin for Treatment of Bacteria-induced Vasoplegia: The Magic Bullet for Septic Shock?  
CC 204 (914)

Defining Familial Interactions and Networks (Define): An Exploratory Study on Family Networks and Surrogate Decision Making in the ICU  
CC 206 (1404)

Is all Chlorhexidine Bathing equal? A Comparison of Skin Chlorhexidine Concentration and Bacterial Colonization After Different, Commonly Used, Methods of Chlorhexidine Bathing  
CC 207 (965)

Utility of DIBI, a Novel Iron Chelator, as Therapeutic Modality for Murine Peritonitis-Induced Sepsis  
CC 208 (1394)

Trends in the Use of Extracorporeal Membrane Oxygenation in the United States, 2011-2014: An Examination of State-Level Billing Data  
CC 209 (1037)

The Effect of Daily Fluid Balance on Mechanical Ventilation in Subarachnoid Hemorrhage  
CC 210 (701)

Does Real Time Ultrasonography During Bronchoscopy Guided Percutaneous Tracheostomy Confer Any Benefit: A Preliminary, Randomised Controlled Trial  
CC 211 (723)

# Abstract Category Index

---

## Critical Care, continued

Implementation of a Simulation-based Training Program for ECMO Complications  
CC 213 (941)

Boarding of ICU Patients Does Not Impact Mortality in an Academic Health System  
CC 216 (1206)

Characteristics and Outcomes of Oncologic ICU Admissions: Rapid Response Team versus Critical Care Medicine Consult Pathways  
CC 185 (1102)

Management of Toxicities Associated with Chimeric Antigen Receptor (CAR) T Cells in the ICU  
CC 186 (1350)

Early Mechanical Circulatory Support Improves Outcomes in Idiopathic Myocarditis  
CC 188 (1432)

Behavioral Patterns of Electrolyte Repletion in Intensive Care Units: Lessons from a Large Electronic Dataset  
CC 194 (1426)

Cost Reduction in ICU: Substitution of IV Levothyroxine with PO Levothyroxine  
CC 202 (685)

Pilot Prospective Randomized Trial Comparing Methods of Teaching Point-of-Care Ultrasound Image Interpretation Skills to Medical Trainees  
CC 203 (1091)

Replacing Albumin With Crystalloids for Postoperative Cardiac Surgery Fluid Resuscitation in the Intensive Care Unit – An Interprofessional Approach  
CC 214 (532)

The Modified Early Warning System in Unplanned SICU Admission: An Analysis in 263 Consecutive Patients  
CC 215 (715)

Cardiac Strain as a Measure of Myocardial Dysfunction After Subarachnoid Hemorrhage  
CC 217 (718)

Neuroinvasive West Nile Virus Post Heart Transplantation  
CC 219 (890)

---

## Critical Care, continued

Improving Quality of Care by Standardizing OR to Surgical ICU Handoffs  
CC 220 (1034)

The Nitric Oxide Pathway Antagonists in Septic Shock: Meta-Analysis of Controlled Clinical Trials  
CC 221 (1089)

Outcomes Within the First Three Years of a New Venovenous ECMO Program  
CC 222 (1182)

Arterio-enteric Fistula Following Pancreatic Surgery  
CC 223 (1304)

Successful Treatment of Post-Myocardial Infarction Hiccups with Dexmedetomidine  
CC 226 (734)

Post Operative Hypoxic: A Unique Case of Thoracotomy Complicated by Platypnoea-Orthodeoxia Syndrome  
CC 227 (751)

Improving Multi-disciplinary Sign-out upon Discharge from the SICU  
CC 240 (1043)

VV ECMO and Mycoplasma pneumoniae Pneumonia  
CC 241 (1387)

---

## Economics, Education and Policy

Academic Contributions of United States Anesthesiologists to Critical Care Medicine  
EEP 262 (508)

Perspective on Leadership and Millennial Physicians  
EEP 263 (700)

---

## Geriatric Anesthesia

Long-term Caregiving is Associated with Impaired Cardiovascular Baroreflex – Implications on Anesthesia Care  
GA 255 (558)

Cognitive and Physical Exercise Prehabilitation to Improve Outcomes in Surgical Patients  
GA 256 (1344)

---

## Global Health

A Study Examining Antimicrobial Resistance And Consumption Trends Using DRI  
GH 264 (1289)

---

## Liver

Predicting Postoperative Liver Dysfunction Using Indocyanine Green Clearance After Cardiac Surgery  
L 184 (562)

---

## Medically Challenging Cases

Anesthetic Management of Quaternary C/S in a Patient with Diffuse, Destructive Malignant Metastatic Lesions  
MCC 167 (1140)

Cecal Bascule After Cardiac Surgery  
MCC 173 (576)

Cardiovascular Collapse as the Initial Presentation of Catastrophic Antiphospholipid Syndrome  
MCC 190 (1267)

Successful Anesthetic Management of a Patient with Multiple Trauma and Severe Hypothermia: A Case Report  
MCC 251 (839)

Fatal Exertional Rhabdomyolysis: A Devastating Complication of Sickle Cell Trait and Drastic Weight Cutting  
MCC 269 (488)

Toxic Flowers and Aconite Poisoning: A Case of Critical Illness after Chinese Herbal Tea  
MCC 270 (489)

Intraoperative Placement of Prone Femoral Central Venous Catheter in a Patient with Hemorrhagic Cerebral Arteriovenous Malformation  
MCC 271 (505)

Rhabdomyolysis after Robotic Nephrectomy  
MCC 272 (522)

A Novel Association of Juvenile Polyposis Syndrome with Atrial Septal Aneurysm and Patent Foramen Ovale  
MCC 273 (529)



## Medically Challenging Cases, continued

Perioperative Management of Orthotopic Liver Transplant for Intrahepatic Cholestasis in Sickle Cell Disease  
MCC 274 (552)

Management Considerations in a Patient with Repeated Posterior Circulation Strokes Refractory to Medical Therapy  
MCC 276 (568)

Challenges in Management of Clostridium Difficile Infection in a Patient with Durable Left Ventricular Assist Device  
MCC 277 (595)

Postoperative STEMI in a Critically Ill Patient  
MCC 278 (624)

Complications Following Lumbar Drain Placement For Thoracic/Thoracoabdominal Aortic Aneurysm Repair: Two Case Reports and Literature Review  
MCC 279 (630)

Subclavian Steal Phenomenon Following TEVAR for an Aorto-bronchial Fistula in a Patient with Situs Inversus  
MCC 280 (635)

PICC Line Challenge  
MCC 282 (637)

IVC Tumor Thrombectomy Complicated by Air Embolism; ECMO Salvage  
MCC 283 (642)

Management of Hypoxia During Centrally Cannulated VA ECMO  
MCC 284 (648)

Massive Hepatic Hematoma Caused by HELLP Syndrome  
MCC 285 (653)

Hemophagocytic Lymphohistiocytosis – A Diagnostic Conundrum  
MCC 286 (862)

Chronic Skull Base Erosion from Temporomandibular Joint Disease Causes Generalized Seizure and Profound Lactic Acidosis  
MCC 287 (671)

When the Pulmonary Embolus From Outside Hospital Isn't Really a Pulmonary Embolus: Point-of-Care Echocardiographic Detection of Severe Cardiomyopathy  
MCC 289 (674)

## Medically Challenging Cases, continued

Perioperative Heart failure in a Young Woman: A Case of Non-compaction Cardiomyopathy  
MCC 290 (675)

ICU Management After Rescue Hepatectomy for Primary Allograft Non-function  
MCC 291 (1379)

Labile Factor VIII Activity in a Patient with Hemophilia A Undergoing On-Pump Coronary Artery Bypass Grafting  
MCC 292 (678)

A Case Report: Acute, Benign Superior Vena Cava Syndrome: Is it Critical?  
MCC 294 (683)

Cardiac Tamponade Following Orthotopic Liver Transplantation: Two Case Reports  
MCC 296 (687)

Right Sided Pneumothorax Resulting in ST-segment Depression After Coronary Artery Bypass Grafting Surgery  
MCC 297 (693)

Severe Streptococcal Necrotizing Fasciitis Treated with Intravenous Immunoglobulin Therapy in the Intensive Care Unit  
MCC 298 (698)

Not All Effusions Need Drainage at 2 AM: Point-of-Care Echocardiography to Prevent Unnecessary Emergency Pericardiocentesis  
MCC 299 (704)

Pneumothorax versus Rapidly Expanding Bulla Following Mechanical Ventilation in a Patient with Loey's-Dietz Syndrome: A Case Report  
MCC 300 (732)

Successful Management of Severe Inhalation Injury Secondary to Sulfuric Acid with Venovenous Extracorporeal Membrane Oxygenation  
MCC 301 (788)

How Findings on Transesophageal Echocardiography Can Change the Surgical Approach for Management of a Pericardial Effusion from Penetrating Chest Trauma  
MCC 303 (792)

## Medically Challenging Cases, continued

Utilization of Venovenous Extracorporeal Membrane Oxygenation in Acute Massive Pulmonary Embolism: A Case Report  
MCC 304 (797)

Boating Accident Resulting in Polytrauma Requiring Double Lumen Tube Placement with Two Ventilator Strategy  
MCC 305 (804)

Development of meningitis after severe head trauma treated with a course of prophylactic antibiotics  
MCC 306 (828)

Placement of a Dialysis Catheter Leading to Lethal Cardiac Tamponade  
MCC 307 (831)

Penetrating Atherosclerotic Ulcer of the Ascending Aorta: A Case Report  
MCC 309 (855)

Extensive Necrotizing Soft Tissue Infection Resulting in Pulmonary Air Embolism and Cardiac Arrest  
MCC 310 (860)

Thromboelastography (TEG)-guided Hemodynamic Resuscitation in a Patient with Severe Hemorrhagic Coagulopathy with Acquired Hemophagocytic Lymphohistiocytosis Related to Epstein-Barr Virus  
MCC 311 (889)

Right Ventricular Assist Device Placement For Acute Right Ventricular Failure After Heart Transplantation: Echocardiographic guidance throughout the perioperative process  
MCC 312 (673)

Critical Care Genetics: A Case of Severe Hyperammonemia Due to an Adult-onset Urea Cycle Disorder  
MCC 314 (895)

Treatment of Eosinophilic Myocarditis with Extracorporeal Membrane Oxygenation: A Case Report  
MCC 316 (900)

Using a Novel Protocol to Standardize Weaning from Venovenous Extracorporeal Membrane Oxygenation (VV ECMO), A Case Report  
MCC 317 (922)



# Abstract Category Index

## Medically Challenging Cases, continued

- Successful Treatment of Recurrent Chronic Scrotal Pain Secondary to Post Laminectomy Syndrome with Spinal Cord Stimulation  
MCC 318 (925)
- Diagnosis and Management of Subclavian-Esophageal Fistula  
MCC 319 (927)
- Prone Positioning and VV ECMO for Severe ARDS Due to Wegener's Pulmonary Granulomatosis  
MCC 320 (930)
- Hemodynamic Instability in Late Pericardial Tamponade Post LVAD Placement: A Case Report  
MCC 322 (934)
- An Unexpected Infection: A Case of Neurobrucellosis  
MCC 323 (948)
- Management of Scimitar Syndrome in Two Pregnant Patients  
MCC 324 (949)
- Cold Agglutinins in a Patient Undergoing Aortic Arch Repair: A Case Report  
MCC 325 (963)
- Case Report; Rapidly Changing Clinical Picture in a 25 Year Old with Ehler's Danlos IV  
MCC 326 (972)
- Successful Management of Serotonin Release Syndrome Caused by Methylene Blue After Orthotopic Heart Transplant with Dexmedetomidine  
MCC 327 (980)
- Surviving Severe Metabolic Acidosis: Case Report of Hickam's Dictum in Acidosis  
MCC 330 (983)
- Should We Pre-emptively Treat Pericarditis Following Penetrating Chest Trauma?  
MCC 331 (985)
- Cyclosporine-induced Posterior Reversible Encephalopathy Syndrome (PRES)  
MCC 332 (998)
- Perioperative Takotsubo Cardiomyopathy  
MCC 333 (1075)
- Delayed Presentation of Post-extubation Stridor Necessitating ICU Admission  
MCC 334 (1001)

## Medically Challenging Cases, continued

- Management of a GI bleed and STEMI in a Patient with Essential Thrombocytosis  
MCC 336 (1045)
- Management of Severe Fire-related Inhalation Injury with Venovenous Extracorporeal Membrane Oxygenation: A Case Report  
MCC 338 (1080)
- VA ECMO for Acute Mitral Regurgitation Leading to Aortic Root Thrombus and Subsequent Management  
MCC 340 (1110)
- To Lyse or Not to Lyse: Marked Prolongation of the INR and Massive Pulmonary Embolus  
MCC 341 (1021)
- A Case of Unexplained Septic Shock  
MCC 343 (1128)
- Management of Endotracheal Glomus Tumor in a Morbidly Obese Patient Requiring Intraoperative ECMO Support  
MCC 344 (1129)
- Aortic Valve Repair and Ascending Aortic Graft Replacement Complicated by Exacerbation of Systolic Anterior Motion of the Mitral Valve Requiring Emergent Replacement and Myomectomy.  
MCC 345 (1131)
- Unexplained Persistent Hypotension in a Patient with Fragile X, Prader-Willi Phenotype  
MCC 346 (1143)
- Povidone-Iodine Disruption of Tracheobronchial Tree after Mediastinal Washing  
MCC 347 (1145)
- VA ECMO for VSD  
MCC 348 (929)
- Severe Hypoxia and Compartment Syndrome in a Patient with Sickle Cell Trait After Re-do Aortic Valve Replacement  
MCC 350 (1148)
- Compartment Syndrome as a Complication of Invasive Blood Pressure Monitoring in Patients Receiving Catheter Directed Thrombolysis  
MCC 351 (1157)

## Medically Challenging Cases, continued

- Is the Tracheostomy Working? – Medically Challenging Case Presentation  
MCC 352 (1163)
- Eastern Equine Encephalitis: A Dangerous Dark Horse in Organ Transplantation  
MCC 353 (1191)
- Case Report of Acute Central Nervous System Graft versus Host Disease in a Liver Transplant Patient  
MCC 354 (1197)
- Successful Management of Perioperative Massive Amniotic Fluid Embolism  
MCC 355 (1198)
- Management of a Patient with Impulse Control Disorder Admitted with Foreign Body Ingestion  
MCC 356 (662)
- Utilization of IVIg for Treatment of Heparin-Induced Thrombocytopenia in a Patient with Stanford Type B Aortic Dissection  
MCC 358 (1210)
- Metastatic Intracardiac Synovial Sarcoma: Case Report  
MCC 359 (1214)
- An Uncommon and Rare Complication: The Atrioesophageal Fistula  
MCC 360 (1216)
- New Left Ventricular Failure Following Double Lung Transplantation in a Patient with Severe Pulmonary Hypertension  
MCC 364 (1254)
- Pyoderma Gangrenosum Mimicking Necrotizing Fasciitis – A Potentially Fatal Misdiagnosis  
MCC 365 (1320)
- New Anterior Mediastinal Mass Discovered Day of Surgery: A Case Report  
MCC 366 (1361)
- Itching and Amniotic Fluid Embolism with Circulatory Collapse in a Full Term Pregnant Patient  
MCC 367 (1378)
- Hypertension associated with Dexmedetomidine: A rare but known response  
MCC 369 (1409)



---

## Medically Challenging Cases, continued

Propofol Infusion Syndrome in a Patient with Refractory Status Epilepticus: Report of a Medically-Challenging Case  
MCC 370 (1412)

Ethical Conflicts in Extracorporeal Membrane Oxygenation: A Case Report  
MCC 371 (1420)

Perioperative Management of a Patient with von Gierke Disease Undergoing Hepatic Surgery  
MCC 372 (1421)

Therapeutic Nasogastric Tube Placement for Management of Tamponade Physiology: A Case Report  
MCC 373 (1433)

Anesthetic Challenges Of Emergency Gynecological Surgery In A Jehovah's Witness With Fontan Circulation: A Case Report  
MCC 386 (1217)

Transesophageal Echocardiography In The Intraoperative Management Of Renal Cell Carcinoma With Inferior Vena Cava Thrombus: A Case Report  
MCC 387 (1220)

---

## Metabolism and Perioperative Care

Acute Adrenal Insufficiency After Anti-Emetic Dose of Dexamethasone  
MPC 248 (650)

The Effects of Major Hepatobiliary Surgery and General Anesthesia on Skeletal Muscle Mitochondrial Respiration. A Pilot Study  
MPC 249 (786)

---

## Neuroscience in Anesthesiology and Perioperative Medicine

Neonatal Disruption of PSD-95 PDZ Domain-mediated Protein-protein Interactions Alters Dendritic Spine Morphology, Long-term Potentiation, and Causes Deficits in Learning and Memory in Mice  
NR 375 (621)

---

## Neuroscience in Anesthesiology and Perioperative Medicine, continued

The Association between Angiotensin Converting Enzyme Inhibitors and Angiotensin Receptor Blocker Use and the Incidence of Delirium in Surgical ICU Patients  
NR 376 (771)

Sevoflurane interferes cell cycle through inhibition of Wnt/ $\beta$ -catenin signaling pathway in mouse neural stem cells  
NR 378 (840)

Perioperative Trajectory Of Alzheimer's Disease Biomarkers In Surgical Patients And Matched Non-surgical Controls  
NR 379 (1057)

Discriminative Capacity of EEG Power for the Onset and Severity of Delirium in the Postoperative Period  
NR 380 (1325)

Sugammadex Offers a New Option for Early Cessation of Neuromuscular Blockade to Facilitate Spinal Cord Evoked Potential Monitoring  
NR 382 (537)

Power Spectrum and Frontal Alpha Band Activity Saturation Predicts Loss of Response to Verbal Command in Older Adults During Anesthetic Induction with Propofol: A Diagnostic Test Approach  
NR 383 (953)

---

## Obesity

Paternal BMI Affects Neonatal Weight. Retrospective Study  
O 250 (835)

---

## Obstetric Anesthesiology

New Onset Acute Heart Failure in the Postpartum Period: A 90 Day National Readmissions Database Study  
OB 189 (1439)

Transcutaneous P6 Acupoint Electrical Stimulation Prevents Both Nausea and Vomiting During Elective Cesarean Section Under Combined Spinal-Epidural, a Randomized Control Clinical Trial  
OB 252 (753)

---

## Obstetric Anesthesiology, continued

Does the Application of Scopolamine Patch with Intra-operative Acupressure Point P6 Stimulation Increase Parturients' Intra-Cesarean Satisfaction? Prospective randomized clinical trial  
OB 253 (799)

---

## Pain Medicine

Inflammatory Stress Response to Cytoreductive Surgery and Heated Chemotherapy  
PM 390 (791)

Role of Pain Specialists in Reducing Healthcare Costs for Patients with Chronic Pain  
PM 391 (1235)

Comparison of Postoperative Analgesic Effect of Preemptive Use of Tramadol Versus Ketamine in Laparoscopic Surgery  
PM 392 (570)

---

## Patient Safety

Disruptive Intraoperative Behavior: Reporting to Management and Satisfaction with Management's Response  
PS 265 (958)

Implementing a Standardized Sign-out Process in Cardiovascular ICU  
PS 266 (960)

Supraclavicular Brachial Plexus Block Analgesia With Or Without Perineural Dexamethasone For Creation Of Arteriovenous Fistula In End Stage Renal Disease Patients  
PS 267 (1284)

---

## Pediatric Anesthesiology

Perioperative Outcomes and Management in LeFort III Midface Advancement Surgery: A Multicenter Study from the Pediatric Craniofacial Collaborative Group  
PED 257 (548)

Comparison of Endotracheal Intubation vs. Natural Airway During Endoscopic Foreign Body Removal  
PED 259 (845)



# Abstract Category Index

---

## Pediatric Anesthesiology, continued

Comparison of Endotracheal Intubation vs. Natural Airway During Initial Percutaneous Endoscopic Gastrostomy Insertion  
PED 260 (847)

---

## Perioperative Anesthesia

CHA2DS2-VASc Score for Risk Prediction of Venous Thromboembolic Events After Total Joint Arthroplasty  
PA 162 (990)

Association of Age and Gender with Postoperative Respiratory Failure  
PA 384 (530)

Association of Preoperative Anticholinergic Medication Exposure with Postoperative Healthcare Resource Use and Outcomes: a Population-Based Cohort Study  
PA 385 (555)

The iShuddle: A Strategy to Decreases Turn-Over-Time by Improving Culture in the Operating Room  
PA 388 (740)

A Systematic Review and Meta-Analysis Examining the Impact of Sleep Disturbance on Post-Operative Delirium  
PA 394 (1169)

Echocardiographic Assessment Using Subxiphoid-only View (EASy) Compared to Focused Transthoracic Echocardiography (FoTE): A Multicenter Prospective Study  
PA 395 (1160)

Addition of Focused Transthoracic Echocardiography (FoTE) Learning into Existing Anesthesiology Residency Training Programs: A Prospective Multicenter Study of Blended Learning  
PA 396 (1229)

Echocardiographic Assessment using Subxiphoid-only view (EASy) compared to Focused Transthoracic Echocardiography (FoTE) in the perioperative period: A multicenter prospective study  
PA 397 (1408)

Effect of Dexamethasone on Postoperative Pain Scores in a Resource-Limited Setting: A Randomized Double Blind Placebo Controlled Clinical Trial  
PA 398 (869)

---

## Perioperative Anesthesia, continued

A Nationwide Study of Dental Injuries in Relation to General Anesthesia  
PA 399 (1015)

Impact of ICU Admission on the Perioperative Trajectory of Elderly Surgical Patients  
PA 402 (1370)

Post-Operative Sepsis: What is the Current Picture?  
PA 403 (1371)

General Anesthesia Alters Gut Microbiota Diversity and Composition in Mice  
PA 404 (1417)

Stroke Volume Assessment by Invasive Arterial Blood Pressure Tracing, SpO2 and Bioreactance. A Comparative Study  
PA 405 (1444)

---

## Regional Anesthesia

Report of Acute Delirium in a Healthy Patient with Rectus Sheath Catheters  
RA 168 (807)

Early Experience with 2-Chloroprocaine for Spinal Anesthesia: A Retrospective Analysis at One Institution  
RA 169 (907)

---

## Respiration

Current Oxygen Management in the Operating Room: A Retrospective Chart Review  
RES 224 (686)

---

## Technology, Computing and Simulation, Equipment Monitoring

The Simulation Wars: A Competition to Increase Participation in Emergency Manuals Simulation Training and a Novel Tool for Rating Simulation Competitions  
TCSEM 229 (697)

Virtual Reality Use in Adult ICU to Mitigate Anxiety for a Patient on V-V ECMO: A Feasibility Trial  
TCSEM 230 (1126)

---

## Technology, Computing and Simulation, Equipment Monitoring, continued

Inter-professional Simulation based education in Critical Care Medicine  
TCSEM 231 (1331)

Feasibility of Using a Remote Monitoring Technology to Build a Consultative Critical Care Service for High Risk Non-ICU Surgical Patients  
TCSEM 233 (528)

Comparisons of the Endobronchial Segment of Left-Sided Double-Lumen Tubes  
TCSEM 234 (713)

Efficacy of Bispectral Index in Reducing Intraoperative Awareness: A Meta-Analysis of Randomized Controlled Studies  
TCSEM 235 (743)

Perioperative Central Volume Status in Healthy Children and in Children with Congenital Heart Disease  
TCSEM 237 (1181)

Joint modeling and the Compensatory Reserve Index: Insight into hemodynamic compensation during the induction of general anesthesia  
TCSEM 238 (1365)

---

## Trauma

Severe Hemorrhagic Shock is Associated with Reduced TEG Maximum Amplitude in Human Traumatic Injury  
T 242 (590)

Cervical Spine Clearance in Patients with Unreliable Clinical Exam: Delays and Complications  
T 243 (937)

Supplemental Oxygen for Trauma Patients – Current Practice in two Trauma Centers  
T 244 (944)

# SOCCA 2018 Annual Meeting Abstract Reviewers



The Society of Critical Care Anesthesiologists (SOCCA) Board of Directors and the 2018 Annual Meeting Program Committee acknowledge with thanks the following 2018 Annual Meeting Abstract Reviewers:

**Ozan Akca, MD**, University of Louisville School of Medicine, Louisville, Kentucky

**David W. Barbara, MD**, Mayo Clinic, Rochester, Minnesota

**Karsten Bartels, MD**, University of Colorado Denver School of Medicine, Aurora, Colorado

**Talia K. Ben-Jacob, MD**, Cooper Medical School of Rowan University, Cooper University Hospital, Camden, New Jersey

**Suzanne Bennett, MD**, University of Cincinnati Medical Center, Cincinnati, Ohio

**Alisha Bhatia, MD**, Rush University Medical Center, Chicago, Illinois

**Manuel Castresana, MD**, Augusta University, Augusta, Georgia

**Pinxia Chen, MD**, St. Luke's University Hospital and Health Network, Bethlehem, Pennsylvania

**Miguel Cobas, MD, FCCM**, University of Miami; Jackson South Community Hospital, Miami, Florida

**Francis DiPierro, MD**, Cleveland Clinic, Cleveland, Ohio

**Brenda Fahy, MD, MCCM**, University of Florida College of Medicine, Gainesville, Florida

**Edward D. Foley, MD**, Medical College of Georgia, Augusta, Georgia

**Thomas Fuhrman, MD**, Bay Pines Veterans Affairs Healthcare System, Bay Pines, Florida

**Bhargavi Gali, MD**, Mayo Clinic Rochester, Rochester, Minnesota

**Haley Goucher Miranda, MD**, University of Kansas Medical Center, Kansas City, Kansas

**Navneet Grewal, MD**, University of Texas, Houston, Texas

**Alok Gupta, MD**, Northwestern University Feinberg School of Medicine, Chicago, Illinois

**Jacob Gutsche, MD**, Perelman School of Medicine, University of Pennsylvania, Philadelphia, Pennsylvania

**Erin Hennessey, MD**, Stanford University Medical Center, Stanford, California

**Christopher G. Hughes, MD**, Vanderbilt University Medical Center, Nashville, Tennessee

**Jose Humanez, MD**, University of Alabama at Birmingham, Birmingham, Alabama

**Sean Josephs, MD**, College of Medicine University of Cincinnati, Cincinnati, Ohio

**Kunal Karamchandani, MD, FCCP**, Penn State Milton S. Hershey Medical Center, Hershey, Pennsylvania

**John Klick, MD, FCCP, FASE, FCCM**, Penn State Milton S. Hershey Medical Center, Hershey, Pennsylvania

**Daryl J. Kor, MD**, Mayo Clinic Rochester, Rochester, Minnesota

**Vikas Kumar, MBBS**, Augusta University, Augusta, Georgia

**Rainer Lenhardt, MD**, University of Louisville School of Medicine, Louisville, Kentucky

**Piyush Mathur, MD**, Cleveland Clinic, Cleveland, Ohio

**Joti J. Mucci, MD**, University Hospitals Cleveland Medical Center, Cleveland, Ohio

**Jayanta Mukherji, MD**, Loyola University Medical Center, Maywood, Illinois

**William Mulvoy, MD, MBA**, The Texas Heart Institute, Houston, Texas

**Michael O'Connor, MD**, The University of Chicago Medicine, Chicago, Illinois

**Ronald Pauldine, MD**, University of Washington Medicine, Seattle, Washington

**Pamela R. Roberts, MD**, University of Oklahoma College of Medicine, Oklahoma City, Oklahoma

**Aryeh Shander, MD, FCCM, FCCP, FASA**, Englewood Hospital and Medical Center, Englewood, New Jersey

**Harish Siddaiah, MD**, LSU Health Sciences Center, New Orleans, Louisiana

**Julia B. Sobol, MD**, Columbia University Medical Center; New York-Presbyterian Hospital, New York, New York

**Roshni Sreedharan, MD**, Cleveland Clinic Foundation, Cleveland, Ohio

**Breandan Sullivan, MD**, University of Colorado Denver School of Medicine, Aurora, Colorado

**Madiha Syed, MD**, Cleveland Clinic Foundation, Cleveland, Ohio

**Ashley Szabo, MD**, Cleveland Clinic, Cleveland, Ohio

**Beth Teegarden, MD**, The University of Texas Medical Branch at Galveston, Galveston, Texas

**Michael Urban, MD**, Hospital for Special Surgery, New York, New York

**Manuel C. Vallejo, MD, DMD**, West Virginia University, Morgantown, West Virginia

**Peter Von Homeyer, MD, FASE**, University of Washington Medicine, Seattle, Washington

**Samrat Worah, MD**, SUNY Downstate Medical Center, Brooklyn, New York

# SAVE THE DATE! FRIDAY, MAY 17, 2019!

## SOCCA 2019 Annual Meeting and Critical Care Update



**Fairmont The Queen Elizabeth Hotel  
Montréal, Quebec, Canada**

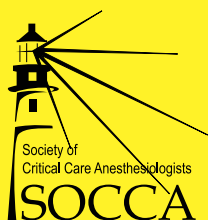

**For more information,  
visit [www.socca.org](http://www.socca.org)**